

CERTIFIED LAND CORNER RESTORATION

Index No. **G-19**

State of Wisconsin

County of Oneida } ss.

I Philip T. Hansen, do hereby certify that on the 9th day of January, 1975, I found evidence of the C-1/4 corner of Section 11 Township 36, North, Range 11 East, Fourth Principal Meridian, as described hereon; and that from this evidence I established a new monument and accessories as described hereon to perpetuate the original location of this corner.

Resident witnesses:

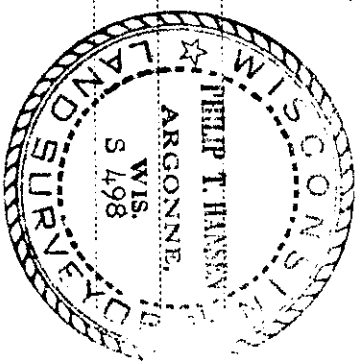

T36N, R11E

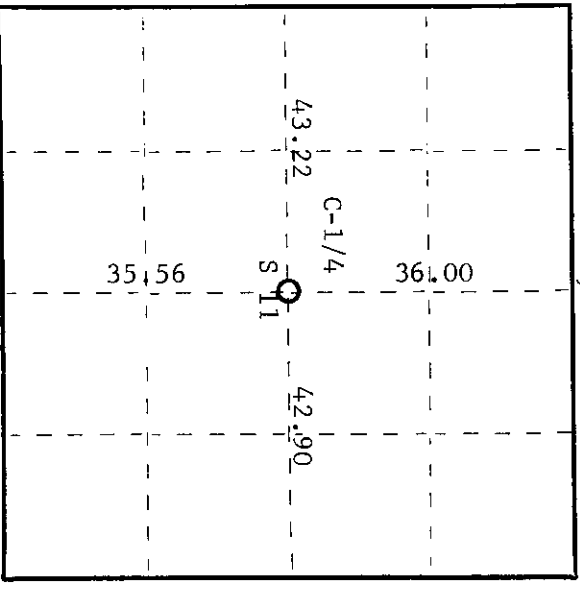

○ = Corner monument restored.

History of original corner establishment:

No history of establishment of corner prior to retracement survey by H.C. Lawrence, Reg. Land Surveyor, in 1957. His notes state that he ran the N-S 1/4 line from the 1/4 Corner between Sec. 11-14 N3°30'W (mag.) 71.56 chains to intersect North line 50 lks. East of 1/4 Corner. True bearing of corrected line N3054'W. He ran the E-W 1/4 line West from the 1/4 Corner between Sections 11 & 12, set by B.F. Dorr in 1897, 889'00" W (mag.) 89.17 chains to intersect random sec. line between Sec. 10 & 11 at a point 4.70 chains South of 1/4 Corner. True bearing of corrected line N8800'W. Corrected length of line 86.12 chains. Set C-1/4 at intersection of NS-EW corrected 1/4 lines 42.90 ch. West of 1/4 Corner 43.22 East of W-1/4 Corner 35.56 North of S-1/4 Corner and 36.00 chains South of N-1/4 Corner. Squared and scribed a 7" black spruce for corner. No BT's.

Description of corner evidence found:

Recovered a 7" black spruce, squared and scribed C-1/4 S11, S11 C-1/4. Scribing grown almost completely over but visible. No bearing trees recovered.

Description of monument and accessories I established to perpetuate the original location of this corner.

- Set a 2-1/2" x 5' galvanized iron pipe with brass cap stamped - S498
- Set 2 lks. from center of squared black spruce S65°W. T36N, R11E
- New BT. Black spruce 6" N11°W 38-1/2 lks. Scribed C-1/4 S11 C-1/4 S11
- CPI-1975

Dated at Mineland, Wis., this 16th day of June, 1975

Signature Philip T. Hansen Title Registered Land Surveyor Registration No. S-498  
 (County Surveyor, Registered Land Surveyor, or other duly authorized official)

Office of Register of Deeds, County of Oneida I hereby certify that the within instrument was filed in this office for record on the 1st day of October, 1975 at 3:00 o'clock M.

Donna Verage Truck  
 (Register of Deeds)

By \_\_\_\_\_ Deputy

361112020