

CERTIFIED LAND CORNER RESTORATION

Index No. **F-19**

State of Wisconsin }
County of Oneida } ss.

I, Philip T. Hansen, do hereby certify that on the 9th day of January, 1975, I found evidence of the NC-1/16 corner of Section 11 Township 36 North, Range 11 East, Fourth Principal Meridian, as described hereon; and that from this evidence I established a new monument and accessories as described hereon to perpetuate the original location of this corner.

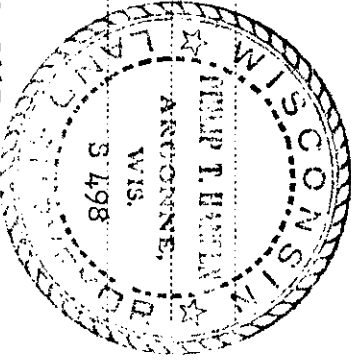

Resident witnesses:

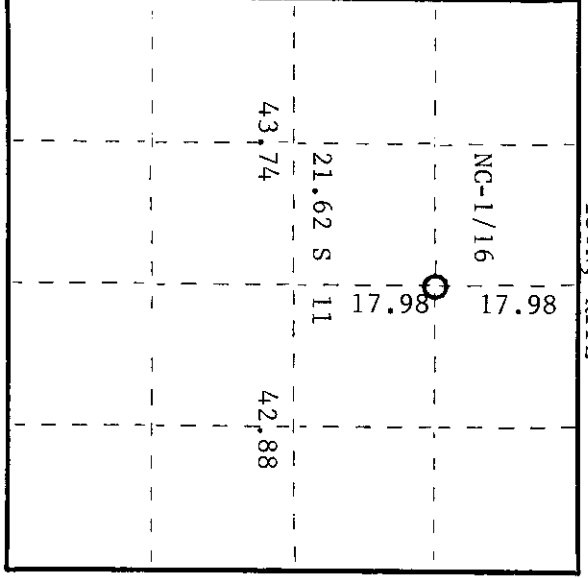

O = Corner monument restored.

History of original corner establishment:

Original corner established by B.F. Dorr, County Surveyor in 1897. Retracement survey made by H.C. Lawrence, Reg. Land Surveyor, in 1957. Unable to recover corner or BT's, he ran a random line from the 1/4 Corner between Sections 11 and 14, N3°30'W 71.56 chains to intersect a point 50 lks. East of 1/4 Corner between Sections 11 and 14, N3°54' West. Also ran the E-W 1/4 line from Dorr's 1/4 Corner between Sections 11 and 12, S89°00'W, 89.17 chains to intersect random line between S10 and S11 at 4.70 chains South of 1/4 true bearing of line N88°W. Set NC-1/16 corner at 17.98 chains North of C-1/4 corner and 37 lks. West of random. Made NBT's. Tamarack 3" S60E 9-1/2 lks.; Spruce 6" N80E 37-1/2 lks.

Description of corner evidence found:
Recovered 3" tamarack post, squared but scribing not visible, lying down covered with sphagnum moss, in fair condition.

Old bearing trees recovered.

Black spruce 6" N80°E 37-1/2 lks., lying down and rotten, scribing visible.
Tamarack 3" S60°E 9-1/2 lks., scribed BT, dead but sound.

Description of monument and accessories I established to perpetuate the original location of this corner.

Replaced post with 1" x 5' galvanized iron pipe with brass cap stamped - S498
New BT's. Black spruce 7" N36°E 16 lks. Scribed 1/16 BT T36N, R11E
Black spruce 8" S21°W 20-2/3 lks. Scribed 1/16 BT NC-1/16 S11
CPI-1975

Dated at Rhineland, Wis., this 16th day of June, 1975.

Signature: *Philip T. Hansen* Title: Registered Land Surveyor Registration No. S-498
(County Surveyor, Registered Land Surveyor, or other duly authorized official)

Office of Register of Deeds, County of Oneida. I hereby certify that the within instrument was filed in this office for record on the 1st day of October, 1975, at 3:00 o'clock P.M.

Doris Virginia Tuel
(Register of Deeds)

By: _____ Deputy

0702112020