

CERTIFIED LAND CORNER RESTORATION

Index No. L-21

State of Wisconsin }  
 County of Oneida } ss.

I Phillip T. Hansen, do hereby certify that on the 4th day of December, 1974, I found evidence of the 1/4 corner of 13-14 Township 36 North, Range 11 East, Fourth Principal Meridian, as described hereon; and that from this evidence I established a new monument and accessories as described hereon to perpetuate the original location of this corner.

Resident witnesses:

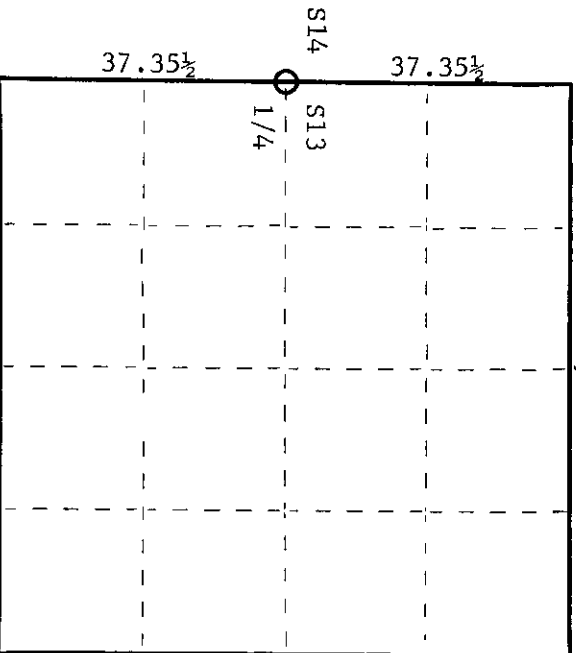
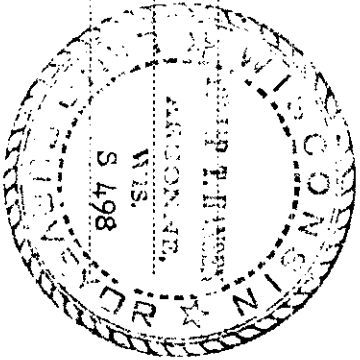

○ = Corner monument restored.

History of original corner establishment:  
 Original survey established by Wm. E. Dougherty, Deputy Surveyor General in 1859.

B.F. Dorr, County Surveyor resurvey, 1899.  
 Tamarack 9" S36E 8 lks.  
 Fir 6" S50W 5 lks.

Retracement survey by H.C. Lawrence, 1956, states that he ran the line between Sections 13 and 14 and, although he set the 1/4 corner, he did not mention or describe the corners. Lawrence's measurements for N 1/2 and S 1/2 from the 1/4 corner to the Section Corner do not correspond to Dorr's. H.C. Lawrence set new post equidistant between Section Corners at 37.35 1/2 lks. and made new BT S-VI2. Cedar 14", S25E, 45 lks. Cedar 16", S10W, 39 lks.  
 Description of corner evidence found:

Recovered H.C. Lawrence's 4" cedar post, squared and scribed 1/4 S13; 1/4 S14 in fair condition.  
 Recovered cedar stump 14", S14 0W, 39 lks.

Description of monument and accessories I established to perpetuate the original location of this corner.

Set 2-1/2" x 5' galvanized iron pipe with brass cap stamped as follows -  
 New BT Black spruce 7" N68E 55-1/4 lks. scribed 1/4 BT T36N, R11E S498

S14 | S13  
 1/4 |

CPI-1974

Dated at Rhinelander, Wis., this 16th day of June, 1975.

Signature: *Phillip T. Hansen* Title: Registered Land Surveyor Registration No. S-498  
 (County Surveyor, Registered Land Surveyor, or other duly authorized official)

Office of Register of Deeds, County of Oneida  
 Instrument was filed in this office for record on the 1st day of October, 1975 at 3:00 o'clock P.M.

*Tomie George Kunkin*  
 (Register of Deeds)

By \_\_\_\_\_ Deputy

361142000