

CERTIFIED LAND CORNER RESTORATION

Index No. **N-11**

State of Wisconsin

County of Oneida } ss.

I, Philip T. Hansen, do hereby certify that on the 27th day of March, 1975, I found evidence of the Quarter corner of Sections 16 & 21 Township 36, North, Range 11 East, Fourth Principal Meridian, as described hereon; and that from this evidence I established a new monument and accessories as described hereon to perpetuate the original location of this corner.

Resident witnesses:

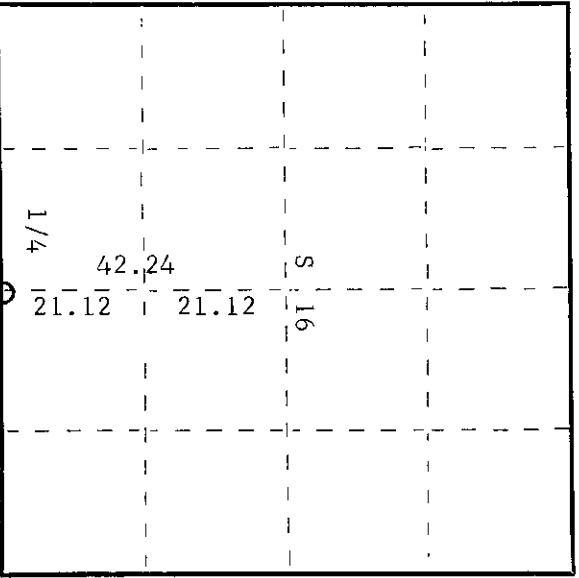
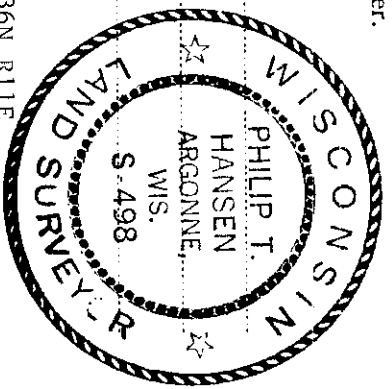

○ = Corner monument restored.

History of original corner establishment:

Original corner established by Wm. E. Dougherty, Gov. Deputy Surveyor, in 1859. Cedar 8" N20°W 40 links; birch 10" S50°E 10 links. Corner re-established by B.F. Dorr, County Surveyor. No record of BT's. Corner re-established by H.C. Lawrence, Registered Land Surveyor, in 1948. At that time he ran S6°30'E mag. from Dorr's C/4 post. At 21.12 he recovered Dorr's SC-1/16 corner, and at 42.24 chains intersected the C/L old road. At 42.33 chains an old post was recovered 33 links west at right angles. Corrected bearing of line S6°03'E. New post was set 9 links south of its true position. No BT's were established.

Description of corner evidence found:

Unable to recover corner stake as no BT's were available. Recovered C/4 corner, ran south on old random line 21.12 chains, continued south on old random line 21.12 chains to C/L old E-W road, from which 1/4 was set 33 links west of right angle. No trace was found of old corner at restored corner.

Description of monument and accessories I established to perpetuate the original location of this corner.

Set 1 1/2" O.D. iron pipe for 1/4 corner in C/L of old road, flush with the ground. A witness corner was set 35 links north of true corner. This is a 2 1/2" x 5' galvanized iron pipe with brass cap stamped -

NBT's - to true corner.
 White birch 8" S4°W 37.7 links scribed 1/4 BT.
 White birch 6" S88°W 56 links scribed 1/4 BT.

T36N R11E
 S 16
 1/4
 S 21
 W.C. 55 links
 GPI-1975

Dated at Rhineland, Wis., this 19th day of August, 1975.

Signature: Philip T. Hansen Title: Registered Land Surveyor Registration No. S-498
 County Surveyor, Registered Land Surveyor, or other duly authorized official

Office of Register of Deeds, County of Oneida
 Instrument was filed in this office for record on the 1st day of October, 1975
 at 3:00 o'clock P. M.

Doris Savage Fisher
 (Register of Deeds)

By: _____ Deputy

3611160020