

State of Wisconsin

County of Oneida } ss.

I Phillip T. Hansen do hereby certify that on the 6th day of December, 1976, I found evidence of the N 1/16 corner of Section 19 & 20

Township 36, North, Range 11, Fourth Principal Meridian,

as described hereon; and that from this evidence I established a new monument and accessories as described hereon to perpetuate the original location of this corner.

Resident witnesses:

Glen Barker

Jim Clarkin

Herb Wagoner

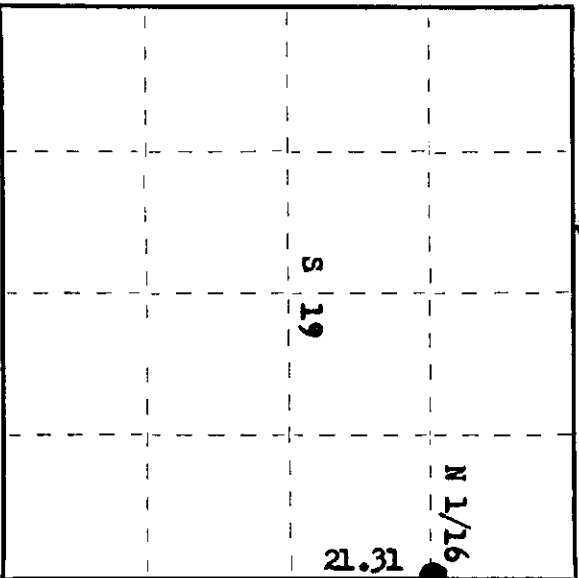
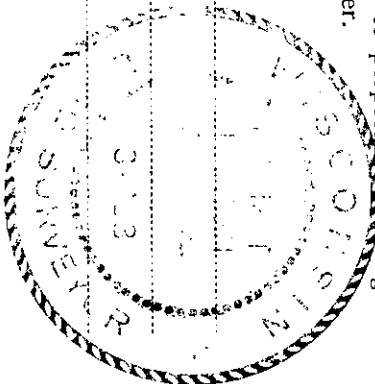

○ = Corner monument restored.

History of original corner establishment:

Corner recovered by H.C. Lawrence, Registered Land Surveyor, in 1947, when he ran the line between Sec. 19 & 20. Found an old post on the west side of the highway and an old blazed line running west from it. Corner recovered by RIPCOS surveyors who accepted the corner and set their iron pipe with brass cap.

Description of corner evidence found:

Recovered Ripco's 1" iron pipe with brass cap stamped: Projects 12" above ground. Recovered Lawrence's 4" squared and scribed cedar post, scribed N 1/16 S19, N 1/16 S20, also an old 3" squared cedar post projecting 1 ft. above ground. Recovered OBT - Maple 6" S 76° W 11.4 links, scribed N 1/16 visible.

N 1/16
S19/S20
RIPCO

Description of monument and accessories I established to perpetuate the original location of this corner.

As Ripco's iron pipe was in good condition, the old 3" post was removed and Ripco's pipe set in its place. Monument now projects 18" above ground. NBT - Cedar 10" N S1° W 45 links, scribed 1/16 BT. Corner sets 17 links west of an old N-S Sec. line road, now grown up with alders.

Dated at Rhineland, Wis., this 15th day of December, 1976

Signature Phillip T. Hansen Title Registered Land Surveyor Registration No. S-498
(County Surveyor, Registered Land Surveyor, or other duly authorized official)

Office of Register of Deeds, County of Oneida I hereby certify that the within instrument was filed in this office for record on the 7th day of February, 1977 at 1:45 o'clock P.M.

Karen Savage Tischer
(Register of Deeds)

By Joseph M. Bremer Deputy

00049309