

CERTIFIED LAND CORNER RESTORATION

Index No. **R-14**

State of Wisconsin

County of Oneida } ss.

I Philip T. Hansen, do hereby certify that on the 17th day of March, 1976, I found evidence of the W 1/16 corner of Section 22 - 27 Township 36 North, Range 11 East, Fourth Principal Meridian,

as described hereon; and that from this evidence I established a new monument and accessories as described hereon to perpetuate the original location of this corner.

Resident witnesses:

- Glen Barker
- Jim Clarlin
- Herb Wagoner

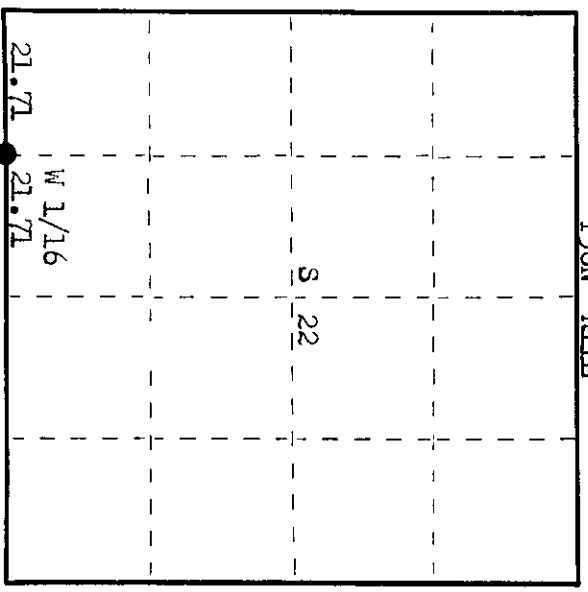
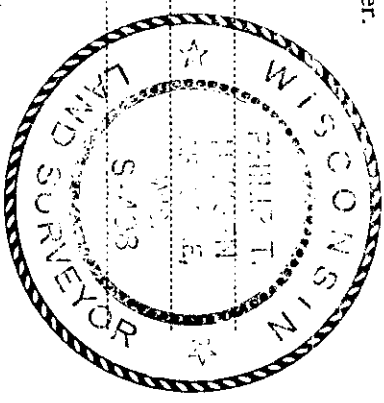

○ = Corner monument restored.

History of original corner establishment:

Corner established by H. C. Lawrence, Registered Land Surveyor, in 1948. From his notes he states that Vaughan's notes of 11/28/1901 and Dorr's notes of 1906, the line was run by Monsell sometime prior, corners of which were set by DPH and used by Vaughan and Dorr. Lawrence ran a random line west from recovered 1/4 Corner, 43.42 chains to point 13 lks south of section corner. Set W 1/16 corner at 21.71 chains equidistant and 6 1/2 lks north of random. Marked NBTs, cedar 18" N 12° E 10 lks and cedar 7" S 63° E 4 1/2 lks.

Description of corner evidence found:

Recovered 4" cedar post, squared and scribed W 1/16 S22, W 1/16 S27 in poor condition. Recovered OBT. Cedar 18" N 12° E 10 lks, now uprooted and blown over. Cedar 7" (8") S63° E 4 1/2 lks. Scribed W 1/16 BT.

Description of monument and accessories I established to perpetuate the original location of this corner.

Replaced 4" Cedar Post with 1" OD iron pipe with 2" brass cap stamped. Pipe projects 1 ft. above ground. NBT Cedar 7" S 64° W 28.3 lks, scribed 1/16 BT. Pipe and BTs painted blue.

S498  
T36N R11E  
S 1/22  
S 1/27  
1975  
W 1/16

Dated at Rhineland, Wis., this 22nd day of March, 1976.

Signature Philip T. Hansen Title Registered Land Surveyor Registration No. S-498  
(County Surveyor, Registered Land Surveyor, or other duly authorized official)

Office of Register of Deeds, County of Oneida. I hereby certify that the within instrument was filed in this office for record on the 5th day of April, 1976 at 3:00 o'clock P.M.

Doris Terrace Kuehn  
(Register of Deeds)

By \_\_\_\_\_ Deputy

0  
M  
0  
0  
0  
0  
0  
0  
0  
0  
0

CERTIFIED LAND CORNER RESTORATION

Index No. R-14

State of Wisconsin

County of Oneida } ss.

I, Phillip T. Hansen, do hereby certify that on the 17th day of March, 1976, I found evidence of the W 1/16 corner of Sections 22 and 27 Township 36, North, Range 11 East, Fourth Principal Meridian, as described hereon; and that from this evidence I established a new monument and accessories as described hereon to perpetuate the original location of this corner.

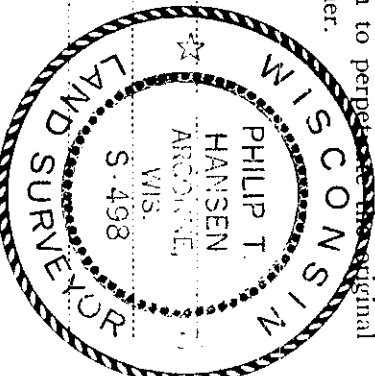

Resident witnesses:  
Glen Parker  
Jim Claflin  
Herb Wagoner

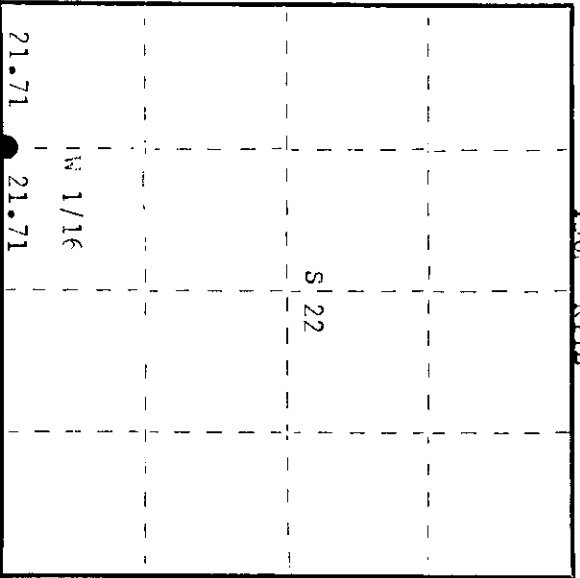

○ = Corner monument restored.

History of original corner establishment:

Corner established by H.C. Lawrence, Registered Land Surveyor, in 1948. Ran random line west from recovered (Honsell's 1/4 corner) to Honsell's & Vaughan's SW section corner, a distance of 43.42 chains. Corrected bearing N 83° 50' W. Set W 1/16 at 21.71 chains intermediate.  
Marked NBT's - Cedar 7" S63°E 4-1/2 links  
Cedar 1 1/2" N12°E 10 links

Description of corner evidence found:

Recovered 4" cedar post, squared and scribed W 1/16 S22, W 1/16 S22 in poor condition.  
Recovered GBT's -  
Cedar 1 1/2" N12°E 10 links, now unrooted and blown down.  
Cedar 7" (8") S63°E 4.5 links (4.3 links) scribed W 1/16 BT.

Description of monument and accessories I established to perpetuate the original location of this corner.

Replaced cedar post with 1-1/2" iron pipe with 2" brass cap, stamped:  
Monument projects 1' above ground.  
Marked NBT - Cedar 7" S64°E 28.3 feet, scribed W 1/16 BT.  
Drove support stakes beside monument.

S498  
S-22  
S-27  
W 1/16  
CFI-1976

Dated at Rhinelander, Wis., this 3rd day of December, 1979

Signature Phillip T. Hansen Title Registered Land Surveyor Registration No. S-498  
(County Surveyor, Registered Land Surveyor, or other duly authorized official)

Office of Register of Deeds, County of Oneida  
Instrument was filed in this office for record on the 17th day of December, 1979  
at 1:30 o'clock P.M.

By Doris George Kuehn (Register of Deeds)

By \_\_\_\_\_ Deputy

0300022030