

CERTIFIED LAND CORNER RESTORATION

Index No. **P-14**

State of Wisconsin

County of Oneida } ss.

I Phillip T. Hansen, do hereby certify that on the 15th day of January, 19 76, I found evidence of the WC 1/16 corner of Section 22 Township 36, North, Range 11 East, Fourth Principal Meridian,

as described hereon; and that from this evidence I established a new monument and accessories as described hereon to perpetuate the original location of this corner.

Resident witnesses:

Jim Clafflin

Tom Jewell

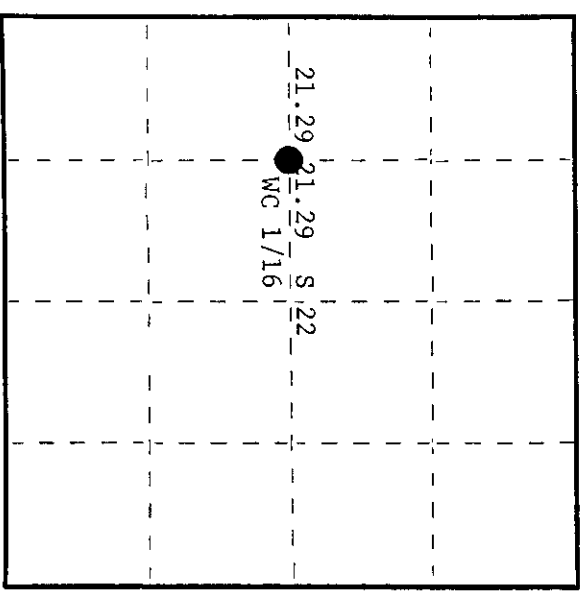
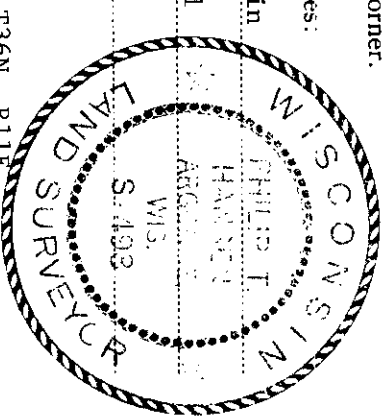

○ = Corner monument restored.

History of original corner establishment: Corner established by H.C. Lawrence, Registered Land Surveyor, in 1948. He ran the E-W 1/4 line West from recovered C 1/4 corner a distance of 42.58 chains to a point 227 lks. north of recovered 1/4 corner. He set a 3" cedar post 113-1/2 lks. south of the intermediate point at 21.29 chs. west of the C 1/4 corner. Marked spruce 3", N38°E, 9-1/2 lks. for NBT.

Description of corner evidence found: Recovered a 3" cedar post, squared and scribed, WC 1/16 S22, WC 1/16 S22 in fair condition.

Recovered OBT - B. spruce 3" (8") N38°E 9.5 lks. scribing grown over.

Description of monument and accessories I established to perpetuate the original location of this corner.

Replaced 3" cedar post with 1"OD iron pipe with 2" brass cap stamped - S498 T36N R11E

Pipe projects 24" above ground. S 22

Old cedar post set up beside new iron pipe. WC 1/16 CPI-1976

NBT - Black spruce 5" S21°E 75.8 lks. scribed 1/16 BT

Pipe, post, and BT's painted blue.

Dated at Rhinelander, Wis., this 20th day of January, 19 76.

Signature Phillip T. Hansen Title Registered Land Surveyor Registration No. S-498
(County Surveyor, Registered Land Surveyor, or other duly authorized official)

Office of Register of Deeds, County of Oneida 9th day of November, 19 76
I hereby certify that the within instrument was filed in this office for record on the 9th day of November, 19 76
at 1:30 o'clock P. M.

Verne George Fuchs
(Register of Deeds)

By Verne George Fuchs Deputy

361122 2020