

CERTIFIED LAND CORNER RESTORATION

Index No. 0-18

State of Wisconsin }
County of Oneida } ss.

I Phillip F. Hansen, do hereby
certify that on the 5th day
of October, 1976, I found
evidence of the NW 1/16
corner of Section 23
Township 36, North, Range
11 East, Fourth Principal Meridian,

as described hereon; and that from this evidence
I established a new monument and accessories
as described hereon to perpetuate the original
location of this corner.

Resident witnesses:

Glen Barker

Jim Craftin

Herb Wagoner

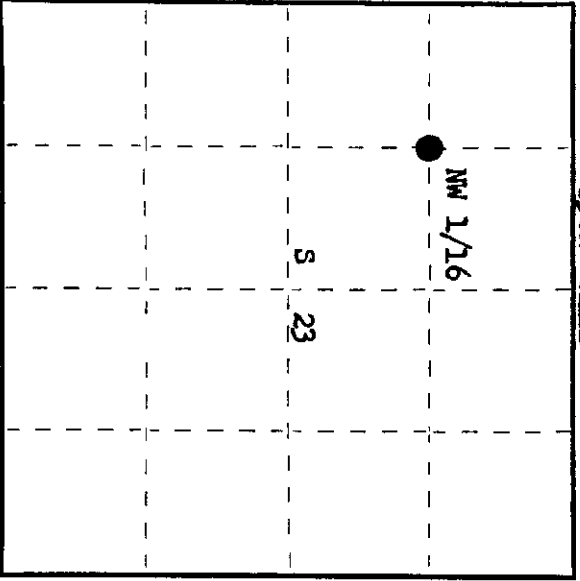
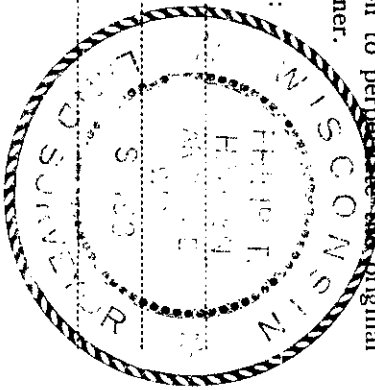

○ = Corner monument restored.

History of original corner establishment:

Corner established by B.F. Dorr, County Surveyor, in 1906. Set post and marked
tamarrack BT 1/4" N 78° E 28 links.
Corner recovered by H.C. Lawrence, Registered Land Surveyor. Set new post and marked
NBTs - Cedar 1 1/4" N 7° W 7 1/2 links
Cedar 10" S 46 1/2° E 31 links

Description of corner evidence found:

Recovered 4" cedar post, squared and scribed S23 NW 1/16 S23 NW 1/16 in fair condition.
Also recovered the top part of an old cedar post laying beside it.
Recovered OBT - Cedar 1 1/4" N 7° W 7.5 links, scribed NW 1/16 NBT.
Cedar 10" (12") S 46 1/2° E 31 links, scribed S23 NBT.

Description of monument and accessories I established to perpetuate the original location of this corner.

Replaced 4" cedar post with 1 1/2" OD iron pipe with brass cap, stamped:
Monument projects 18" above ground.
No additional accessories established.

S498
T36N R11E
NW 1/16 S 23
CPI-1976

Dated at Rhinelander, Wis., this 6th day of December, 1976

Signature: Phillip F. Hansen Title: Registered Land Surveyor Registration No. S-498
(County Surveyor, Registered Land Surveyor, or other duly authorized official)

Office of Register of Deeds, County of Oneida
Instrument was filed in this office for record on the 20th day of December, 1976
at 1:00 o'clock P. M.

Lena Lange Keck
(Register of Deeds)

By: _____ Deputy