

CERTIFIED LAND CORNER RESTORATION

Index No. **7-25**

State of Wisconsin } ss.
County of Oneida

I Phillip T. Hansen, do hereby certify that on the 9th day of June, 1977, I found evidence of the Quarter corner of Sec. 25 & 30

Township 36, North, Range 11 East, Fourth Principal Meridian, as described hereon; and that from this evidence I established a new monument and accessories as described hereon to perpetuate the original location of this corner.

Resident witnesses:

Glen Barker

Jim Clafin

Herb Wagoner

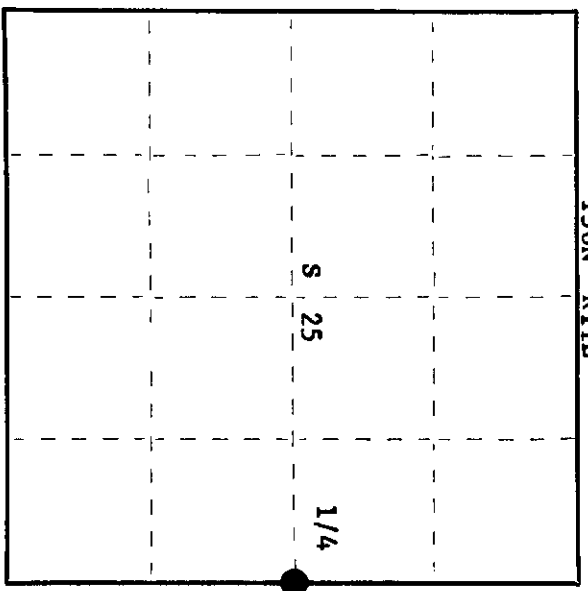
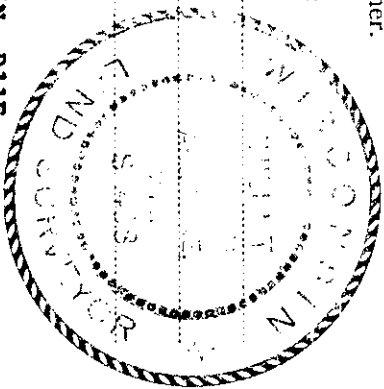

○ = Corner monument restored.

History of original corner establishment:

Original Corner established by Alfred Millard in 1858 from which White Pine 10" bears N20°E, 15 links and Aspen 12" bears S80°W, 16 links.
B.F. Dorr recovered corner in 1899. Recovered original BT's.
Corner recovered by H.C. Lawrence, Registered Land Surveyor, in 1954. Ran E-W 1/4 line. Distance to C 1/4 corner 45.10 chains.
Corner's witness monuments (BT's) destroyed by road construction.

Description of corner evidence found:

No evidence of corner recovered. Corner sets in old highway 8. Set corner by single proportion. Ran traverse from recovered C 1/4 corner to EC 1/16 corner. Doubled distance and set E 1/4 corner in straight line. Computed distance from EC 1/16 to E 1/4 Corner Sec. 25-36-11 at 22.5445 chains. Bearing of line S 86° 38'03" E.

Description of monument and accessories I established to perpetuate the original location of this corner.

Set 1 1/2" x 18" iron pipe in centerline of old highway 8, 5" below surface.
Set 2 1/2" Bernitsen A-1 Federal Monument, 60 links north of true corner for witness corner, projecting 12" above ground. Cap stamped:
Marked NBT's - Red Pine 10" N55°W, 170.5 links, scribed 1/4 BT.
Red Pine 10" N22°W, 144.6 links, scribed 1/4 BT.

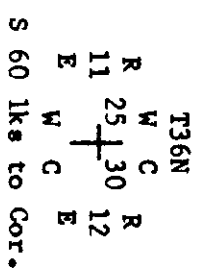

Dated at Rhinelander, Wis., this 13th day of June, 1977

Signature Phillip T. Hansen Title Registered Land Surveyor Registration No. S-498
(County Surveyor, Registered Land Surveyor, or other duly authorized official)

Office of Registrar of Deeds, County of Oneida
Instrument was filed in this office for record on the 6th day of February, 1978
at 9:30 o'clock A. M.

Dora Wenger Kuehn
(Registrar of Deeds)

By _____ Deputy

0000752000 26

U.S. PUBLIC LAND SURVEY MONUMENT RECORD

NOTE: This form is intended and designed to fulfill all requirements of Wisconsin Administrative Code, Chapter A-E 7 .08 U.S. Public Land Survey Monument Record (3)(a)(b)(c)(d)(e)(f)(g)(h)(i). An additional sheet may be added if necessary to conform with said requirements.

(a) Corner location: Township 36 North

Range 11 East

Town of MONICO

County of ONEIDA

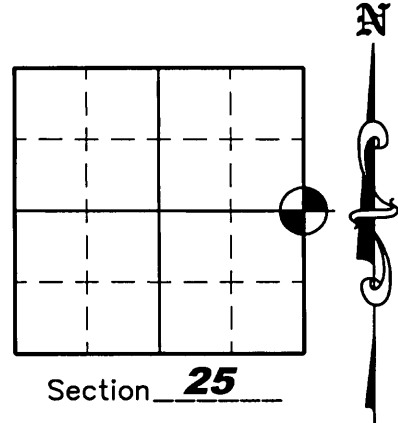

(b)(f)(g)(h) Description of monument found at this corner and if it was accepted, state all evidence (material, testimonial, occupation, plats, records, other monuments) used as a basis for accepting. If not accepted or if nothing was found, state evidence used as a basis for establishing location. If reestablished through lost corner proportionate methods, indicate all monuments, distances and directions used to establish. Indicate type of monument found or set and sign post.

June 13, 1977 - Philip Hansen set a 1-1/2" iron pipe by single proportion in the centerline of old Highway "8". He also set a 2-1/2" Witness monument 39.60 feet North (60 links) and 2 Red Pine bearing trees. - See U.S.P.L.S. Monument Record.



April 25, 2005 - Due to road construction Nicolet Surveyors, Inc. was hired by the Oneida County Land Information Office to preserve the location of this survey marker. Jonathan W. Dulin found the 2 Red Pine bearing trees and the 2-1/2" Aluminum witness monument, but did not find the corner. We reset the corner using the 2 bearing trees and the witness monument. We set a 2" capped Oneida County aluminum monument 3" below the gravel roadbed of old Highway "8" and set 2 new witness corners as shown below.

November 7, 2007 - The Oneida County Land Information Office hired us to go and revisit the corner because the installation of a new power line may have disturbed this corner. We found a 2" capped Oneida County aluminum monument and set 1 new witness corner as shown below.

(c)(d)(e) Plan view of corner with ties to at least 4 witness monuments. If in disagreement with previously established corner, show the distances between the two corners and also indicate the ties to the disputed corner.



LEGEND

-  2" Oneida County Aluminum Monument Set
-  3/4" x 24" Iron Rebar Set Weighing 1.50 lbs/lin. ft.
-  2-1/2" Oneida County Aluminum Witness Monument Found

14" Red Pine
Distance to center of tree. Also the top half of the tree has been cut off.

Concrete Power Pole Base
"X" Chiseled on concrete base South of power pole

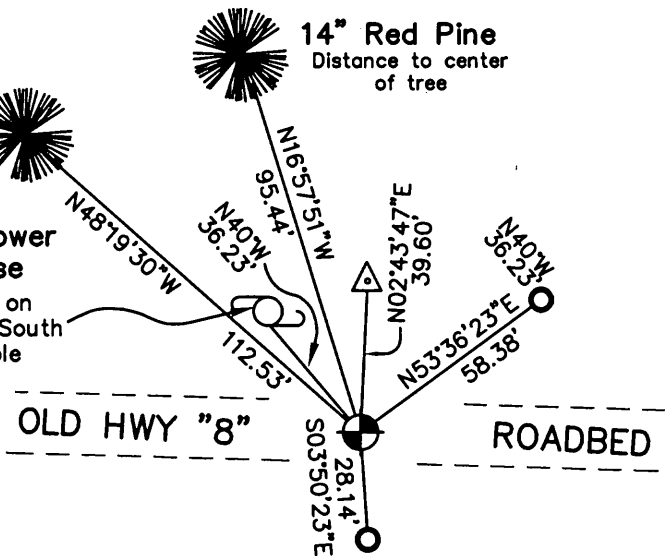

(i) I, Jonathan W. Dulin, certify that the corner location on this record was determined by me under my direction and control and that this U.S. Public Land Survey Monument is correct and complete to the best of my knowledge and belief.

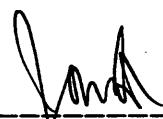
Signature

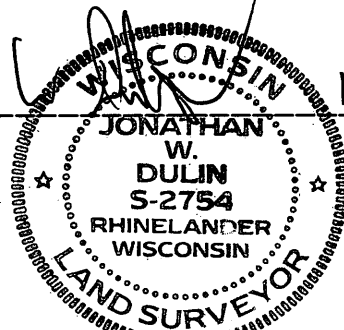

11/8/2007
Date

REGISTER OF DEEDS OFFICE
ONEIDA COUNTY, WIS.

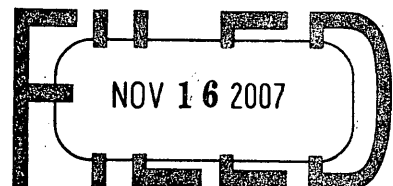

At _____ O'Clock _____ M
THOMAS H. LEIGHTON
REGISTER OF DEEDS
3611252000