

CERTIFIED LAND CORNER RESTORATION

Index No. S-21

State of Wisconsin }
 County of Oneida } ss.

I Philip T. Hansen do hereby certify that on the 26th day of July, 1976, I found evidence of the 1/16 corner of section 25 and 26 Township 36 North, Range 11 East, Fourth Principal Meridian, as described hereon, and that from this evidence I established a new monument and accessories as described hereon to perpetuate the original location of this corner.

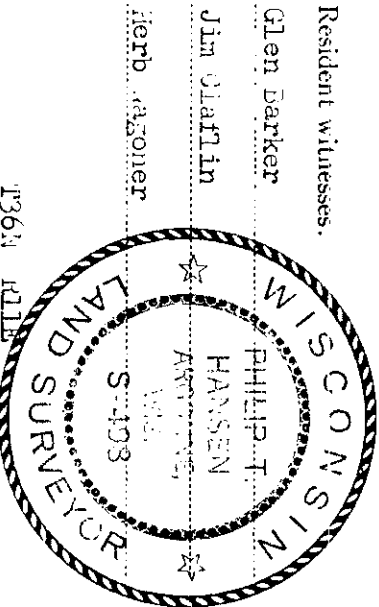

Resident witnesses:

Glen Barker

Jim Diatlin

Herb Razoner

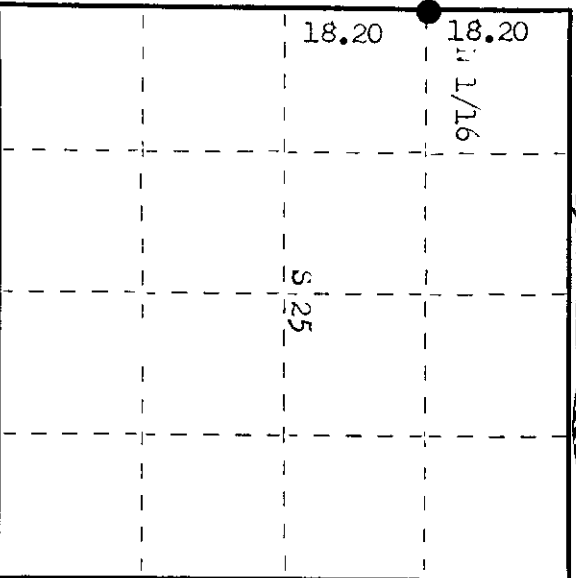

○ = Corner monument restored.

History of original corner establishment:

Original corner established by B.F. Dorr, County Surveyor, in 1899. Set post and marked BT - Tamarack 13" x 170" x 17 links. Corner recovered by H.C. Lawrence, Registered Land Surveyor, in 1954. From recovered (Dorr's) 1/4 corner, ran north on random line between Sec. 25 and 26. at 18.20 chains, recovered Dorr's Tamarack BT 13 links west at right angles. Set new post from this BT and marked BBT - Cedar 10" x 54" x 25 links, bearing of true line is 0° 50' E.

Description of corner evidence found:

Recovered Lawrence's 5" cedar post, squared and scribed 1/16 25, 1/16 26, laying down. Recovered the hole, which checked out with calls to BT.

Recovered Dorr's - Tamarack 13" x 170" x 17 links, now a decaying stump. Cedar 10" x 54" x 25 links - broken off 1 ft. above ground. Scribe 1/16 25, BT.

Description of monument and accessories I established to perpetuate the original location of this corner.

Replaced wood post with 1 1/2" OD iron pipe with 2" brass cap stamped. Monument projects 8" above ground. Drove support stakes in beside iron pipe. BT - Cedar 10" x 54" x 25 links, scribed 1/16 BT. Cedar 8" x 71" x 18.5 links, scribed 1/16 BT. Monument and BT's painted blue.

498
 130th Mile
 N 1/16 26 | 25
 CPI-1976

Dated at Oneida, Wis., this 23rd day of August, 1976.

Signature: *Philip T. Hansen* Title: Registered Land Surveyor Registration No. S-498
 (County Surveyor, Registered Land Surveyor, or other duly authorized official)

Office of Register of Deeds, County of Oneida. I hereby certify that the within instrument was filed in this office for record on the 27th day of Sept. 1976 at 2:15 o'clock P.M.

Thomas George Kieckhefer
 (Register of Deeds)

By: _____ Deputy

00011263000

U.S. PUBLIC LAND SURVEY MONUMENT RECORD

State of Wisconsin

County of: **ONEIDA** }

I, **DANIEL K. PLEOGER**, do hereby certify that on the 26th day of June, 2000,
I established the N 1/16 corner between sections 25 and 26
 Township **36 North**, Range **11 East**, Fourth Principal Meridian, as described hereon;
 and made new accessories as described hereon to perpetuate the original location of this corner:

Description of original monument and accessories and subsequent restorations:

B.F. Dorr, 1899
 Set post.
 Tamarack 13 S17W 17 lks.

H.C. Lawrence, 1954
 Found Dorr's BT, set new post from BT.
 Cedar 10 N54E 25 lks.

Phil Hansen, July 26, 1976. Certified Land Corner Restoration.
 Replaced Lawrence's post with a 1 1/2" iron pipe with brass cap.
 Cedar 10 S24W 25 lks.
 Cedar 8 N71'E 18.5 lks.

EVIDENCE FOUND AND JUSTIFICATION FOR LOCATING CORNER AS SHOWN:

I established the N 1/16 corner between sections 25 and 26 by normal section subdivision.
 Set a 1" x 42" iron pipe with aluminum cap, projecting 15" above ground.
 Found Hansen's iron pipe at N77-17-15E, 2.56 feet. Removed the cap from the found pipe.

BTs: 6" cedar N27W 19.79 feet
 11" cedar N78E 15.06 feet
 10" cedar S22W 15.63 feet

All blazed and scribed 1/16 BT, measured to 60d nail in BTs.

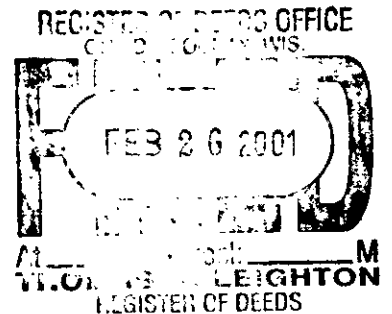

| | | | |
|------|---|------|--|
| T36N | | R11E | |
| | | | |
| | S | 26 | |
| | | | |
| | | | |

Resident witnesses
 Dated at Winter, Wisconsin, this 12th day of January, 2001.

Signature *Daniel K. Pleoger* Title **Registered Land Surveyor**
 Surveyors Registration No. **1537**
 Office of _____ County of _____
 I hereby certify that the within instrument was filed in this office for record on
 the _____ day of _____ 19____, and was filed in Book No. _____
 Page No. _____ of County Records.
 Signature _____ Title _____