

CERTIFIED LAND CORNER RESTORATION

Index No. V-6

State of Wisconsin

County of Oneida } ss.

I, Phillip T. Hansen, do hereby certify that on the 4th day of December, 1979, I found evidence of the W 1/16 corner of Sections 29 and 32 Township 36, North, Range 11 East, Fourth Principal Meridian, as described hereon; and that from this evidence I established a new monument and accessories as described hereon to perpetuate the original location of this corner.

Resident witnesses:

Glen Barker

Jim Clafflin

Herb Wagoner

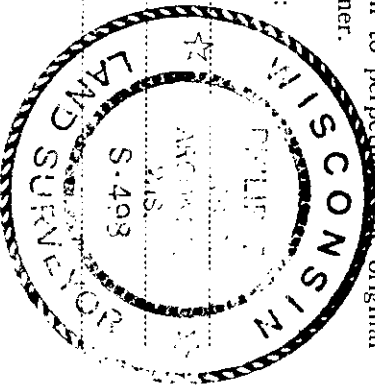

History of original corner establishment:  
 Corner established by H.C. Lawrence, Registered Land Surveyor, in 1955. Ran line from section corners 28, 29, 32 and 33 81.32 chains to close out 32 links north of section corners 29, 30, 31 and 32. Established 1/4 corner at 16 links south at 40.66 chains. Set W 1/16 at 20.33 chains intermediate, 24 links south of random. Set 6" cedar post and marked NBT's - W.Spruce 7" N40°W 62 links - no other trees available (an old fence line N-S) posts and wire down under moss and water.

Description of corner evidence found:

Recovered 6" squared cedar post, scribed W 1/16 BT visible, standing in poor condition.  
 Recovered W.Spruce 7" N40°W 62 links (62.5 links) down and dead, scribing BT visible.

Description of monument and accessories I established to perpetuate the original location of this corner.

Replaced cedar post with 1-1/2" iron pipe with 2" brass cap, stamped:

Monument projects 18".

Marked NBT's - B.Spruce 6" N27°W 64 links

Maple 5" S88°W 17.2 links, scribed 1/16 BT.

S498  
 T36N R11E  
 S+29  
 S+32  
 CPI-1979

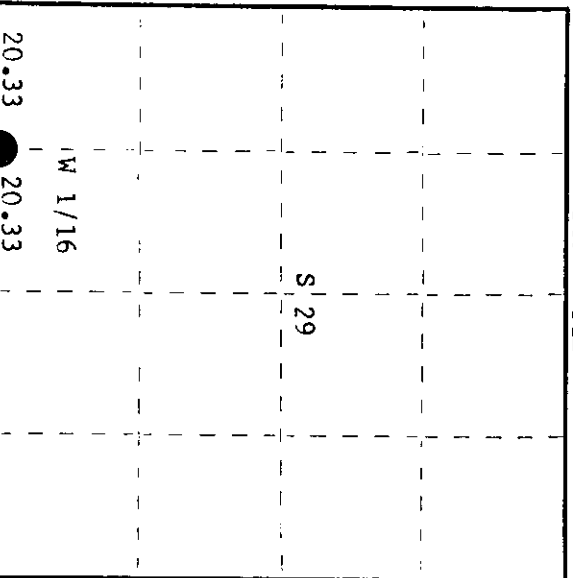

○ = Corner monument restored.

Dated at Rhineland, Wis., this 26th day of December, 1979

Signature Phillip T. Hansen Title Registered Land Surveyor Registration No. S-498  
 County Surveyor, Registered Land Surveyor, or other duly authorized official

Office of Register of Deeds, County of Oneida  
 Instrument was filed in this office for record on the 14th day of January, 1980  
 at 30 o'clock P. M.

Donna Neugebauer  
 (Register of Deeds)

By: \_\_\_\_\_ Deputy

02007119