

CERTIFIED LAND CORNER RESTORATION

Index No. W-160

State of Wisconsin } ss.
County of Oneida }

History of original corner establishment:
No evidence of any previous corner.

I Daniel K. Plegger, do hereby certify that on the 3rd day of December, 1981, I found ~~existence of the~~ NE 1/16 corner of Section 34 Township 36 North, Range 11 East, Fourth Principal Meridian, as described hereon; and that from this evidence I established a new monument and accessories as described hereon to perpetuate the original location of this corner.

Description of corner evidence found:
Established NE 1/16 by subdivision of the NE 1/4. Location of NE 1/16 is S83-30-32E 1357.91 ft. of NC 1/16 and N2-39-56E 1296.87 ft. of EC 1/16.

Resident witnesses:

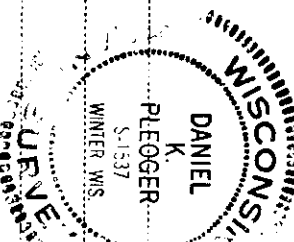

T36N R11E

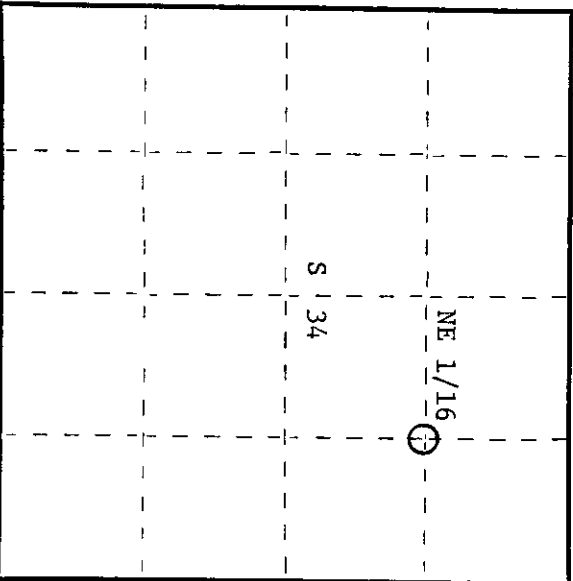

Description of monument and accessories I established to perpetuate the original location of this corner.
Set a 1 1/2" iron pipe with 2" diameter aluminum cap stamped:
Monument projects 18" above ground.

Marked NBTs:
Sugar 6" S7°E 34.59 ft.
Sugar 5" N87W 48.20 ft.
Scribed 1/16 - B.T.

S1537
T36N R11E
NE 1/16 S 34
CPI - 1981

Dated at Rhinelander, Wis., this 8th day of January, 1982.

Signature: Daniel K. Plegger, Title Registered Land Surveyor, Registration No. 1537
(County Surveyor, Registered Land Surveyor, or other duly authorized official)

Office of Register of Deeds, County of Oneida, I hereby certify that the within instrument was filed in this office for record on the 24th day of March, 1982 at 10:35 o'clock P.M.

Devin Seige Tucker
(Register of Deeds)

By: Deputy

3611343010