

CERTIFIED LAND CORNER RESTORATION

Index No. W-14

State of Wisconsin }
County of Oneida } ss.

History of original corner establishment:
No evidence of any previous corner.

I Daniel K. Plegger, do hereby
certify that on the 11th day
of December, 19 81, ~~XXXXXX~~
Est. ~~XXXXXX~~ of the NW 1/16
corner of Section 34
Township 36, North, Range
11, East, Fourth Principal Meridian,
as described hereon; and that from this evidence
I established a new monument and accessories
as described hereon to perpetuate the original
location of this corner.

Description of corner evidence found:
Corner established by subdivision of NW 1/4. Location of NW 1/16 is N80-30-10W 1544.22
ft. and N1-08-42E 1289.09 ft. of WC 1/16.

Resident witnesses:

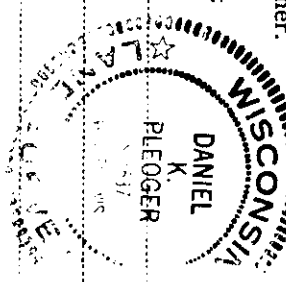

T36N R11E

Description of monument and accessories I established to perpetuate the original location of this corner.
Set a 1 1/2" iron pipe with 2" diameter aluminum cap stamped:
Monument projects 18" above ground
Marked NBTs:
S1537

Black spruce 5" N56W 34.18 ft.
Black spruce 5" S54W 15.68 ft.
Scribed 1/16 - B.T.

T36N R11E
NW 1/16 S 34
CPI - 1981

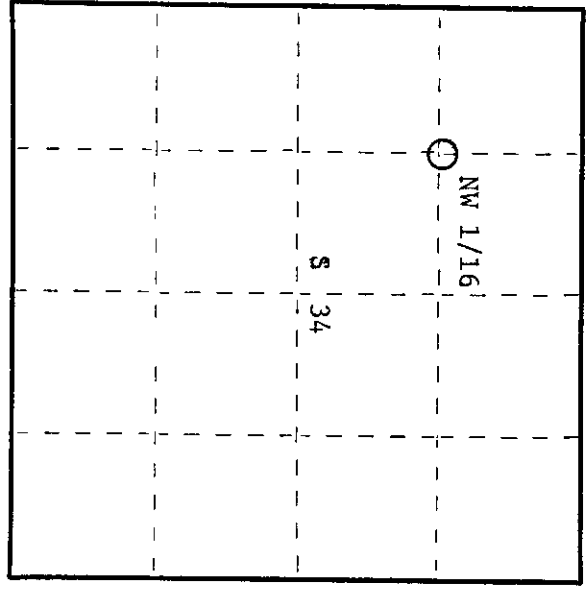

○ = Corner monument restored.

Dated at Rhineland, Wis., this 8th day of January, 1982.

Signature: Daniel K. Plegger Title: Registered Land Surveyor Registration No. 1537
(County Surveyor, Registered Land Surveyor, or other duly authorized official)

Office of Register of Deeds, County of Oneida
Instrument was filed in this office for record on the 24th day of March, 1982
at 10:35 o'clock P.M. I hereby certify that the within

Dore Verage Tucker
(Register of Deeds)

By: _____ Deputy

361343030