

CERTIFIED LAND CORNER RESTORATION

Index No. **X-18**

State of Wisconsin }
County of **Oneida** } ss.

History of original corner establishment:
No records of any previous survey.

I **Phillip T. Hansen**, do hereby certify that on the **25th** day of **April**, 19 **78**, I ~~know~~ **know** established the **WC 1/16** corner of **Section 35**, Township **36**, North, Range **11 East**, Fourth Principal Meridian, as described hereon; and that from this evidence I established a new monument and accessories as described hereon to perpetuate the original location of this corner.

Resident witnesses:
Glen Barker
Jim Claffin
Herb Wagoner

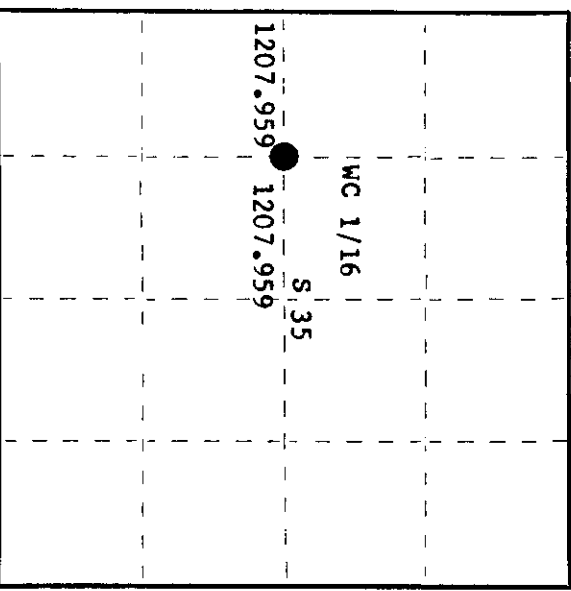
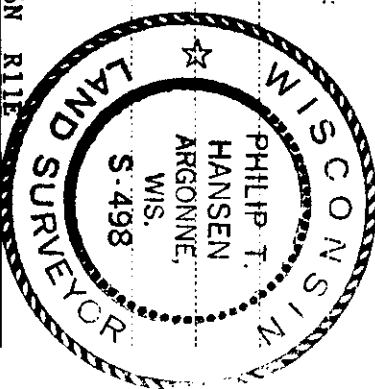

○ = Corner monument restored.

Description of corner evidence found:

No evidence of any corner recovered.
Corner established by traverse and computation from previously established C 1/4 corner and W 1/4 corner. Computed distance is 2415.918 feet at bearing S 85° 50' 11" W.
Set WC 1/16 at 1207.959 feet intermediate.

Description of monument and accessories I established to perpetuate the original location of this corner.

Set 1 1/2" iron pipe with 2" brass cap projecting 16" above ground. Cap stamped:
Marked NBT's - cedar 8" N42°E 29.65 feet
W.Pine 14" S11°W 32.35 feet, scribed 1/16 BT.

S498
T36N R11E
WC 1/16 S.35
CPI-1978

Dated at **Rhinelander**, Wis., this **1st** day of **May**, 19 **78**

Signature *Phillip T. Hansen* Title **Registered Land Surveyor** Registration No. **S-498**
(County Surveyor, Registered Land Surveyor, or other duly authorized official)

Office of Register of Deeds, County of **Oneida**
Instrument was filed in this office for record on the **15th** day of **May**, 19 **78** at **2:00** o'clock **P.** M. I hereby certify that the within

By *Dennis V. Berger* (Registered of Deeds)
Joseph M. Brown Deputy

3611352030