

CERTIFIED LAND CORNER RESTORATION

Index No. W-19

State of Wisconsin

County of Oneida } ss.

I Phillip T. Hansen, do hereby certify that on the 9th day of January, 19 78, I found evidence of the NC 1/16 corner of Section 35

Township 36, North, Range 11 East, Fourth Principal Meridian,

as described hereon; and that from this evidence I established a new monument and accessories as described hereon to perpetuate the original location of this corner.

Resident witnesses:

Glen Barker

Jim Claffin

Herb Wagoner

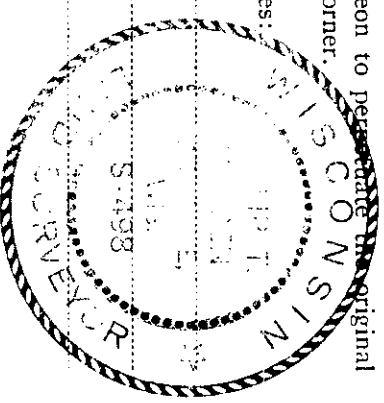

T36N R11E

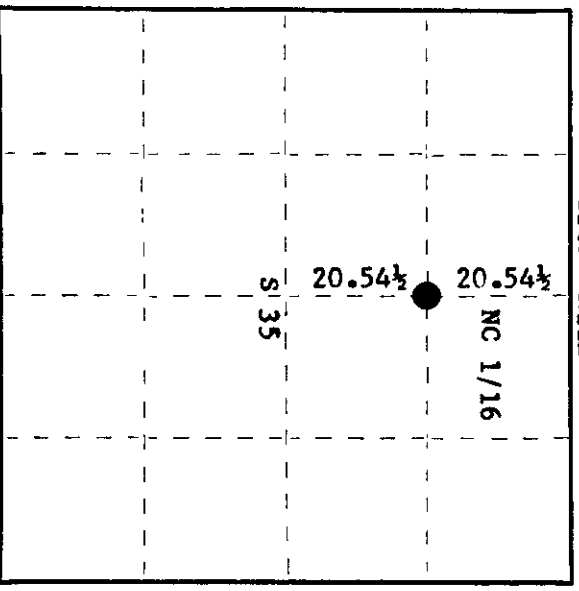

History of original corner establishment:

Original corner established by B.F. Dorr, County Surveyor, in 1906. Marked BT - White Pine 18" S60°W, 9 1/2 links.

H.C. Lawrence, Registered Land Surveyor, recovered this corner in 1954. Recovered remnants of old stake and point intact in ground. Recovered stump and white pine BT S60°W, 9 1/2 links.

Description of corner evidence found:

Recovered B.F. Dorr's white pine BT stump, scribe marks still visible. While digging hole at point N60°E, 9 1/2 links, found the remains of Dorr's point in ground. No evidence of H.C. Lawrence's post recovered.

Description of monument and accessories I established to perpetuate the original location of this corner. Set 1 1/2" iron pipe with 2" brass cap in place of old point. Cap stamped:

Monument projects 24" above ground. Marked NBT's - White Pine 7" N72°E, 42.3 links White Pine 8" S66°W, 46.1 links, both scribed 1/16 BT.

S498  
T36N R11E  
NC 1/16 S 35  
CPI-1978

Dated at Rhineland Wis., this 11th day of January, 19 78

Signature Phillip T. Hansen Title Registered Land Surveyor Registration No. S-498  
(County Surveyor, Registered Land Surveyor, or other duly authorized official)

Office of Register of Deeds, County of Oneida I hereby certify that the within instrument was filed in this office for record on the 27th day of January, 19 78 at 2:30 o'clock P. M.

Dorcas Verger Kuhl  
(Register of Deeds)

By Dorcas Verger Kuhl Deputy

0708 W-19