

CERTIFIED LAND CORNER RESTORATION

Index No. Y-25

State of Wisconsin }
County of Oneida } ss.

I, Philip T. Hansen, do hereby certify that on the 23rd day of August, 1976, I found evidence of the S 1/16 corner of Section 31 & 36 Township 36 North, Range 11 & 12, Fourth Principal Meridian, as described hereon; and that from this evidence I established a new monument and accessories as described hereon to perpetuate the original location of this corner.

Resident witnesses:

Glen Barker

Jim Claflin

Herb Wagoner

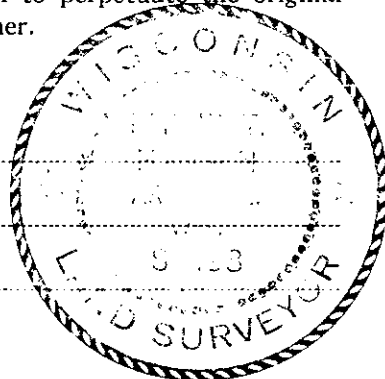

FORM 985 H. C. MILLER CO., MILWAUKEE

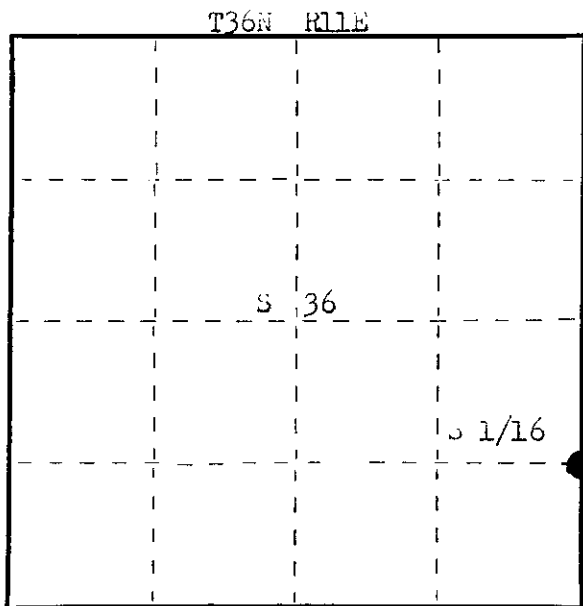

○ = Corner monument restored.

History of original corner establishment:

Corner established by Chas. Walker, Forest County Surveyor. No record of survey or BT's established.

Description of corner evidence found:

Recovered pieces of old post and the old point well preserved in muck and moss. This was a squared cedar post.

Unable to recover any evidence of any BT's.

Description of monument and accessories I established to perpetuate the original location of this corner.

Replaced point of old cedar post with 1 1/2" iron pipe with 2" brass cap, stamped. Monument projects 24" above ground.

NBT's - Tamarack 0" North 11.6 links, scribed 1/16 BT.

Tamarack 8" S 54° E 62.2 links, scribed 1/16 BT.

Monument and BT's painted blue.

5498
R T36N R
11 36 | 31 12
E E
CPI-1976

Dated at Orinlander, Wis., this 31st day of August, 1976.

Signature Philip T. Hansen Title Registered Land Surveyor Registration No. 5498
(County Surveyor, Registered Land Surveyor, or other duly authorized official)

Office of Register of Deeds, County of Oneida. I hereby certify that the within instrument was filed in this office for record on the 32nd day of September, 1976 at 10:00 o'clock P M.

Loris Verage Kuehn
(Register of Deeds)

By.....Deputy

09019E1175