

U. S. PUBLIC LAND SURVEY MONUMENT RECORD

Note: This form is intended and designed to fulfill all requirements of Wisconsin Administrative Code, Chapter A-8 7.08 U.S. Public Land Survey Monument Record (3)(a)(b)(c)(d)(e)(f)(g)(h)(i). An additional sheet may be added if necessary to conform with said requirements.

(a) CORNER LOCATION: State Plane Coordinates
East 1/4 corner of Sec. 3 X _____
 Township 37 North Y _____
 Range 4 East Datum Base _____
 Town/City Lynne County of Oneida

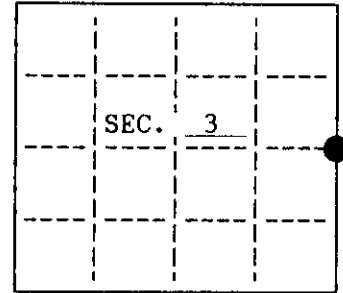

(b) HISTORY OF ORIGINAL CORNER ESTABLISHMENT Original B.T.'s

Original Surveyor: Edward Palmer
 Date of Survey: Commenced October, 1864 8" Hemlock N57°W, 18 lks.
 Completed October, 1864 14" W. Pine N38°E, 9 lks.

(b)(f)(g)(h) Description of monument found at this corner and if it was accepted, state all evidence (material, testimonial, occupational, plats, records, other monuments) used as a basis for accepting. If not accepted or if nothing was found, state evidence used as basis for establishing location. If reestablished through lost corner proportionate methods, indicate all monuments, distances and directions used to establish. Indicate type of monument and sign post found or set.

June 29, 1994 - I found no evidence of the original or any subsequent survey. I set a 2-1/2"x 30" Oneida County Aluminum Monument by single proportionate measure. The Northeast Section Corner bears N0°01'37"E, 2500.28 feet (GLO 39.63 ch.). The Southeast Section Corner bears S0°01'37"W, 2523.62 feet (GLO 40.00 ch.). I witnessed the monument as shown below and set a plastic signpost north 1 foot.

(c)(d)(e) Plan view of corner with ties to at least 4 witness monuments. If in disagreement with previously established corner, show the distances between the two corners and also indicate the ties to the disputed.

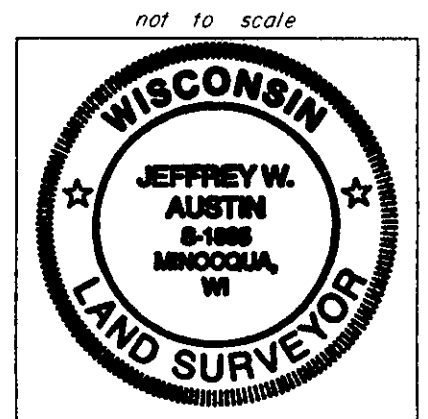
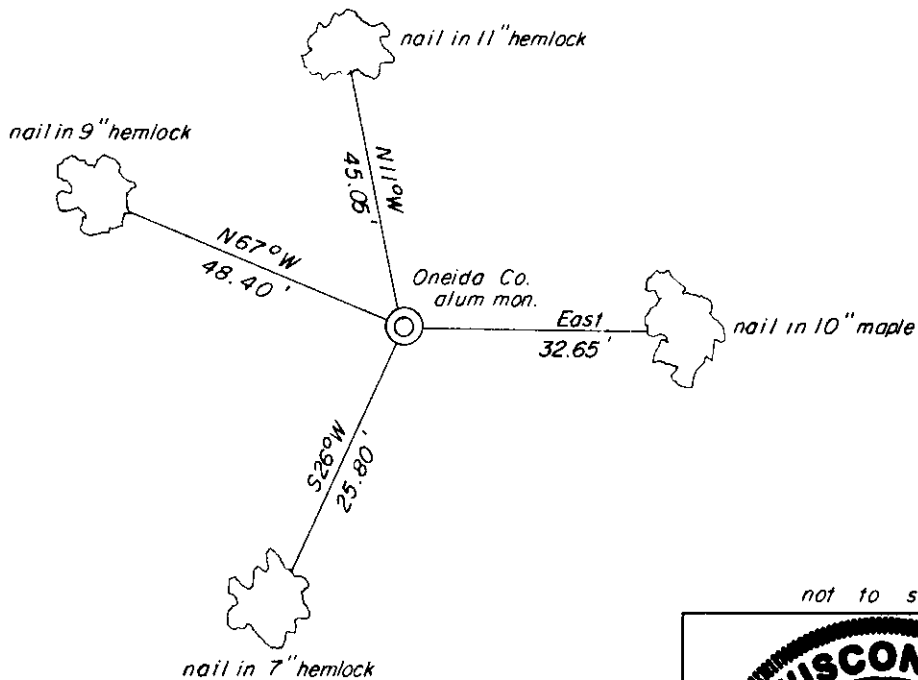

(i) I, Jeffrey W. Austin, Registered Land Surveyor hereby certify that the corner location on this record was determined by me or under my direction and control and that this U.S. Public Land Survey Monument Record is correct and complete to the best of my knowledge and belief.

Signature [Handwritten Signature] Date 9-22-94

 Signature Luman-Foltz & Associates, Inc. Date

INDEX NO. C-17

3704032000