

U.S. PUBLIC LAND SURVEY MONUMENT LOCATION RECORD

Recorders Data

CORNER: North 1/4 SECTION: 11 TOWNSHIP 37 NORTH RANGE 5 EAST WEST

FOR M.C. CORNER INDICATE: NAME OF WATERWAY N/A SECTION LINE N/A

~~(CITY)~~(VILLAGE)~~(TOWN)~~ OF: Little Rice COUNTY OF: Oneida

Description of monument found or placed and all other evidence used as a basis for monument location; including all monuments and related measurements required if the corner location is reestablished by lost corner proportionate methods. Also indicate name of original surveyor, survey date, corner monument set and established bearing trees, witness or reference monuments with ties from available records.

No metallic indication within roadway area by metal locator, as newer roadway construction in about 1996 per local resident, undoubtedly removed previous record iron pipe monument referred to herein. I did find a 3/4" dia. iron pipe bent at grade, with an old 5" square wood marker post nearby and scribed '1/4 WC' on its South face and 'S2' on its North face, on top of North roadway bank; also an older decayed wood post flat on grade nearby. So I carefully pulled the older bent iron pipe to reveal plumb hole below grade and reset a new iron pipe noted for ties below, which check measured 30 feet North of existing blacktop pavement centerline, and similar to same offset iron pipe that I had recovered at the NW corner of Section 11 on May 13 & 14, 1998. I therefore set a 3/4" dia. by 12" long iron rod flush as best corner location 30.00' South by compass in roadway surface. No other corner evidence was observed or detected with metal locator within the roadway or immediately adjacent area. I left old iron pipe and wood posts flat on grade near new Witness No. 1.

In 1863, J.H. Jenkins set a wood post as the corner and marked OBTs, a 10" Pj S51°W 5 lks and a 6" Spruce N44°E 20 lks, which are all now obliterated within roadway area. In 1974, Margitan advised he had found and used an iron pipe at this corner in center of roadway for his Plat of Survey, filed as B-797, Oneida County survey records; as well as McMullen per his 1990 Plat of Survey, filed as B-2187, Oneida County records. Upon further query, neither had measured ties to the location. This recovery completed June 5, 1998; there were no witnesses other than passer-bys in vehicles.

Plan view map of monument location with bearing and distance ties to a minimum of four(4) described witness or reference monuments of concrete, natural stone, iron, live bearing trees or equivalent material. If applicable, also show a minimum of two(2) bearing and distance ties to any other monument found and not accepted; including the bearing and distance from the accepted monument. Indicate the basis for bearings of reference ties if not referenced to magnetic north.

NORTH

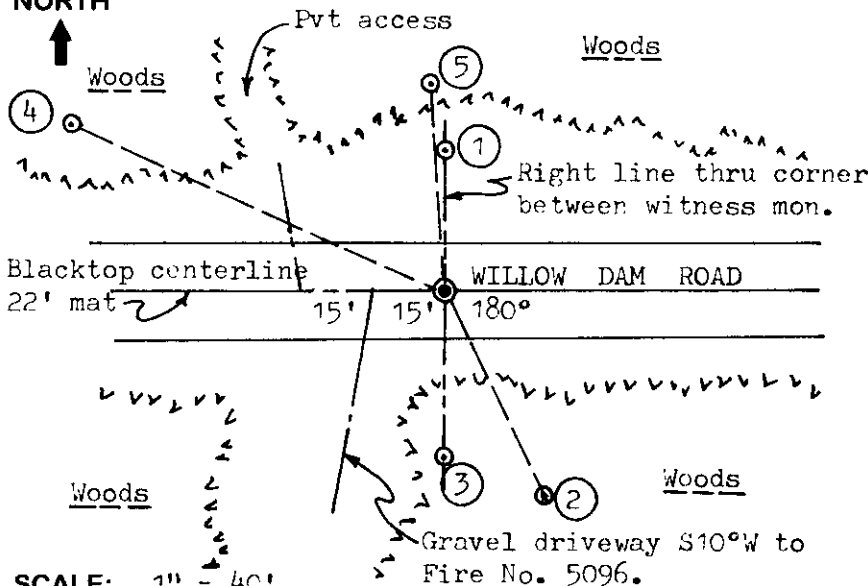

WITNESS MONUMENT TIES:

- ① 1" dia. by 4' long iron pipe set with standard Reference Mark cap in top 4" above grade, North at 30.00'; from old W.C. location.
- ② New BT 8" Balsam S25°E 47.45'.
- ③ 1" dia. by 24" long iron pipe set with standard Reference Mark cap flush with grade, South 34.86'.
- ④ New BT 20" Pr N65°W 85.04', with BT sign nailed to South face.
- ⑤ Older BT of unknown record, with upper face blaze open & scribed, N03°W 43.77'.

Note: Standard white poly 'T' marker post set 6" North of Witness No. 1.

SCALE: 1" = 40'

Unless otherwise indicated, all bearing tree ties are to a .25" dia. by 2.5" long PK nail with a 1.25" dia. steel washer driven into unblazed right face and a .25" dia. by 2.5" long PK nail with a 2" dia. steel washer stamped 'BT' is also driven into unblazed face of bearing tree at DBH; the basis for measured bearings is magnetic to nearest degree and all distances are horizontal measure to nearest 1/100th feet.

LAND SURVEYOR CERTIFICATION:

I, William C. Rohde, hereby certify that I am a duly licensed Professional Land Surveyor in Wisconsin, that this USPLS monument location was determined by me or under my direction and control, and that this U.S. Public Land Survey Monument Location Record is true and correct to the best of my knowledge and belief.

William C. Rohde Date: 6-6-98
Signature

	1	1	

INDEX NO. E 19

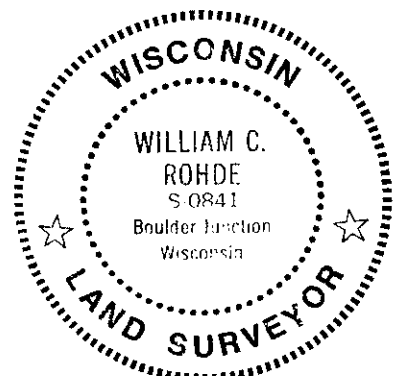

RLS SEAL

SHEET NO. 1 OF 1

This form is intended to fulfill requirements of Chapter A-E 7.08 (3)(a)(b)(c)(d)(e)(f)(g)(h)(i) U.S. Public Land Survey Monument Location Record, Wisconsin Administrative Code. Use reverse side for geodetic location data and/or continuation purposes.

SECTION LOCATION MAP

INDEX NO. E 19
370502 0020

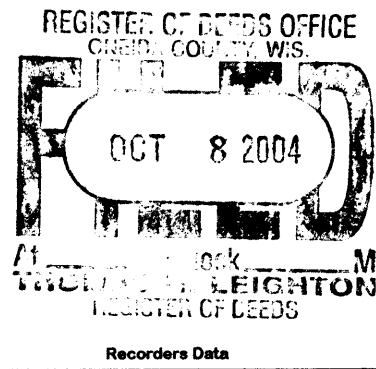

This form is intended to fulfill the requirements of Chapter A-E7.08 (3)(a) thru (i) U.S. Public Land Survey Monument Location Record, Wisconsin Administrative Code. Use the reverse side of form for continuation.

U.S. PUBLIC LAND SURVEY MONUMENT LOCATION RECORD

Recorders Data

USPLS CORNER: NORTH 1/4 SECTION: 11 TOWNSHIP: 37 NORTH RANGE: 5 EAST
 NAME OF WATERWAY FOR M.C. CORNER : N/A SECTION LINE: N/A
 (CITY)(VILLAGE)(TOWN) OF: LITTLE RICE COUNTY OF: ONEIDA

Description of monument found or placed and all other evidence used as the basis for monument location; including monuments and measurements required if the corner location was reestablished by lost corner proportionate methods. Also indicate name of the original surveyor, original survey date and the corner monument, bearing trees, witness or other reference monuments established, including measured bearing and distance ties, from available survey records.

THIS CORNER RESET AND RECORD REFERENCES CHECKED WITH APPROVAL OF ONEIDA COUNTY SURVEYOR DUE TO ROAD CONSTRUCTION. See my U.S. Public Land Survey Monument Location Record dated 06/06/98 which is filed in Oneida County records.

Using a magnetic locator, I could not detect the iron rod that I had set in the roadway at corner location in 1998, so I reset the corner with a 1/2" dia. by 4.5" long tapered stainless steel pin with geared top flush in new blacktop road mat on a right line with transit between the north & south iron pipe reference monuments of record, which checked within 0.01 feet; I also set a 1/4" dia. by 2.5" long PK nail on the right line at the north and south edges of the new blacktop road mat.

The pin at corner location is now located 8.2 feet South of the North edge of new pavement, and checks by reference to the NW, North and SE BTs noted in my 1998 location record as well.

Standard white poly 'T' marker post still exists 30.5' North of corner location.

This recovery completed July 13, 2004; there were no direct witnesses other than vehicular traffic.

Plan view map of monument location with bearing and distance ties to a minimum of four(4) described witness or reference monuments of concrete, natural stone, iron, live bearing trees or equivalent material. If applicable, also show a minimum of two(2) bearing and distance ties to any other monument found and not accepted; including the bearing and distance from the accepted monument.

WITNESS MONUMENT TIES:
 Note:
 No new references measured as all witness monument ties exist as were measured and noted on my location record previously filed in Oneida County records in 1998.

SCALE: N/A

Unless otherwise indicated, all bearing tree ties are to a .25" dia. by 2.5" long PK nail with a 1.25" dia. steel washer driven into unblazed right face and a .25" dia. by 2.5" long PK nail with a 2" dia. steel washer stamped BT is also driven into unblazed face of bearing tree at DBH; the basis for measured bearings is by compass to nearest degree and all tie distances are measured horizontal by steel tape corrected to nearest 1/100th feet at standard temperature of 68° F.



LAND SURVEYOR CERTIFICATE:
 I, William C. Rohde, hereby certify that I am duly licensed as a Professional Land Surveyor in the State of Wisconsin; that this USPLS monument location was determined by me and/or under my direct supervision and control; and that this U.S. Public Land Survey Monument Location Record is true and correct to the best of my knowledge and belief.
 Signed: *William C. Rohde*
 William C. Rohde RLS 841

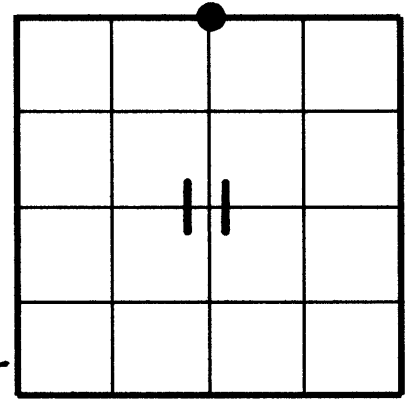

3705020020

U.S. PUBLIC LAND SURVEY MONUMENT RECORD

Note: This form is intended and designed to fulfill all requirements of Wisconsin Administrative Code, Chapter A-E 7.08 U.S. Public Land Survey Monument Record (3)(a-i).

(a) CORNER LOCATION
 1/4 Cor. of Secs. 2 & 11
 Township 37 North
 Range 5 East of the 4th P.M.
 Town of Little Rice
 County of Oneida

WISCORS - Oneida County
 N: 193,993.57 USft
 E: 157,846.84 USft
 Datum: NAD 83(2011)
 GNSS Method: RTN - Direct
 GNSS Control: WISCORS VRS

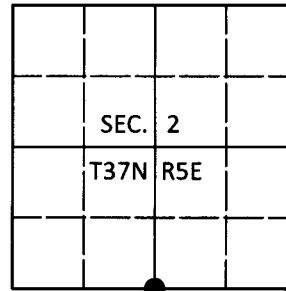

(b) HISTORY OF ORIGINAL CORNER ESTABLISHMENT

Original Surveyor: _____ Original Accessories: _____
 Date of Survey Commenced: _____ See previous USPLS Monument Record
 Completed: _____

(b)(f)(g)(h) Description of monument found at this corner and if it was accepted, state all evidence (material, testimonial, occupational, plats, records, other monuments) used as a basis for accepting. If not accepted or if nothing was found, state evidence used as basis for establishing location. If re-established through lost corner proportionate methods, indicate all monuments, distances and directions used to establish. Indicate type of monument and sign post found or set.

This is a perpetuation of a previous USPLS Monument Record by William C. Rohde, RLS dated June 6, 1998; revised September 4, 2004 and filed in the office of the Oneida County Register of Deeds. A complete history of the corner can be found on the previous monument record. I accept the previous location as a true and faithful perpetuation or reestablishment of the original corner location and further perpetuate it as follows.

June 5, 2018: I found and accepted the record monument, a cotton picker spindle 1 ft. North of the town road centerline. The record bearing trees at 43.77' and 47.45' are dead. I found or established accessories as shown below. I found a white vinyl sign post adjacent to the northerly reference monument.

The coordinate value shown has been verified by at least one of the following methods: 1) comparison to a previously GPS determined published value; 2) the value is the average of two or more GPS observations at a markedly different time; 3) one or more distances were measured back to the GPS observed corner from temporary GPS observed offset locations.

(c)(d)(e) Plan view of corner with ties to at least 4 witness monuments. If in disagreement with previously established corner, show the distances between the two corners and also indicate the ties to the disputed.

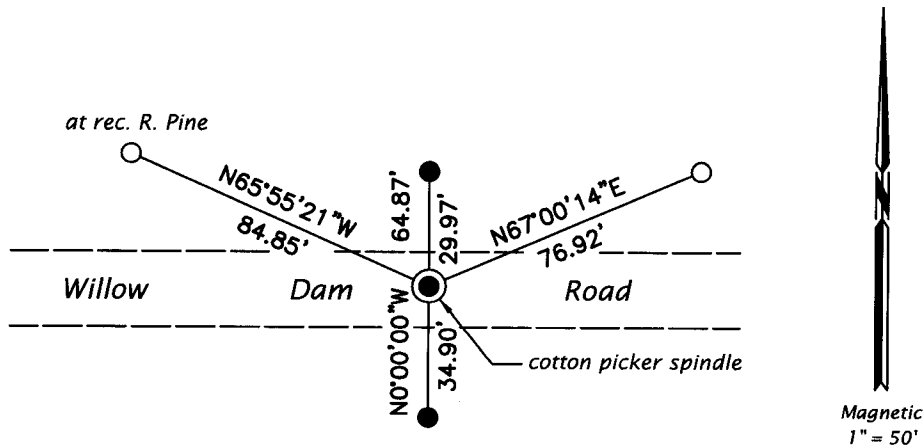

● = 1-1/4" diam. iron pipe fd.
 ○ = 3/4" diam., 24" long iron rod set



REGISTER OF DEEDS OFFICE
 ONEIDA COUNTY
 FILED

JUL 12 2018

KYLE J. FRANSON
 REGISTER OF DEEDS

(i) I, Jeffrey W. Austin, Professional Land Surveyor No. S-1885, hereby certify that the corner location on this record was determined by me or under my direction and control and that this U.S. Public Land Survey Monument Record is correct and complete to the best of my knowledge and belief.

 Signature
 JUNE 30, 2018
 Date