

U.S. PUBLIC LAND SURVEY MONUMENT RECORD

Note: This form is intended and designed to fulfill all requirements of Wisconsin Administrative Code, Chapter A-E 7.08 U.S. Public Land Survey Monument Record (3)(a)(b)(c)(d)(e)(f)(g)(h)(i). An additional sheet may be added if necessary to conform with said requirements.

(a) CORNER LOCATION: State Plane Coordinates
 S 1/4 corner of Sec. 16 X
 Township 37 North Y
 Range 5 East Datum Base
 Town/City Little Rice County of Oneida

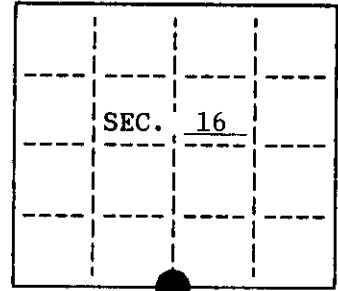

(b) HISTORY OF ORIGINAL CORNER ESTABLISHMENT
 Original Surveyor: Jos. Jenkins Original B.T.'S
 Date of Survey: ~~Commenced~~ June, 1963 8" Tamarack, N31°W, 11 lks
Completed 8" Tamarack, S27°W, 28 lks

(b)(f)(g)(h) Description of monument found at this corner and if it was accepted, state all evidence (material, testimonial, occupational, plats, records, other monuments) used as a basis for accepting. If not accepted or if nothing was found, state evidence used as basis for establishing location. If reestablished through lost corner proportionate methods, indicate all monuments, distances and directions used to establish. Indicate type of monument and sign post found or set.

June, 1940: V. M. Maine, Oneida County Surveyor, shows an "Orig. Cor." at the S 1/4 location on a sketch diagram, map No. A 647 Oneida Co. Surveyor's Office.

May, 1994: I found the original scribed post (6"x 6"). I replaced said post with an Oneida County aluminum monument (60" long) and set a plastic sign post.

(c)(d)(e) Plan view of corner with ties to at least 4 witness monuments. If in disagreement with previously established corner, show the distances between the two corners and also indicate the ties to the disputed.

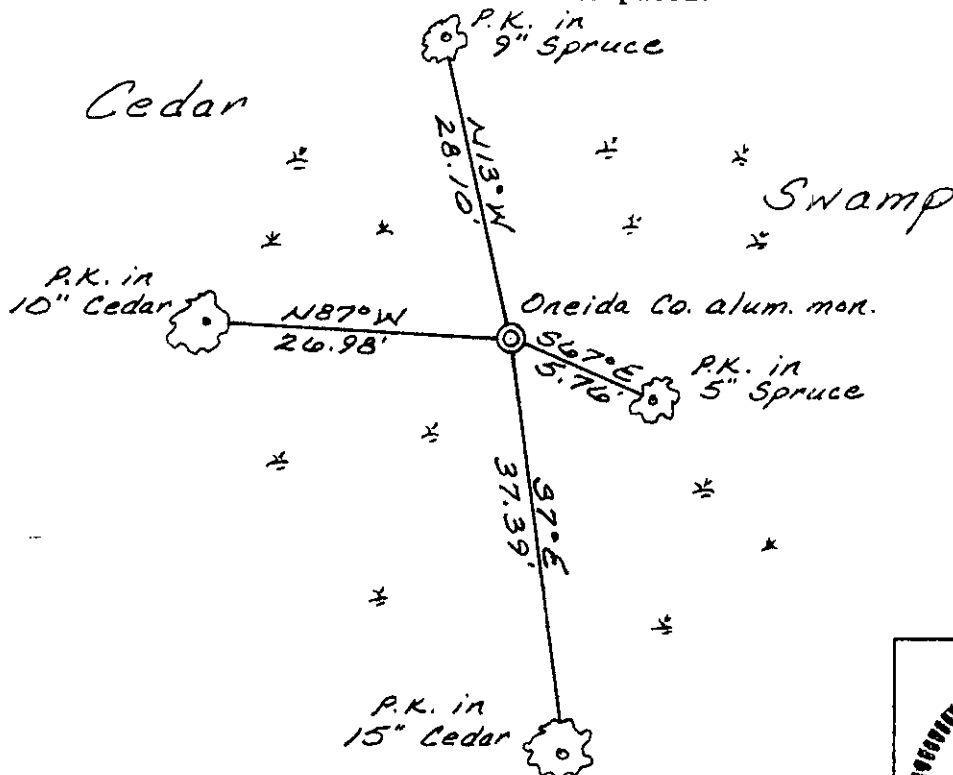

(i) I, Charles E. Winkler S-1431
 hereby certify that the corner location on this record was determined by me or under my direction and control and that this U.S. Public Land Survey Monument Record is correct and complete to the best of my knowledge and belief.

Charles E. Winkler 5/23/94
 Signature Inman-Foltz & Associates, Inc. Date

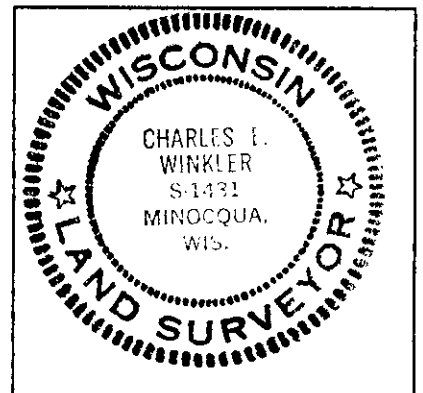

INDEX NO. 11-11

3705160020