

U.S. PUBLIC LAND SURVEY MONUMENT LOCATION RECORD

Recorders Data

CORNER: NW Section SECTION: 25 TOWNSHIP 37 NORTH RANGE 5 EAST/WEST

FOR M.C. CORNER INDICATE: NAME OF WATERWAY N/A SECTION LINE N/A

(CITY)(VILLAGE)(TOWN) OF: Little Rice COUNTY OF: Oneida

Description of monument found or placed and all other evidence used as a basis for monument location; including all monuments and related measurements required if the corner location is reestablished by lost corner proportionate methods. Also indicate name of original surveyor, survey date, corner monument set and established bearing trees, witness or reference monuments with ties from available records.

No monument observed nor detected with electronic metal locator at this corner location area within existing roadway, so I drove a 3/4" dia. by 12" long iron rod flush in the roadway blacktop pavement 30.00' East of an old 1/2" dia. iron pipe witness corner monument found with uncapped top 14" above existing grade, which I replaced with a standard 2" dia. by 30" long aluminum pipe monument with stamped Oneida County aluminum cap nearly flush with the matted surface of marsh grass. I also found an old squared wood post with faded blue paint on it and scribed 'S25 E.C.' on East face, 'S24 W.C.' on North face, 'SEC 23' on West face and 'S26' on South face. I left the old marker post in place and also left the 36" long old iron pipe flat on grade at the new monument reset. The corner falls 1' East of pavement center.

In 1863, Jenkins/GLO set a wood post as the original corner and marked BTs, a 6" Pj N02°W 8.3 lks and a 6" Pj N03°E 8.24 lks, all of which are now obliterated within existing road right-of-way. No other corner evidence observed nor detected within 1 chain of corner point.

The old witness monument and squared wood marker post found West of the existing blacktop roadway is identical in placement as that found for the West 1/4 corner and at the SW corner of Section 25, per the 1953 Plat of Survey Drawing No. 1397-1 filed in the records of Genisot & Associates, Inc., so I reset this corner location accordingly as herein noted.

This recovery completed June 8, 1998; there were no witnesses other than vehicle drive-bys. Plan view map of monument location with bearing and distance ties to a minimum of four(4) described witness or reference monuments of concrete, natural stone, iron, live bearing trees or equivalent material. If applicable, also show a minimum of two(2) bearing and distance ties to any other monument found and not accepted; including the bearing and distance from the accepted monument. Indicate the basis for bearings of reference ties if not referenced to magnetic north.

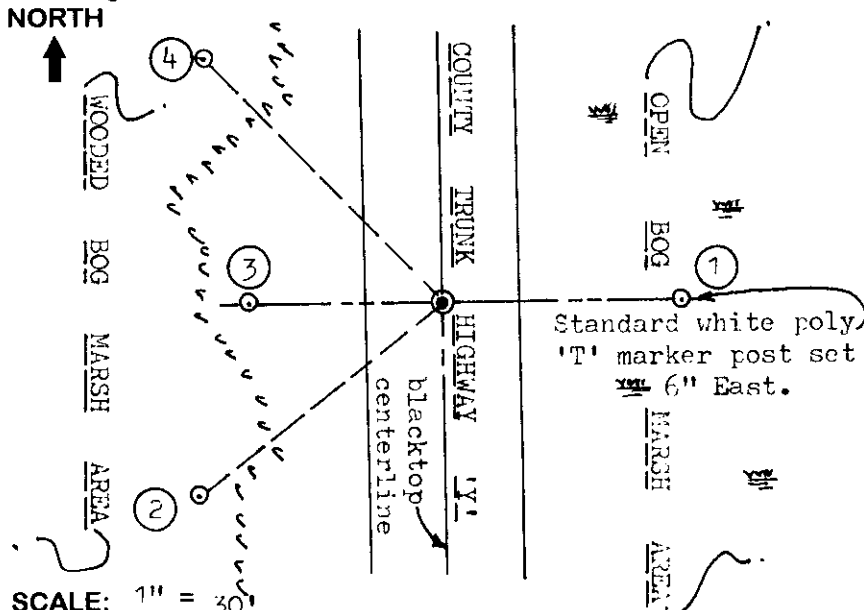

WITNESS MONUMENT TIES:

- ① 1" dia. by 30" long iron pipe set with standard Reference Mark cap 1/2" above matted marsh grass, at East 37.86'.
- ② New BT 5" Balsam Fir S53°W 48.45'.
- ③ Standard 2" dia. by 30" long aluminum pipe monument set with stamped Oneida Co. aluminum cap flush in place of old 1/2" dia. iron pipe found, West 30.00'.
- ④ New BT SW 10" trunk of double Balsam Fir, N43°W 53.68' to a PK nail with washer in left face.

SCALE: 1" = 30'

Unless otherwise indicated, all bearing tree ties are to a .25" dia. by 2.5" long PK nail with a 1.25" dia. steel washer driven into unblazed right face and a .25" dia. by 2.5" long PK nail with a 2" dia. steel washer stamped 'BT' is also driven into unblazed face of bearing tree at DBH; the basis for measured bearings is magnetic to nearest degree and all tie distances are horizontal measure to nearest 1/100th feet.

LAND SURVEYOR CERTIFICATION:

I, William C. Rohde, hereby certify that I am a duly licensed Professional Land Surveyor in Wisconsin, that this USPLS monument location was determined by me or under my direction and control, and that this U.S. Public Land Survey Monument Location Record is true and correct to the best of my knowledge and belief.

William C. Rohde Date: 6/12/98
Signature

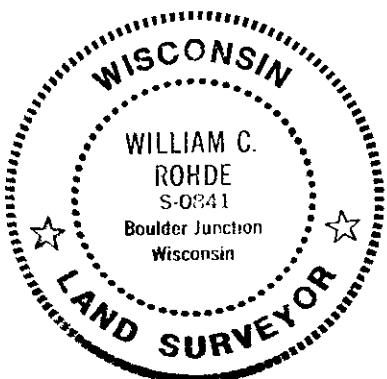

RLS SEAL

SHEET NO. 1 OF 1

This form is intended to fulfill requirements of Chapter A-E 7.08 (3)(a)(b)(c)(d)(e)(f)(g)(h)(i) U.S. Public Land Survey Monument Location Record, Wisconsin Administrative Code. Use reverse side for geodetic location data and/or continuation purposes.

		25	

SECTION LOCATION MAP

INDEX NO. R 21

3705 23 00 00

INDEX NO. R 21