

U.S. PUBLIC LAND SURVEY MONUMENT RECORD

Note: This form is intended and designed to fulfill all requirements of Wisconsin Administrative Code, Chapter A-E 7.08 U.S. Public Land Survey Monument Record (3) (a) (b) (c) (d) (e) (f) (g) (h) (i). An additional sheet may be added if necessary to conform with said requirements.

(a) Corner location: Township 37 North
 Range 6 East/West
 Town/City/Village Cassian
 County Oneida

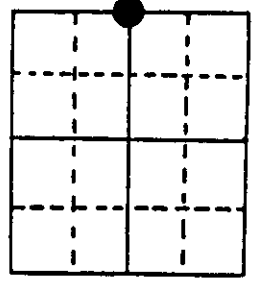

Section 7

(b) (f) (g) (h) Description of monument found at this corner and if it was accepted, state all evidence (material, testimonial, occupational, plats, records, other monuments) used as a basis for accepting. If not accepted or if nothing was found, state evidence used as basis for establishing location. If reestablished through lost corner proportionate methods, indicate all monuments, distances and directions used to establish. Indicate type of monument found or set and sign post.

- 1863 - Joseph H. Jenkins established this corner at 35.00 chains and set wood post/2 BTs:
 6" Black Pine, N26°E, 20 Links (13.20') 5" Black Pine, S10°W, 5 Links (3.30')
- 10/12/1937 - V. Maine restored this corner by Lost Methods and set an official monument with 3 BTs:
 2 1/2" White Pine, S10°E, 26.2 Links (17.292')
 2 1/2" White Pine, S60°W, 10 Links (6.60')
 2 1/2" Red Pine, N24°W, 11 Links (7.26')
- 10/25/1995 - Milo E. Stefan found Maine's monument with his BTs in excellent condition. We made one new BT and set plastic sign post.

(c) (d) (e) Plan view of corner with ties to at least 4 witness monuments. If in disagreement with previously established corner, show the distances between the two corners and also indicate the ties to the disputed corner.

- 1) 2" x 60" Iron Pipe/Brass Cap.
- 2) 12" Red Pine, N52°E, 22.21'.
- 3) 14" White Pine, S10°W, 17.70'.
- 4) 14" White Pine, S60°W, 6.65'.
- 5) 14" Red Pine, N24°W, 7.37'.
- 6) Plastic Sign Post, West, 1.0'.

Distances to nail in side of BTs.
 Stump blaze scribed "BT".
 BT tags placed on face of each BT.

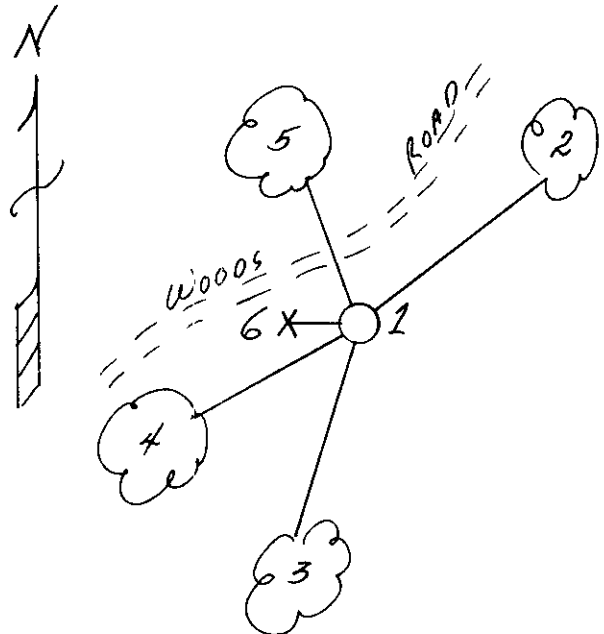

(i) I, Milo E. Stefan
 (type or print name) certify that the corner location on this record was determined by me or under my direction and control and that this U.S. Public Land Survey Monument Record is correct and complete to the best of my knowledge and belief.

Milo E. Stefan December 17, 1995
 Signature Date

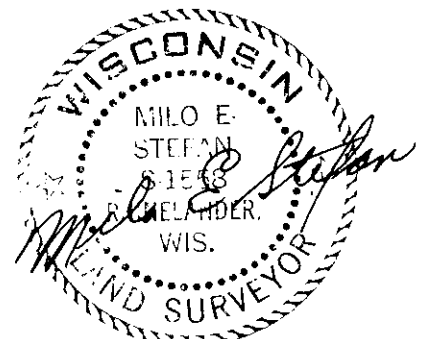

Index No. E-3

Stamp
 3706060020

FEB 23 2016

AT _____ O'CLOCK _____ M
KYLE J. FRANSON
REGISTER OF DEEDS

U.S. PUBLIC LAND SURVEY MONUMENT RECORD

N 1/4 CORNER, SECTION 7 T. 37 N., R. 6 E., TOWN OF Cassian, ONEIDA COUNTY, WISCONSIN.

COUNTY PLANE COORDINATES
(NAD-83/91 Adj.) (NAD-83, WISCORS 2011 Adj. RTK)

NORTH 194051.171 (194051.12)

EAST 168166.977 (168167.00)

SCALE FACTOR _____

THETA ANGLE _____

STATE PLANE COORDINATES

NORTH _____

EAST _____

SCALE FACTOR _____

THETA ANGLE _____

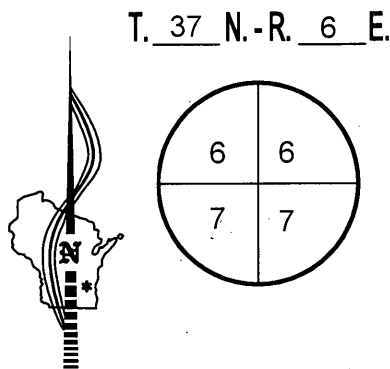
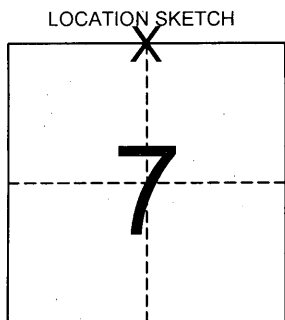

TIE SKETCH

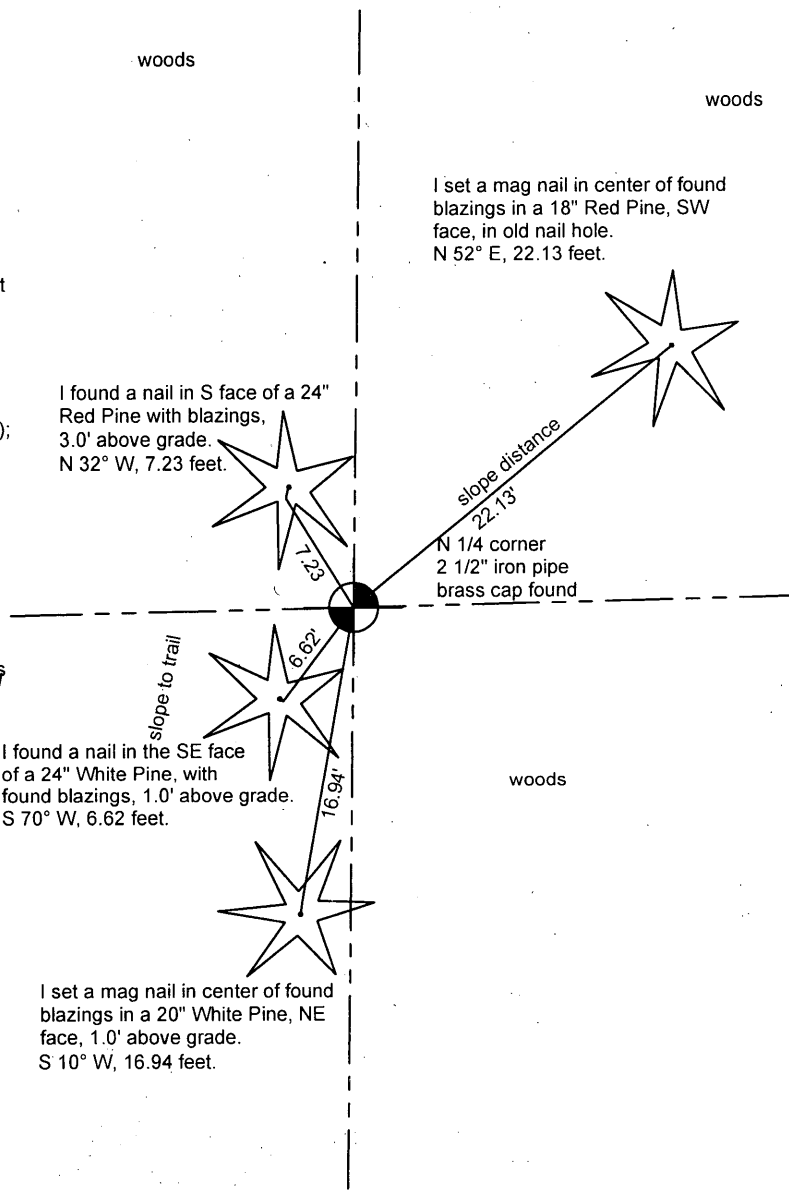

HISTORY

July 6th, 1863, Joseph H. Jenkins established this corner. He set a wood post with two BTs: 6" Black Pine, N26°E, 20 Links (13.20') and 5" Black Pine, S10°W, 5 Links (3.30').

10-12-1937, County Surveyor, V.M. Maine, in Book 1, page 154, says he Set Official N 1/4 Stake 40.758 chains east of the NE corner of Sec. 7, 1.981 chains E. of ravine & marked B.Ts. viz: W.P. 2 1/2" S10°E, 262 Links (172.92'); Y.P. 2 1/2" N 24°W, 11 Links (7.26'); W.P. 2 1/2" S60°W, 10 Links (6.60'). 1937 - Maine did not say what was set, I assume he set a 2" x 60" iron pipe/brass cap.

1957, Owen-Illinois section sheet shows nothing.

12-17-1995, Milo E Stefan, S-1558, found Maine's monument with his BTs in excellent condition. Set one new BT and set plastic sign post.

04-17-2015 Donald J. Thoma, S - 2470, I found a 2 1/2" iron pipe with a brass cap, tall, in good condition. I accepted the monument and took ties.

Survey # S-2470 *May 27, 2015*

Firm (Surveyor) Accurate Surveying & Engineering, LLP.

(Address) 2911 Wildlife Lane
Richfield, WI 53076

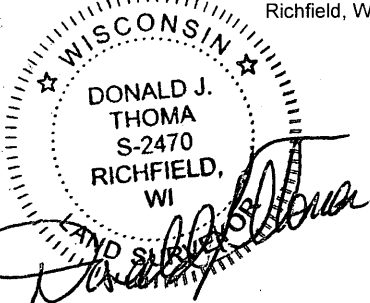

trail

gate

RECEIVED FOR RECORD

DATE

REVISIONS

COUNTY KEY NUMBER

SIGNED _____
ONEIDA COUNTY SURVEYOR

3706060020

SIGNED _____
ONEIDA COUNTY SURVEYOR

USFS KEY NUMBER

E 3