

U.S. PUBLIC LAND SURVEY MONUMENT LOCATION RECORD

Recorders Data

CORNER: West 1/4 SECTION: 7 TOWNSHIP 37 NORTH RANGE 7 EAST WEST

FOR M.C. CORNER INDICATE: NAME OF WATERWAY N/A SECTION LINE N/A

(CITY)(VILLAGE)(TOWN) OF: Cassian COUNTY OF: Oneida

Description of monument found or placed and all other evidence used as a basis for monument location; including all monuments and related measurements required if the corner location is reestablished by lost corner proportionate methods. Also indicate name of original surveyor, survey date, corner monument set and established bearing trees, witness or reference monuments with ties from available records.

Found and accepted an old 2" dia. iron pipe monument with stamped brass cap set in 1937 at this corner location per cap date. I carefully removed the 36" high iron pipe which was 60" long, and reset the corner location with a standard 2" dia. by 30" long aluminum pipe survey corner monument with stamped Oneida County cap flush with existing grade; I left the older monument flat on grade along East side of new monument. The corner falls 19.7' East of the East edge of existing North/South roadway pavement and 1' North of an existing underground telephone cable handhole box No. 1W470. I also found a standard white poly 'T' corner post marker 1' West of the corner, which I reset 7" East of new monument set.

In 1860, Millard/GLO set a wood post as the original 1/4 corner and marked OBTs, a 16" Aspen N18°E 20 lks and a 16" B. Oak S45°W 32 lks, all of which are now obliterated.

In 1997, W. Bandow/Genisot & Associates, Inc. also found and accepted the older brass capped iron pipe monument at this corner location, per his Plat of Survey filed as C-1374 in Oneida County survey records, and apparantly also marked the older BTs that I found flagged and spiked, which I used for new ties below.

This recovery completed July 9, 1998; there were no witnesses other than vehicular drive-bys.

Plan view map of monument location with bearing and distance ties to a minimum of four(4) described witness or reference monuments of concrete, natural stone, iron, live bearing trees or equivalent material. If applicable, also show a minimum of two(2) bearing and distance ties to any other monument found and not accepted; including the bearing and distance from the accepted monument. Indicate the basis for bearings of reference ties if not referenced to magnetic north.

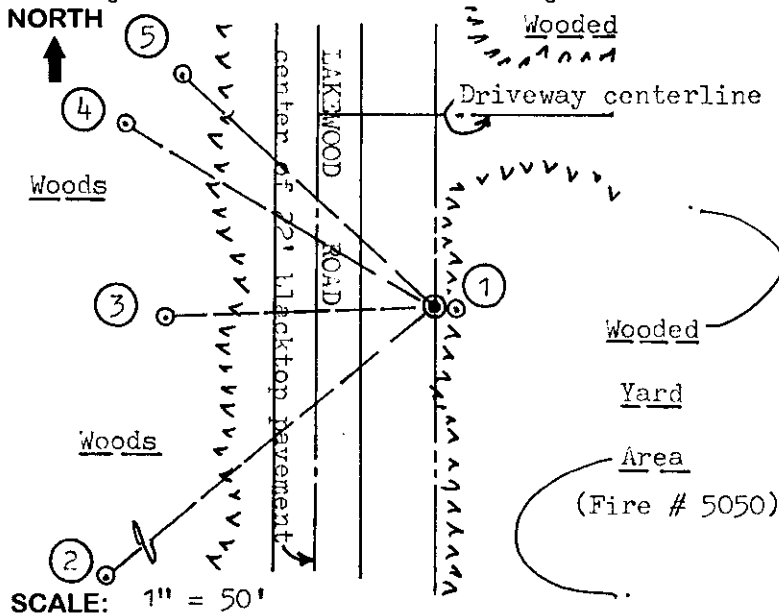

WITNESS MONUMENT TIES:

- ① New BT 7" Spruce S80°E 5.70'.
- ② Older BT 23" Pr 350°W 123.90' with lower face blaze at root crown shut but fissure plain.
- ③ Older BT 11" Aspen S87°W 70.90'.
- ④ New BT 10" Mr N60°W 93.90'.
- ⑤ Older BT 10" Or N48°W 89.00'.

Note: I did not use rusting 60d spikes found in left/right face of older BTs at root crown as tie points in lieu of my standard PK nail with washer.

Unless otherwise indicated, all bearing tree ties are to a .25" dia. by 2.5" long PK nail with a 1.25" dia. steel washer driven into unblazed right face and a .25" dia. by 2.5" long PK nail with a 2" dia. steel washer stamped 'BT' is also driven into unblazed face of bearing tree at DBH; the basis for measured bearings is magnetic to nearest degree and all tie distances are horizontal measure to nearest 1/100th feet.

LAND SURVEYOR CERTIFICATION:

I, William C. Rohde, hereby certify that I am a duly licensed Professional Land Surveyor in Wisconsin, that this USPLS monument location was determined by me or under my direction and control, and that this U.S. Public Land Survey Monument Location Record is true and correct to the best of my knowledge and belief.

William C. Rohde Date: 7-13-98
Signature

This form is intended to fulfill requirements of Chapter A-E 7.08 (3)(a)(b)(c)(d)(e)(f)(g)(h)(i) U.S. Public Land Survey Monument Location Record, Wisconsin Administrative Code. Use reverse side for geodetic location data and/or continuation purposes.

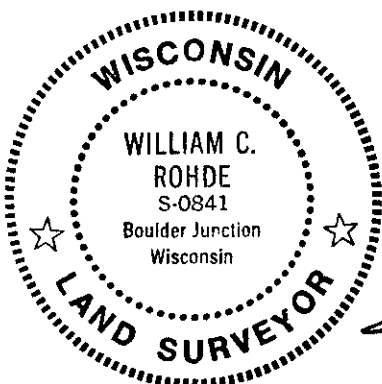

RLS SEAL

SHEET NO. 1 OF 1

SECTION LOCATION MAP

INDEX NO. G 1
3706 12 2000

INDEX NO. G 1