

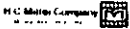

Stock No. 26273



Stock No. 26272

State of Wisconsin

County of Oneida

ss.

I John H. Fisher, do hereby certify that on the 6th day of October 19 83, I found evidence of the Southwest corner of Section 18 Township 37 North, Range 7 East, Fourth Principal Meridian,

as described hereon; and that from this evidence I established a new monument and accessories as described hereon to perpetuate the original location of this corner.

Resident witnesses:

None

CERTIFIED LAND CORNER RESTORATION
U. S. PUBLIC LAND SURVEY MONUMENT RECORD

Index No. N-1

History of original corner establishment:

The original Government survey was performed by Alfred Millard, Deputy Surveyor, August 8, 1860.

Set Wood Post:

Yellow Pine	12"	N70°W	20 links
Yellow Pine	12"	N62°E	9 links
White Pine	12"	S50°E	30 links

Description of corner evidence found:

1-1/2" iron pipe with brass tablet found in place

Description of monument and accessories I established to perpetuate the original location of this corner.

Corner in good condition

Set nail in new bearing trees

Popple	9"	N 9° E	9.70 feet
Popple	5"	N40° W	24.46 feet
Popple	8"	S66° W	17.12 feet
Popple	5"	S26° W	13.55 feet

Dated at Minocqua

Wis., this 26th

day of August, 1987.

Signature

John H. Fisher

Title Registered Land Surveyor Registration No. S-836

(County Surveyor, Registered Land Surveyor, or other duly authorized official)

Office of Register of Deeds, County of Oneida, I hereby certify that the within instrument was filed in this office for record on the 19th day of August, 1987, at 10 o'clock A.M.

(Register of Deeds)

By

Deputy

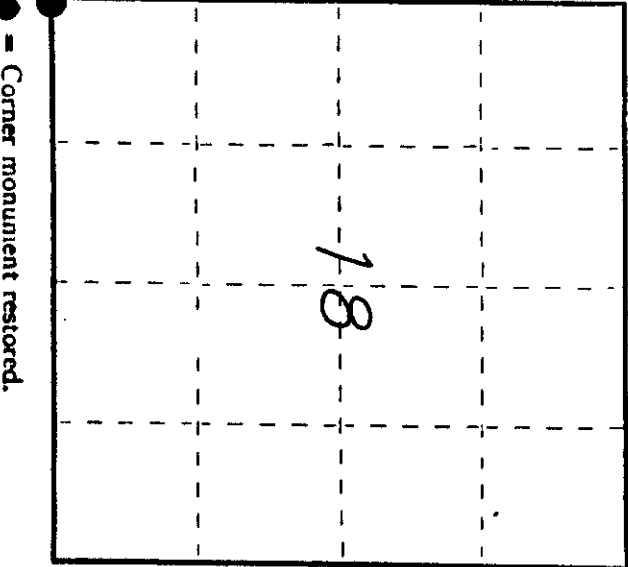

● - Corner monument restored.

3706/30000

(e) Describe any material discrepancy between the location of the corner as restored or reestablished and the location of that corner as previously restored or reestablished by distance and direction. Show the discrepancy on the plan view drawing under (d), above. Show the distances between the corner as previously restored or reestablished and (1) the corner as restored or reestablished, and (2) to at least 2 of the witness monuments shown on the drawing in (d), above.

See sketch below

(f) Was the corner restored through acceptance of (1) an obliterated evidence location, or, (2) a found perpetuated location?

Found perpetuated

(g&h) Was the corner reestablished through lost corner proportionate methods? If so, show the method, including the directions and distances to other public land survey corners used as evidence or used for proportioning in determining the corner location?

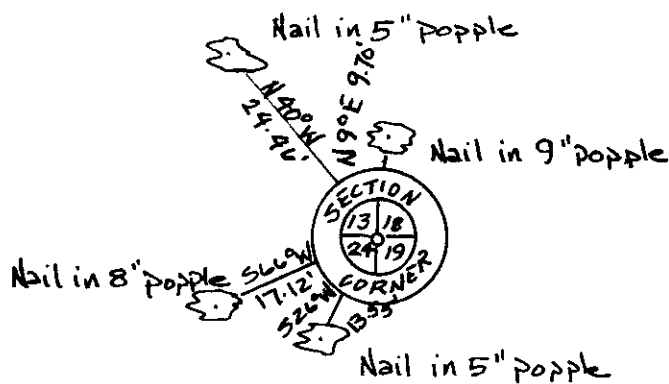

REGISTER OF DEEDS OFFICE
ONEIDA COUNTY, WIS.

FILED
JUL 11 1986
At 8:00 O'Clock A.M.
DORIS VERAGE KUEHN
REGISTER OF DEEDS

(i) I, John H. Fisher
(type or print name) certify that the corner location shown on this record was determined by me or under my direction and control and that this U.S. Public Land Survey Monument Record is correct and complete to the best of my knowledge and belief.

John H. Fisher
Signature

8/20/84
Date

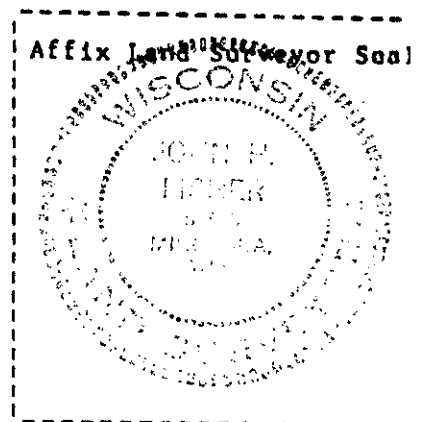



Stock No. 26273

U.S. PUBLIC LAND SURVEY MONUMENT RECORD

Index No. N 1

State of Wisconsin } ss. County of Oneida

I, John H. Fisher, do hereby certify that on the 6th day of September, 1983, I found evidence of the Southwest corner of Section 18 Township 7 East, Range 7 East, Fourth Principal Meridian, as described hereon; and that from this evidence I established a new monument and accessories as described hereon to perpetuate the original location of this corner.

Resident witnesses:

None

History of original corner establishment:

The original Government survey was performed by Alfred Willard in August, 1960.

Wood post set:

- Yellow Pine 12" N70°W 2 lks.
Yellow pine 12" N62°E 9 lks.
White pine 12" S50°E 30 lks.

Description of corner evidence found: Brass tablet on 1-1/2" iron pipe and square wood post

Description of monument and accessories I established to perpetuate the original location of this corner.

Corner in good condition
Set nails in new bearing trees:

Table with 3 columns: Tree type, Height, Bearing. Includes Popple 9", 5", 8", 5" and bearings like N9°E, N40°W, S66°W, S26°W.

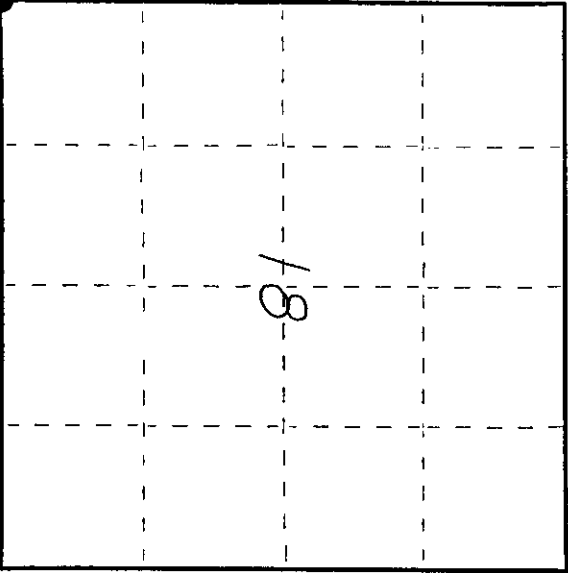

Dated at Minocqua, Wis., this 9th day of May, 1985

Signature: [Handwritten Signature] Title: Registered Land Surveyor Registration No. S-836

Office of Register of Deeds, County of Oneida. I hereby certify that the within instrument was filed in this office for record on the 11th day of June, 1986 at 10:09:00'clock A.M.

By: [Handwritten Signature] Deputy

3706130000

