

U.S. PUBLIC LAND SURVEY MONUMENT LOCATION RECORD

Recorders Data

CORNER: West 1/4 SECTION: 36 TOWNSHIP 37 NORTH RANGE 6 ~~EAST~~

FOR M.C. CORNER INDICATE: NAME OF WATERWAY N/A SECTION LINE N/A

(CITY)(VILLAGE)(TOWN) OF: Cassian COUNTY OF: Oneida

Description of monument found or placed and all other evidence used as a basis for monument location; including all monuments and related measurements required if the corner location is reestablished by lost corner proportionate methods. Also indicate name of original surveyor, survey date, corner monument set and established bearing trees, witness or reference monuments with ties from available records.

Found and accepted an undisturbed 2" dia. iron pipe monument with uncapped top 5" below the existing roadway surface at this corner location. In 1863, Jenkins/GLO set a wood post as the corner and marked OBTS, a 20" Py S17°E 15 lks and an 8" Py S50°W 13 lks, which are all now obliterated. In 1977, Schmidt of Timberland Surveyors noted and accepted a 2" iron pipe at this corner per his Plat of Survey No. 202 filed in Oneida County Survey Records; no BTs were noted on the plat of survey. In 1988, Seymour/DNR also found and accepted a 2" dia. iron pipe at this corner location on centerline of existing North/South road and South edge of existing road to the East, and noted new BTs: 18" Bw(triple) N33°W 33.26', now down flat to SW; a 7" Aspen S34°W 51.30', now a 12" S36°W with upper and lower face blazes open and plain; a 12" Pr S48°E 118.25', now a 15" S47°E with upper face blaze shut but plain and the lower face blaze open; and a 12" Pr S64°E 118.75', now a low cut 14" stump. This recovery was completed May 6, 1998; there were no witnesses other than vehicular traffic.

Note: A 3/8" dia. iron rod was also found as a center point in the 2" dia. iron pipe corner monument found.

Plan view map of monument location with bearing and distance ties to a minimum of four(4) described witness or reference monuments of concrete, natural stone, iron, live bearing trees or equivalent material. If applicable, also show a minimum of two(2) bearing and distance ties to any other monument found and not accepted; including the bearing and distance from the accepted monument. Indicate the basis for bearings of reference ties if not referenced to magnetic north.

NORTH

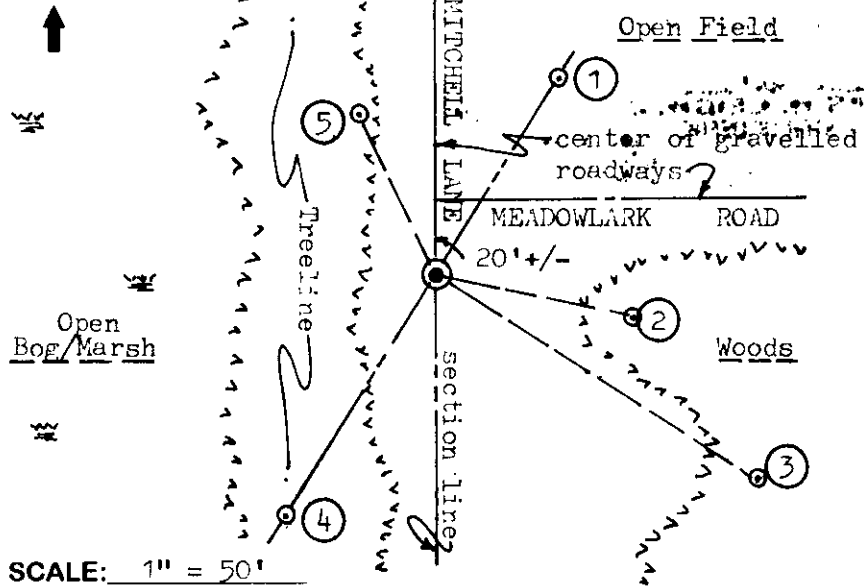

WITNESS MONUMENT TIES:

- ① 1" dia. by 24" long iron pipe set with standard Reference Mark plug cap in top N32°E 60.03' and also S32°W 74.00' on a right line thru corner monument center.
- ② New BT 5 1/2" Pr S78°E 52.25'.
- ③ New BT 12" Pr S58°E 99.00' with a No Trespass sign on west face.
- ⑤ New BT 11" Aspen N26°W 45.93'.

Note: I set a standard white poly 'T' marker post 5" West of Witness monument No. 4.

SCALE: 1" = 50'

Unless otherwise indicated, all bearing tree ties are to a .25" dia. by 2.5" long PK nail with a 1.25" dia. steel washer driven into unblazed right face and a .25" dia. by 2.5" long PK nail with a 2" dia. steel washer stamped 'BT' is also driven into unblazed face of bearing tree at DBH; the basis for measured bearings is magnetic to nearest degree and all tie distances are horizontal measure to nearest 1/100th feet.

LAND SURVEYOR CERTIFICATION:

I, William C. Rohde, hereby certify that I am a duly licensed Professional Land Surveyor in Wisconsin, that this USPLS monument location was determined by me or under my direction and control, and that this U.S. Public Land Survey Monument Location Record is true and correct to the best of my knowledge and belief.

William C. Rohde Date: 5-16-98
Signature

		36	

INDEX NO.

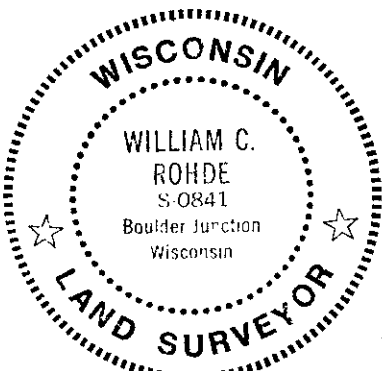

RLS SEAL

SHEET NO. 1 OF 1

This form is intended to fulfill requirements of Chapter A-E 7.08 (3)(a)(b)(c)(d)(e)(f)(g)(h)(i) U.S. Public Land Survey Monument Location Record, Wisconsin Administrative Code. Use reverse side for geodetic location data and/or continuation purposes.

SECTION LOCATION MAP

INDEX NO. X 21
3906352000