

U.S. PUBLIC LAND SURVEY MONUMENT RECORD

Note: This form is intended and designed to fulfill all requirements of Wisconsin Administrative Code, Chapter A-E 7.08 U.S. Public Land Survey Monument Record (3)(a)(b)(c)(d)(e)(f)(g)(h)(i). An additional sheet may be added if necessary to conform with said requirements.

(a) CORNER LOCATION: State Plane Coordinates
 CN 1/16 corner of Sec. 2 X _____
 Township 37 North Y _____
 Range 7 East Datum Base _____
 Town/~~XXX~~ Lake Tomahawk County of Oneida

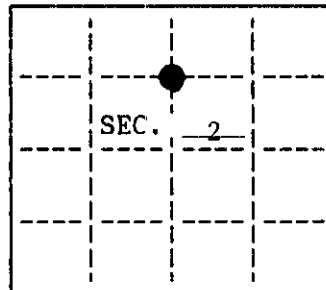

(b) HISTORY OF ORIGINAL CORNER ESTABLISHMENT Original B.T.'S
 Original Surveyor: Unknown
 Date of Survey: Commenced _____
 Completed _____

(b)(f)(g)(h) Description of monument found at this corner and if it was accepted, state all evidence (material, testimonial, occupational, plats, records, other monuments) used as a basis for accepting. If not accepted or if nothing was found, state evidence used as basis for establishing location. If reestablished through lost corner proportionate methods, indicate all monuments, distances and directions used to establish. Indicate type of monument and sign post found or set.

June, 1993: I set a 72" long Oneida County Aluminum monument single proportionate measure between the center $\frac{1}{4}$ corner and north $\frac{1}{4}$ corner. This location was previously monumented by a 1-3/4" iron pipe of unknown origin. The monument was set based on the section subdivision shown on Oneida County Surveyor Map No. B2785. I set a plastic sign post and witnessed the corner as shown below.

(c)(d)(e) Plan view of corner with ties to at least 4 witness monuments. If in disagreement with previously established corner, show the distances between the two corners and also indicate the ties to the disputed.

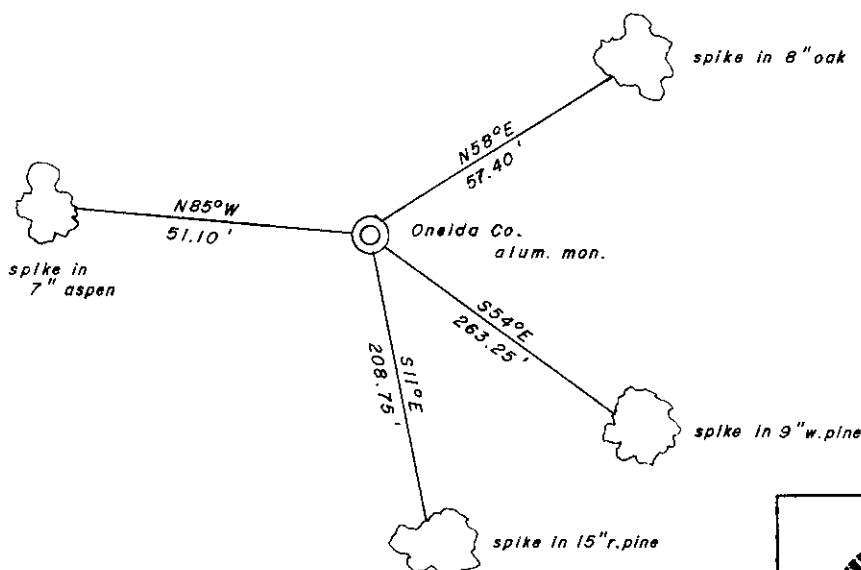

(i) I, Charles E. Winkler, Registered Land Surveyor hereby certify that the corner location on this record was determined by me or under my direction and control and that this U.S. Public Land Survey Monument Record is correct and complete to the best of my knowledge and belief.

Charles E. Winkler 9/17/1993
 Signature Inman-Foltz & Associates Date

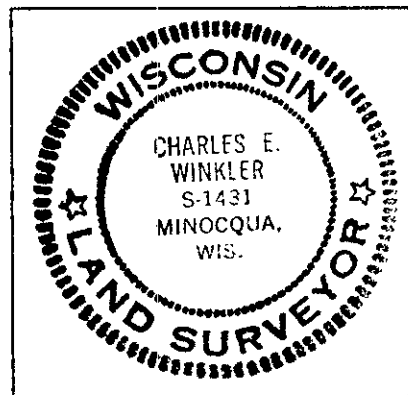

INDEX NO. B-19

3707023020