

U.S. PUBLIC LAND SURVEY MONUMENT RECORD

Note: This form is intended and designed to fulfill all requirements of Wisconsin Administrative Code, Chapter A-8 7.08 U.S. Public Land Survey Monument Record (3)(a)(b)(c)(d)(e)(f)(g)(h)(i). An additional sheet may be added if necessary to conform with said requirements.

(a) CORNER LOCATION: State Plane Coordinates
Meander corner of Sec. 9 X _____
 Township 37 North Y _____
 Range 7 East Datum Base _____
 Town/~~City~~ Cassian County of Oneida

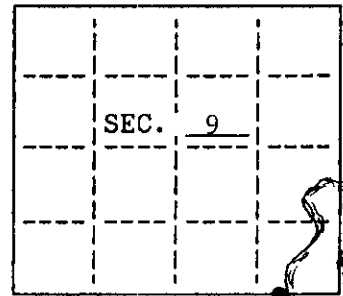

(b) HISTORY OF ORIGINAL CORNER ESTABLISHMENT
 Original Surveyor: J.H. Jenkins Original B.T.'s
 Date of Survey: Commenced 1862 Birch 10" N47°E, 15 lks
 Completed 1862 Birch 8" S37°E, 12 lks

Cor ID
 43701690008

(b)(f)(g)(h) Description of monument found at this corner and if it was accepted, state all evidence (material, testimonial, occupational, plats, records, other monuments) used as a basis for accepting. If not accepted or if nothing was found, state evidence used as basis for establishing location. If reestablished through lost corner proportionate methods, indicate all monuments, distances and directions used to establish. Indicate type of monument and sign post found or set.

- 1862 - Deputy Surveyor, J.H. Jenkins set Meander post.
- 1936 - Vernon Maine did not find any evidence of original meander corner. He established position for Section corner common to 9, 10, 15 and 16 in lake. He set M.C. on line between Section corner and S $\frac{1}{4}$, Section 9. He made two B.T.'s: Hemlock 6" S61°W, 8 $\frac{1}{2}$ lks, White Pine 16" due north 31 $\frac{1}{2}$ lks.
- 1996 - I found a 1 $\frac{1}{2}$ " iron pipe for meander corner and Maine's existing blazed B.T.'s. I replaced pipe with an Oneida County aluminum monument.

(c)(d)(e) Plan view of corner with ties to at least 4 witness monuments. If in disagreement with previously established corner, show the distances between the two corners and also indicate the ties to the disputed.

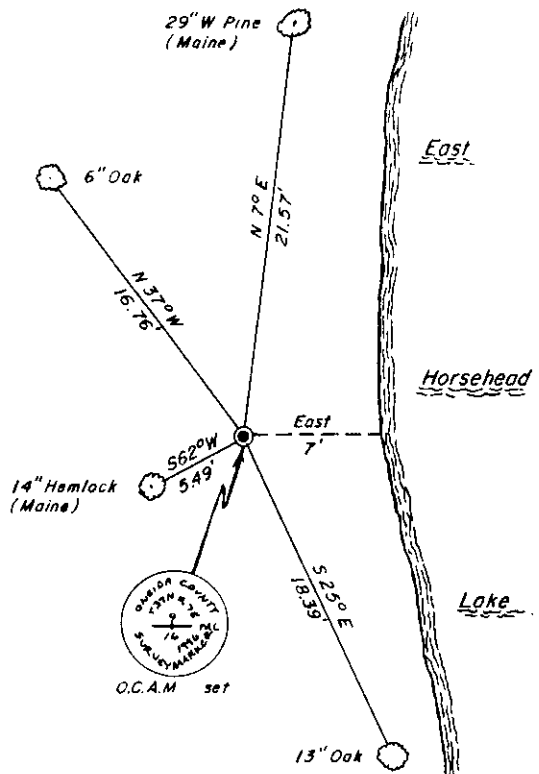

- Replaced 1-1/2" Iron pipe found with an Oneida County Aluminum Monument.
- Set plastic sign post #1 North.
- Set P.K. nails in each B.T.

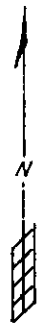

REGISTER OF DEEDS OFFICE
 ONEIDA COUNTY, WIS.
 FEB 16 1998
 At _____ O'Clock _____ M
 THOMAS H. LEIGHTON
 REGISTER OF DEEDS

WISCONSIN
 CHARLES E. WINKLER
 S-1431
 MINOCQUA, WIS.
 LAND SURVEYOR

(i) I, Charles E. Winkler, #S1431 hereby certify that the corner location on this record was determined by me or under my direction and control and that this U.S. Public Land Survey Monument Record is correct and complete to the best of my knowledge and belief.

Charles E. Winkler / 1/21/98
 Signature Poltz and Associates, Inc. Date

INDEX NO. J 12-13

3707090008