

U. S. PUBLIC LAND SURVEY MONUMENT RECORD

**INSTRUCTIONS:** This record shall show the location of the corner and shall include all of the following nine elements (a through i)

(A) Identify the corner by reference to the U.S. public land survey system.  
Southeast corner of Section 10, T37N, R7E, 4th Principal Meridian, Oneida County, Wisconsin

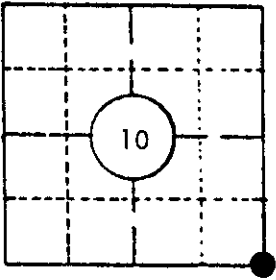

LOCATION SKETCH  
Location of landmark indicated by "●"

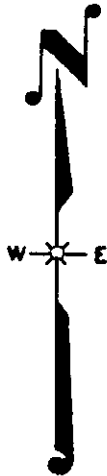

Original corner a wood post was established in the course of subdivision of Township 37 North of Range 7 East of 4th Principal Meridian, Wisconsin. Commenced November 3rd, 1862. Finished November 15th, 1862 by Joseph H. Jenkins, Government Deputy Surveyor.

Original Bearing Trees:

- 7" Birch N35°E 20 links
- 7" White Pine N44°W 35 links
- 8" Birch S17°E 32 links
- 6" White Pine S86°W 20 links

(b) Describe any record evidence, monument evidence, occupational evidence, testimonial evidence or any other material evidence you considered, and whether the monument was found or placed.

D. H. Vaughan's survey of June 24, 1911 finds original trees and post set by Billy Allen. Maine identifies both original B.T.s down but marks plain and sets official iron pipe with brass cap stamped and made new B.T.s.

I find 2" diameter galvanized iron pipe protruding up 30" above ground level with a brass cap stamped to identify corner.

(c) In the plan view drawing below, provide reference ties to at least 4 witness monuments, or, if the location is within a municipality, to at least 2 witness monuments. (Witness monuments shall be made of concrete, natural stone, iron or other equally durable material, Bearing trees O.K. Describe witness monuments.

(d) Show a plan view drawing depicting the relevant monuments and reference ties which is sufficient in detail to enable accurate relocation of the corner monument if the corner monument is disturbed. Indicate north.

June 5th, 1984 I record the following:  
Distances measured to aluminum nail set in side of tree.

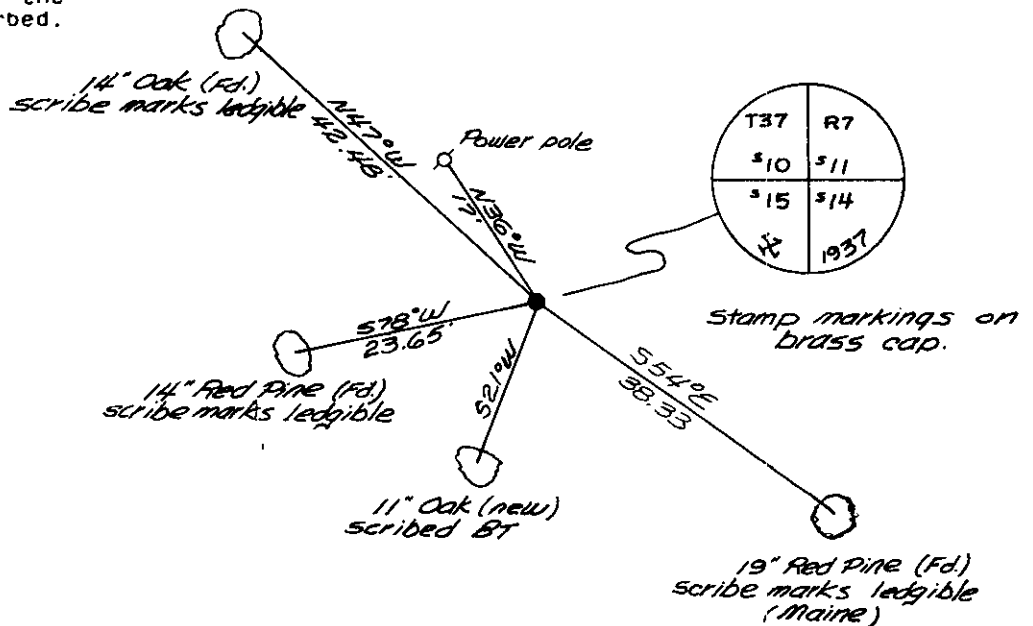

37c 7100000

5-17

(e) Describe any material discrepancy between the location of the corner as restored or reestablished and the location of that corner as previously restored or reestablished by distance and direction. Show the discrepancy on the plan view drawing under (d), above. Show the distances between the corner as previously restored or reestablished and (1) the corner as restored or reestablished, and (2) to at least 2 of the witness monuments shown on the drawing in (d), above.

None, to the best of my knowledge and belief.

(f) Was the corner restored through acceptance of (1) an obliterated evidence location, or, (2) a found perpetuated location?

Corner was perpetuated from original bearing trees by earlier surveys.

(g) Was the corner reestablished through lost corner proportionate methods? If so, show the method, including the directions and distances to other public land survey corners used as evidence or used for proportioning in determining the corner location?

No.



REGISTER OF DEEDS OFFICE  
ONEIDA COUNTY, WIS.  
**FILED**  
JUN 11 1986  
At 10:02 O'Clock A.M.  
DORIS VERAGE KUEHN  
REGISTER OF DEEDS

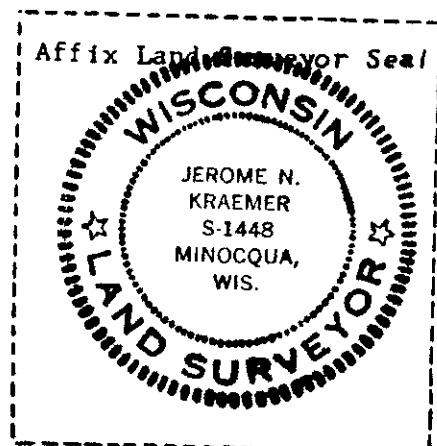

i) I, JEROME N. KRAEMER  
(type or print name) certify that the corner location shown on this record was determined by me or under my direction and control and that this U.S. Public Land Survey Monument Record is correct and complete to the best of my knowledge and belief.

Jerome N. Kraemer June 22nd, 1984  
Signature Date

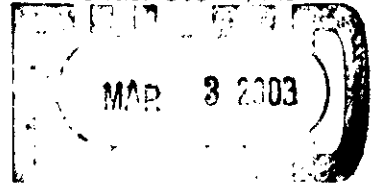

This form is intended to fulfill the requirements of Chapter A-E 7.08 (3)(a) thru (i) U.S. Public Land Survey Monument Location Record, Wisconsin Administrative Code. Use the reverse side of form for continuation.

**U.S. PUBLIC LAND SURVEY MONUMENT LOCATION RECORD**

USPLS CORNER: NW SECTION CORNER SECTION: 14 TOWNSHIP: 37 NORTH RANGE: 7 EAST

NAME OF WATERWAY FOR M.C. CORNER : N/A SECTION LINE: N/A

~~(CITY)(VILLAGE)(TOWN)~~ OF: CASSIAN COUNTY OF: ONEIDA

Description of monument found or placed and all other evidence used as the basis for monument location; including monuments and related measurements required if the corner location was reestablished by lost corner proportionate methods. Also indicate name of original surveyor, original survey date and the corner monument, bearing trees, witness or other reference monuments established; including measured bearing and distance ties, from available records.

**THIS CORNER WAS RE-REFERENCED WITH THE VERBAL APPROVAL OF ONEIDA COUNTY SURVEYOR MICHAEL J. ROMPORTL, AS REMAINING REFERENCES CONSIDERED INADEQUATE FOR FUTURE RECOVERY PURPOSES.**

This corner was last referenced for record by Jerome N. Kraemer/RLS 1448 per U.S. Public Land Survey Monument Location Record filed June 11, 1986 in Oneida County records, which should be referred to for historical documentation.

Only two record BTs were found acceptable and used to verify record brass capped 2" dia. iron pipe monument found 32" up and tipped 6" West of center of iron pipe at grade; iron pipe was very stable in a cairn of large rocks below grade, so I did not replumb and measured new ties to center of brass cap; which checked within reason to record tie distances.

Old 14" Oak BT NW is now a 16" Oak 20' tall dead stub; Lower face blaze of old SW Pr BT by Kraemer is 6 or more feet below grade at corner monument so of impractical reference usage; however, I used it for new ties. I also found and used an old unrecorded 11" Pr BT, not noted by Kraemer, with plain upper & lower blaze scars NW of the corner for new ties; Maines old Pr BT SE of the corner also used for new ties.

I set a standard white poly 'T' post 3" East of corner monument, which is S45°W 30'+- from SW corner of large open field at Fire No. 7874 Pike Road.

This recovery completed October 3, 2002; there were no direct witnesses.

Plan view map of monument location with bearing and distance ties to a minimum of four(4) described witness or reference monuments of concrete, natural stone, iron, live bearing trees or equivalent material. If applicable, also show a minimum of two(2) bearing and distance ties to any other monument found and not accepted; including the bearing and distance from the accepted monument.

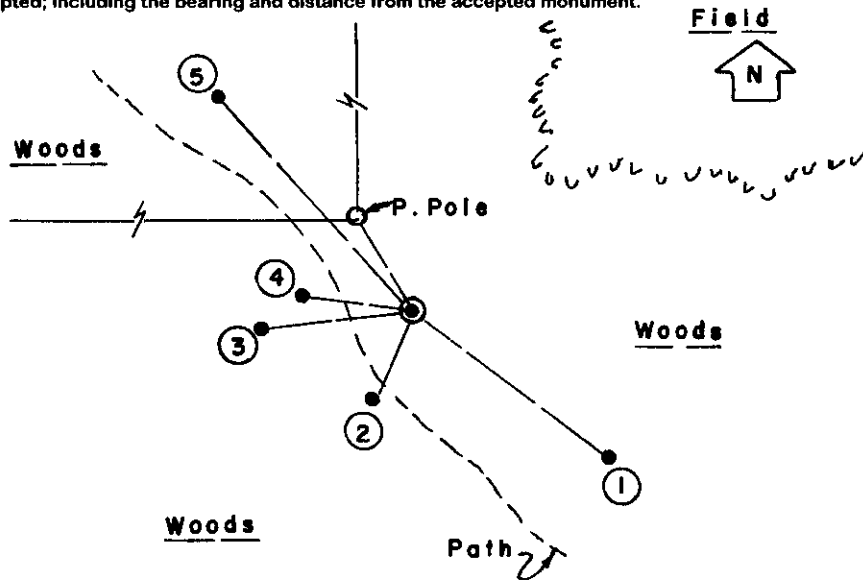

**WITNESS MONUMENT TIES:**

- ① Old 20" Pr BT with lower blaze nearly shut S53°E 37.96'.
- ② Old BT 12" Oak with upper & lower face blazes shut S24°W15.28'.
- ③ Old 11" Pr BT with upper & lower face blazes shut S84°W23.47'.
- ④ Old unrecorded 11" Pr BT with upper & lower face blazes shut N82°W 17.23'.
- ⑤ New 8" Oak BT N42°W 44.98'.

Face of a power pole is N31°W 16.6'.  
New ties are to my standard PK nail/washer set in right BT face for horizontal measure.

SCALE: 1" = 30'

Unless otherwise indicated, all bearing tree ties are to a .25" dia. by 2.5" long PK nail with a 1.25" dia. steel washer driven into unblazed right face and a .25" dia. by 2.5" long PK nail with a 2" dia. steel washer stamped BT is also driven into unblazed face of bearing tree at DBH; the basis for measured bearings is by compass to nearest degree and all tie distances are measured horizontal by steel tape corrected to nearest 1/100th feet at standard temperature of 68° F.

RLS SEAL:



LAND SURVEYOR CERTIFICATE:

I, William C. Rohde, hereby certify that I am duly licensed as a Professional Land Surveyor in the State of Wisconsin; that this USPLS monument location was determined by me and/or under my direct supervision and control; and that this U.S. Public Land Survey Monument Location Record is true and correct to the best of my knowledge and belief.

Signed: *William C. Rohde*  
William C. Rohde RLS 841

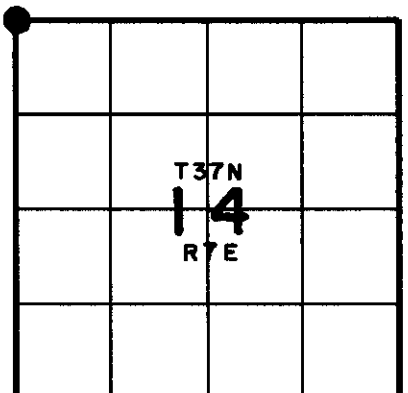

SECTION LOCATION MAP

INDEX NO. J 17