

# U.S. PUBLIC LAND SURVEY MONUMENT RECORD

Note: This form is intended and designed to fulfill all requirements of Wisconsin Administrative Code, Chapter A-E 7.08 U.S. Public Land Survey Monument Record (3) (a) (b) (c) (d) (e) (f) (g) (h) (i). An additional sheet may be added if necessary to conform with said requirements.

(a) Corner location: Township 37 North  
 Range 7 East/West

Town/City/Village Cassian  
 County Oneida

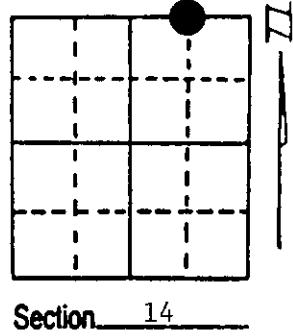

(b) (f) (g) (h) Description of monument found at this corner and if it was accepted, state all evidence (material, testimonial, occupational, plats, records, other monuments) used as a basis for accepting. If not accepted or if nothing was found, state evidence used as basis for establishing location. If reestablished through lost corner proportionate methods, indicate all monuments, distances and directions used to establish. Indicate type of monument found or set and sign post.

9/26/1939 - Vern Maine established this corner and set a stake with two BTs:  
 12" White Pine, N86°E, 89¼ Links (58.90')  
 8" Red Pine, N66°W, 54½ Links (35.97')

6/5/1996 - Milo E. Stefan found 18" White Pine Stub 12'/BT blaze and scribe plain. Red Pine BT has been removed for construction of road. Stump hole on West shoulder of road.

We placed an aluminum monument 4" below road surface, made new BTs and placed a plastic sign post along side of location poster on East side of road.

(c) (d) (e) Plan view of corner with ties to at least 4 witness monuments. If in disagreement with previously established corner, show the distances between the two corners and also indicate the ties to the disputed corner.

- 1) 2" x 30" Aluminum monument.
- 2) 8" Red Maple, N33°E, 26.35'.
- 3) 10" Red Oak, S68°E, 57.21'.
- 4) 18" Red Pine, S76°W, 86.71'.
- 5) 18" White Pine Stub, S89°E, 58.9'.
- 6) 6" x 5' location poster post, East, 10.8' with plastic sign post along side.

Distances from nail in side of BTs  
 Stump blaze scribed "BT"  
 BT tags on face of each BT

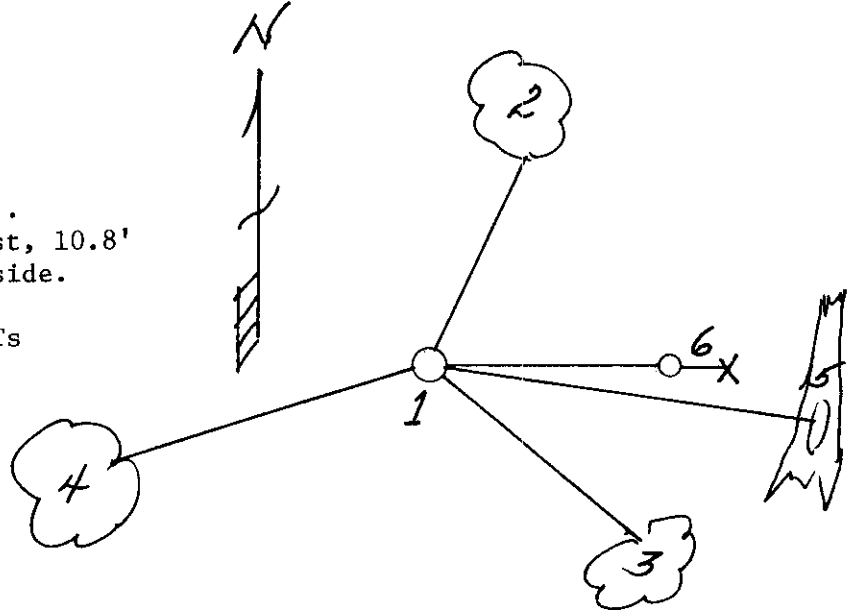

(i) I, Milo E. Stefan  
 (type or print name) certify that the corner location on this record was determined by me or under my direction and control and that this U.S. Public Land Survey Monument Record is correct and complete to the best of my knowledge and belief.

Milo E. Stefan  
 Signature

June 19, 1996  
 Date



Stamp  
 3707110010

This form is intended to fulfill the requirements of Chapter A-E 7.08 (3)(a) thru (i) U.S. Public Land Survey Monument Location Record, Wisconsin Administrative Code. Use the reverse side of form for continuation.

**U.S. PUBLIC LAND SURVEY MONUMENT LOCATION RECORD**

Recorders Data

USPLS CORNER: N1/16 NE SECTION: 14 TOWNSHIP: 37 NORTH RANGE: 7 EAST

NAME OF WATERWAY FOR M.C. CORNER : N/A SECTION LINE: N/A

~~(CITY)(VILLAGE)(TOWN)~~ OF: CASSIAN COUNTY OF: ONEIDA

Description of monument found or placed and all other evidence used as the basis for monument location; including monuments and related measurements required if the corner location was reestablished by lost corner proportionate methods. Also indicate name of original surveyor, original survey date and the corner monument, bearing trees, witness or other reference monuments established; including measured bearing and distance ties, from available records.

**THIS FORTY CORNER WAS RECOVERED AND PERPETUATED AT THE REQUEST AND APPROVAL OF ONEIDA COUNTY SURVEYOR MICHAEL ROMPORTL DUE TO PENDING ROADWAY IMPROVEMENTS BY THE TOWN OF CASSIAN.**

Found and accepted an undisturbed 2" dia. aluminum pipe monument with Oneida County cap stamped in 1996 by Milo Stephan, RLS 1558, 4" below grade and 3.5' West of the East edge of existing gravel roadway mat; also found several older BTs, which I have noted for new ties below.

Also found an old 6" dia. wood marker post with older aluminum location tag and a standard white poly 'T' post along the north side of the wood post, N78°E 10.5 feet.

In September 1936, Maine noted an Oak stake buried in shoulder of fire lane, now gone, a 12" Pw N86°E .8925 chains, now and old 20" dia. 12' tall dead stub with open face blaze plain at root crown, and an 8" Py N66°E .545 chains, now gone near west edge of existing graded roadway mat.

This recovery completed on August 17, 1999; there were no direct witnesses other than an occasional vehicle drive-by.

Note: All of my ties are measured to my standard PK nail with washer driven into the unblazed right face of the older BTs found and described below.

Plan view map of monument location with bearing and distance ties to a minimum of four(4) described witness or reference monuments of concrete, natural stone, iron, live bearing trees or equivalent material. If applicable, also show a minimum of two(2) bearing and distance ties to any other monument found and not accepted; including the bearing and distance from the accepted monument.

NORTH



Woods

Woods

Woods

Woods

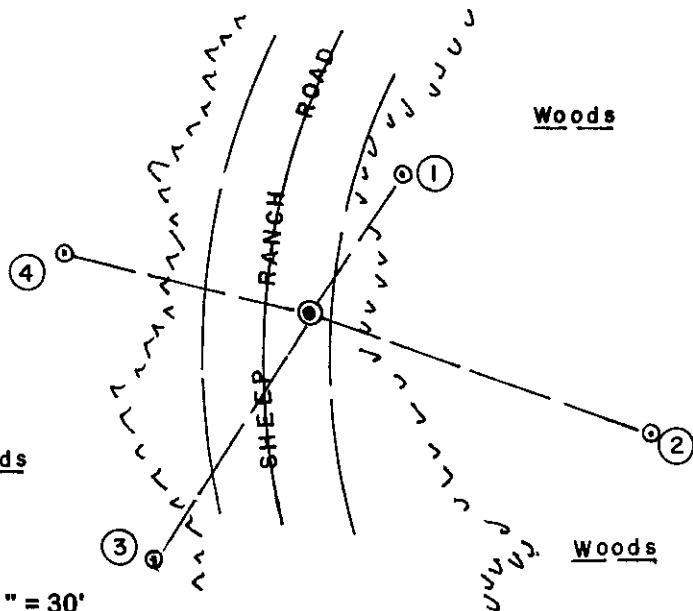

**WITNESS MONUMENT TIES:**

- ① Old BT 10" Mr N34°E 25.98' with U & L blazes open, scribed and blue painted, BT sign on upper face and 40d spike in lower right face.
- ② Old BT 12" Oak S70°E 56.86' with U blaze shut, L blaze open & scribed, both painted blue, BT sign on upper face and 40d spike in lower right face.
- ③ Old BT 12" Oak S33°W 45.70' with U & L blazes open and an older blaze shut which I painted blaze orange.
- ④ Probable old BT South 8" Bw of 3, N77°W 39.78'; U blaze fissure plain with faint blue tree paint.

SCALE: 1" = 30'

Unless otherwise indicated, all bearing tree ties are to a .25" dia. by 2.5" long PK nail with a 1.25" dia. steel washer driven into unblazed right face and a .25" dia. by 2.5" long PK nail with a 2" dia. steel washer stamped BT is also driven into unblazed face of bearing tree at DBH; the basis for measured bearings is by compass to nearest degree and all tie distances are measured horizontal by steel tape corrected to nearest 1/100th feet at standard temperature of 68° F.

RLS SEAL:

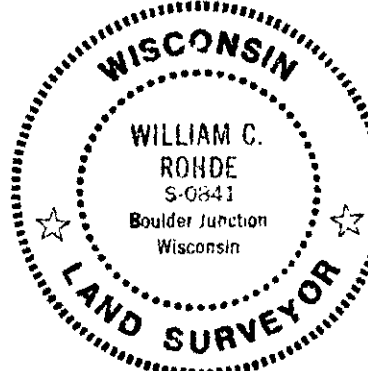

**LAND SURVEYOR CERTIFICATE:**

I, William C. Rohde, hereby certify that I am duly licensed as a Professional Land Surveyor in the State of Wisconsin; that this USPLS monument location was determined by me and/or under my direct supervision and control; and that this U.S. Public Land Survey Monument Location Record is true and correct to the best of my knowledge and belief.

Signed: *William C. Rohde*  
William C. Rohde RLS 841

		T 37N	
		14	
		R 7E	