

# U.S. PUBLIC LAND SURVEY MONUMENT RECORD

Note: This form is intended and designed to fulfill all requirements of Wisconsin Administrative Code, Chapter A-E 5.02, U.S. Public Land Survey Monument Record (3) (a) (b) (c) (d) (e) (f) (g) (h) (i). An additional sheet may be added if necessary to conform with said requirements.

(a) Corner location: Township 37 North

Range 7 East/West

Town/City/Village Cassian

County Oneida

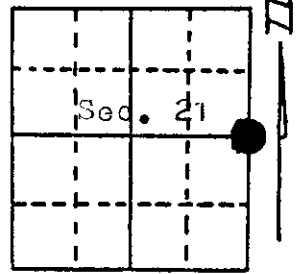

Section 21

(b) (f) (g) (h) Description of monument found at this corner and if it was accepted, state all evidence (material, testimonial, occupational, plats, records, other monuments) used as a basis for accepting. If not accepted or if nothing was found, state evidence used as basis for establishing location. If reestablished through lost corner proportionate methods, indicate all monuments, distances and directions used to establish. Original Survey by Joseph H. Jenkins in 1862.

North between Sec. 21 & 22, See Post: Spruce 8, N73E, 5 lks.  
Spruce 6, N10W, 20 lks. Leave Swamp 1.50 ch. South, Leave Swamp 1.5 ch. North.

V.M. Main on June 17, 1936 found original post and the 2 Spruce Bearing Trees (See Main's Book Pages 129 & 130). Set critical iron pipe with brass Cap Stamped and marked the following new B.T.'s. Tam. 5, S82W, 115 lks. white Pine Stp. 10, S16W, 99 lks. Leave Swamp 0.50 Chs. South.

I found on June 10, 1987 The County Monument set by Mzin and a Tam. 10", S82W, 75.9 ft. scribeing visable.

(c) (d) (e) Plan view of corner with ties to at least 4 witness monuments. If in disagreement with previously established corner, show the distances between the two corners and also indicate the ties to the disputed corner. Blazed and Scribed 4 new Bearing trees and set white witness post 6" NW of Monument. Measured to 8 penny galvanized nail in side of new B.T.'s as indicated on sketch.

Tam. 10", N14W,  
145.02 ft.

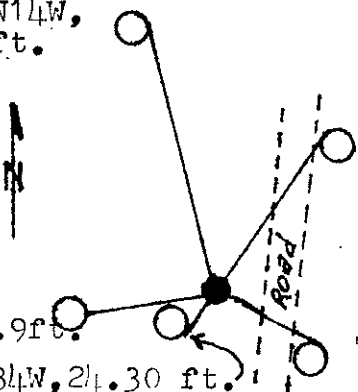

Tam. 4", N34E, 100.80 ft.

Tam. 10",  
S82W, 75.9 ft.

Tam. 4", S34W, 24.30 ft.

Tam. 8", S65E, 59.64 ft.

REGISTER OF DEEDS OFFICE  
ONEIDA COUNTY, WIS.

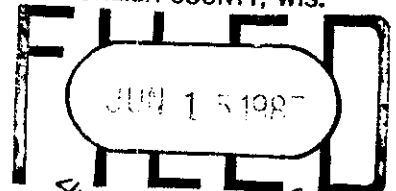

At 8:00 O'Clock M  
DORIS VERAGE KUEHN  
REGISTER OF DEEDS

(i) I, Jean F. Resvick  
(type or print name) certify that the corner location on this record was determined by me or under my direction and control and that this U.S. Public Land Survey Monument Record is correct and complete to the best of my knowledge and belief.

Jean F. Resvick  
Signature

June 11, 1987  
Date

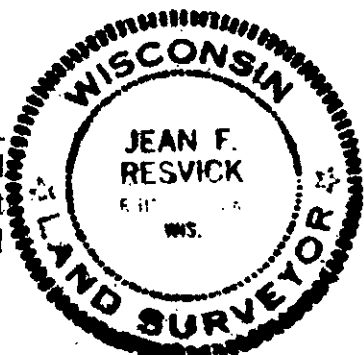

Index No. P-13

3707212000