

U.S. PUBLIC LAND SURVEY MONUMENT LOCATION RECORD

Recorders Data

CORNER: N1/16NW SECTION: 33 TOWNSHIP 37 NORTH RANGE 7 EAST/WEST

FOR M.C. CORNER INDICATE: NAME OF WATERWAY N/A SECTION LINE N/A

~~CITY~~(VILLAGE)(TOWN) OF: Cassian COUNTY OF: Oneida

Description of monument found or placed and all other evidence used as a basis for monument location; including all monuments and related measurements required if the corner location is reestablished by lost corner proportionate methods. Also indicate name of original surveyor, survey date, corner monument set and established bearing trees, witness or reference monuments with ties from available records.

Found and accepted an old rusted 1" dia. iron pipe undisturbed at this corner location with uncapped top 9" above existing grade.

It was necessary to recover this corner at the request and approval of Oneida County Surveyor Mike Romportl, in order to reestablish the North 1/4 corner of Section 33 by record survey retracement.

In 1912, Vaughn noted that he set a wood post at this corner at 19.68 chains west of the North 1/4 corner of Section 33 by single proportion along the section line which he had measured at 78.68 chains, and noted BTs, a 16" Pw N14°W 27 lks and a 14" Pw S82°E 26 lks, all of which are now obliterated beyond recovery purposes.

In 1958, Branham retraced Vaughns 1912 section line from a "pin in blacktop" at the North 1/4 corner of Section 33 West 39.325 chains to an I.P. found with brass cap at the NW corner of Section 33, noting that he could not find Vaughns wood post or BTs, but found old scribed Pw stumps North and South of an old East/West fence, and that Vaughns notes were considered incorrect; so he set an I.P. as the 1/8th corner at 19.66 chains West of the North 1/4 of Section 33 and marked a new BT 5" Hem S53°W 11? lks, which is now gone, and he noted Vaughns Pw BT stump was S06°E 14 lks, which checked out this date. This ^B recovery completed October 21, 1998 and was witnessed by Martin A. Gerdes, adjacent owner, who had pointed out the old iron pipe found by previous field visitation.

Plan view map of monument location with bearing and distance ties to a minimum of four(4) described witness or reference monuments of concrete, natural stone, iron, live bearing trees or equivalent material. If applicable, also show a minimum of two(2) bearing and distance ties to any other monument found and not accepted; including the bearing and distance from the accepted monument. Indicate the basis for bearings of reference ties if not referenced to magnetic north.

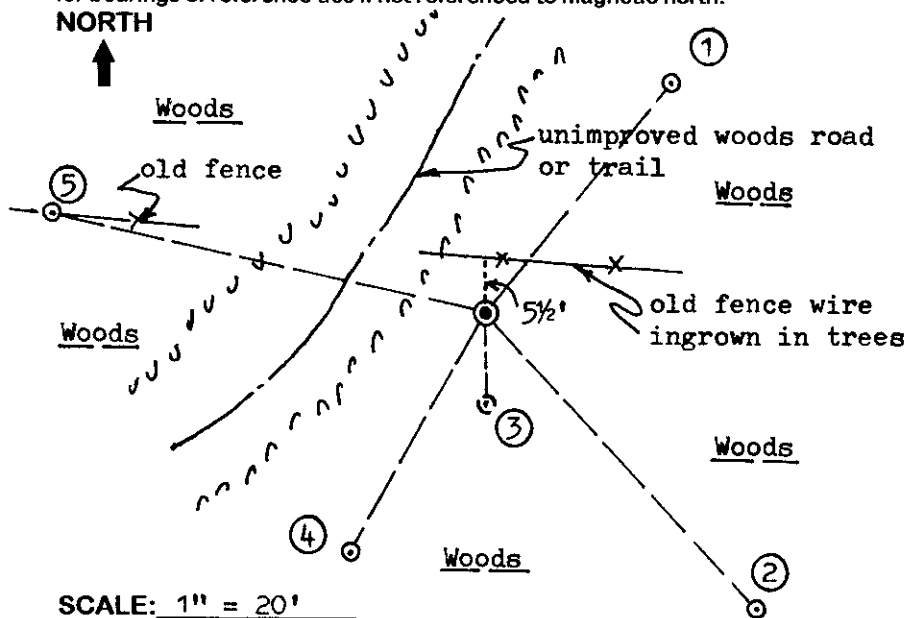

WITNESS MONUMENT TIES:

- ① New BT 9" Mr N39°E 30.40'.
- ② New BT 22" Or S42°E 42.11'.
- ③ Remains of Vaughns 1912 Pw BT as found by Branham in 1958 also as a stump, now S03°E 9.5'+/-.
- ④ New BT 10" Mr S29°W 29.13'.
- ⑤ New BT 18" Or with ingrown fence wire N78°W 46.64'.

Note: Standard white poly 'T' marker post not set near corner due to rooting and rocky soil.

SCALE: 1" = 20'

Unless otherwise indicated, all bearing tree ties are to a .25" dia. by 2.5" long PK nail with a 1.25" dia. steel washer driven into unblazed right face and a .25" dia. by 2.5" long PK nail with a 2" dia. steel washer stamped 'BT' is also driven into unblazed face of bearing tree at DBH; the basis for measured bearings is magnetic to nearest degree and all tie distances are horizontal measure to nearest 1/100th feet.

LAND SURVEYOR CERTIFICATION:

I, William C. Rohde, hereby certify that I am a duly licensed Professional Land Surveyor in Wisconsin, that this USPLS monument location was determined by me or under my direction and control, and that this U.S. Public Land Survey Monument Location Record is true and correct to the best of my knowledge and belief.

William C. Rohde Date: 10/29/98
Signature

This form is intended to fulfill requirements of Chapter A-E 7.08 (3)(a)(b)(c)(d)(e)(f)(g)(h)(i) U.S. Public Land Survey Monument Location Record, Wisconsin Administrative Code. Use reverse side for geodetic location data and/or continuation purposes.

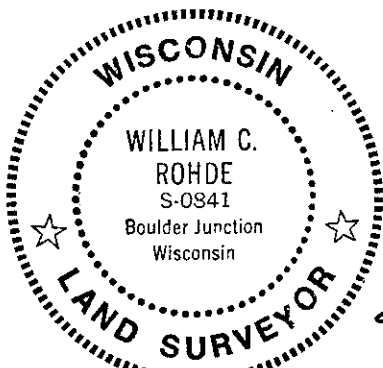

RLS SEAL

SHEET NO. 1 OF 1

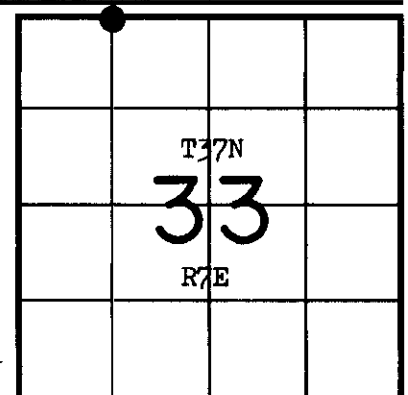

SECTION LOCATION MAP

INDEX NO. V 10
3707 2800 30

INDEX NO. V 10