

U.S. PUBLIC LAND SURVEY MONUMENT LOCATION RECORD

Recorders Data

CORNER: CW 1/16th SECTION: 28 TOWNSHIP 37 NORTH RANGE 7 EAST/WEST

FOR M.C. CORNER INDICATE: NAME OF WATERWAY N/A SECTION LINE N/A

(CITY)(VILLAGE)(TOWN) OF: Cassian COUNTY OF: Oneida

Description of monument found or placed and all other evidence used as a basis for monument location; including all monuments and related measurements required if the corner location is reestablished by lost corner proportionate methods. Also indicate name of original surveyor, survey date, corner monument set and established bearing trees, witness or reference monuments with ties from available records.

Found compressed top of an old 2" dia. iron pipe at this corner location 3 1/2" below black top pavement in center of pavement. I carefully removed the 18" long iron pipe to reveal plumb hole cavity and base impression and reset the corner location with a 3/4" dia. by 12" long steel rod with top 1" below pavement surface; I also set 1/4" dia. by 2 1/2" long PK nails 12" North, East and South and 18" West of corner center on right lines in blacktop to aid future recovery and usage. I left old iron pipe flat on grade next to standard 'T' marker post set South of corner per ties below. Recovery was witnessed by nearby residents Kelly Herman and Thomas Herman. I filled and compacted the chiseled out hole in pavement with blacktop road patching material obtained from Town of Cassian stockpile.

In 1934, H.C. Hall and others surveyed the quarter line from the West 1/4 corner to the C1/4 corner locations and noted by D.H. Vaughn, at a measured distance of 39.455 chains, and set a 2" dia. iron pipe as 1/8th S corner midway at 19.73 chains, which I found as described above; and they set a 5" square by 4' cedar post 1 1/2 rods South of the corner in road, which is now gone. This recovery completed September 22, 1998.

At the request and approval of Oneida County Surveyor Mike Romportl, it was necessary to recover this record corner in order to reestablish the C1/4 corner in accord with Halls 1934 survey, as no reliable evidence could be found at the C1/4 corner location.

Plan view map of monument location with bearing and distance ties to a minimum of four(4) described witness or reference monuments of concrete, natural stone, iron, live bearing trees or equivalent material. If applicable, also show a minimum of two(2) bearing and distance ties to any other monument found and not accepted; including the bearing and distance from the accepted monument. Indicate the basis for bearings of reference ties if not referenced to magnetic north.

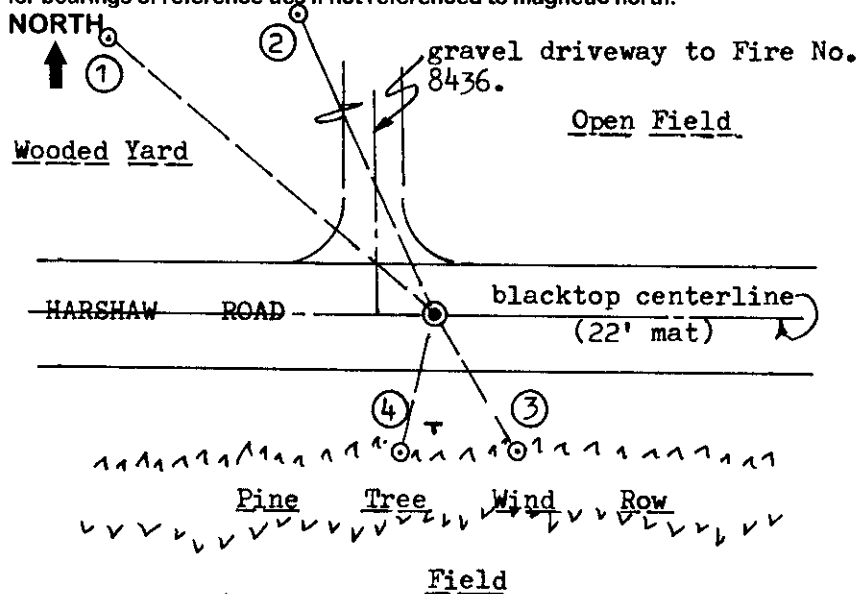

WITNESS MONUMENT TIES:

- ① New BT East 8" trunk of double Mr N50°W 89.05'.
- ② New BT SE 14" trunk of double Mr N25°W 97.64'.
- ③ New BT 6" Spruce S31°E 33.70'.
- ④ New BT 6" Spruce S14°W 29.44'.

Standard white poly 'T' corner marker post set 22.4' South of corner, at North edge of pine tree wind row.

No PK nail/BT washer set in face of BTs and no washer set with right face PK nails in BTs at request of owner.

SCALE: 1" = 40'

Unless otherwise indicated, all bearing tree ties are to a .25" dia. by 2.5" long PK nail with a 1.25" dia. steel washer driven into unblazed right face and a .25" dia. by 2.5" long PK nail with a 2" dia. steel washer stamped 'BT' is also driven into unblazed face of bearing tree at DBH; the basis for measured bearings is magnetic to nearest degree and all tie distances are horizontal measure to nearest 1/100th feet.

LAND SURVEYOR CERTIFICATION:

I, William C. Rohde, hereby certify that I am a duly licensed Professional Land Surveyor in Wisconsin, that this USPLS monument location was determined by me or under my direction and control, and that this U.S. Public Land Survey Monument Location Record is true and correct to the best of my knowledge and belief.

William C. Rohde Date: 10/28/98
Signature

This form is intended to fulfill requirements of Chapter A-E 7.08 (3)(a)(b)(c)(d)(e)(f)(g)(h)(i) U.S. Public Land Survey Monument Location Record, Wisconsin Administrative Code. Use reverse side for geodetic location data and/or continuation purposes.

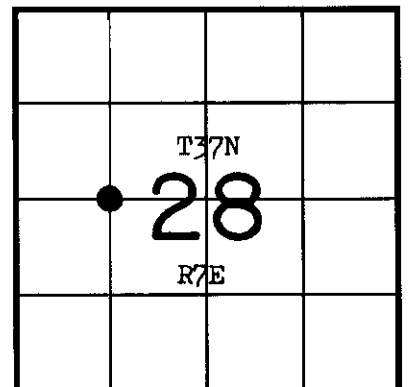

SECTION LOCATION MAP

INDEX NO. T 10
3707282030

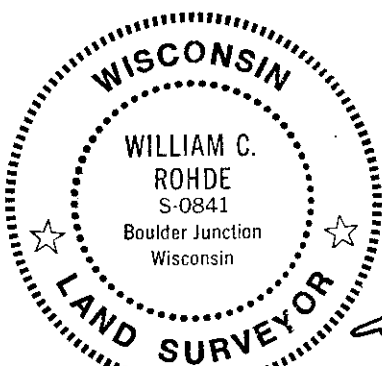

RLS SEAL

SHEET NO. 1 OF 1

INDEX NO. T 10