

This form is intended to fulfill the requirements of Chapter A-E7.08 (3)(a) thru (i) U.S. Public Land Survey Monument Location Record, Wisconsin Administrative Code. Use the reverse side of form for continuation.

U.S. PUBLIC LAND SURVEY MONUMENT LOCATION RECORD

Recorders Data

USPLS CORNER: WEST 1/4 SECTION: 33 TOWNSHIP: 37 NORTH RANGE: 7 EAST
 NAME OF WATERWAY FOR M.C. CORNER : N/A SECTION LINE: N/A
~~(CITY)(VILLAGE)(TOWN)~~ OF: CASSIAN COUNTY OF: ONEIDA

Description of monument found or placed and all other evidence used as the basis for monument location; including monuments and measurements required if the corner location was reestablished by lost corner proportionate methods. Also indicate name of the original surveyor, original survey date and the corner monument, bearing trees, witness or other reference monuments established, including measured bearing and distance ties, from available survey records.

Found an old blue painted 1" dia. iron axel shaft 12" up in a cairn of rocks at grade at this corner and an old rotted 5" cedar marker post on grade nearby. I removed the old 31" long axel shaft and drove a standard 2" dia. by 30" long aluminum pipe monument with stamped Oneida Cap 4" up into plumb soil cavity left by the old axel shaft below grade. I also found a standard white poly "T" marker post 2" North of the corner monument. I left old axel shaft flat on grade nearby with old wood marker post. Corner falls in a 30'+/- dia. brushy clearing and 5'+/- North of an old downed East/West fence.

In November 1862, Joseph H. Jenkins/GLO set a wood post as the original corner and noted OBTs: an 8" Maple S54°W 20 links and a 12" Spruce S32°E 26 links; all now obliterated beyond recovery purposes.

In June 1958, Ivan Branham/RLS 236 went to Vaughans post at this corner and replaced it with an axel shaft and set a new 5" Cedar marker post; I could not positively identify any remains of either Vaughans or Branhams BTs.

In 1979/1982, James Rein/RLS 1234 notes a 1.25" dia. axel shaft found at this corner, remains of a 6" Aspen BT S50°E 1.4' and a decayed Pw BT stump S67°W 1.29' as Vaughans; no new BTs noted.

This recovery completed 09/24/04; there were no direct witnesses.

Plan view map of monument location with bearing and distance ties to a minimum of four(4) described witness or reference monuments of concrete, natural stone, iron, live bearing trees or equivalent material. If applicable, also show a minimum of two(2) bearing and distance ties to any other monument found and not accepted; including the bearing and distance from the accepted monument.

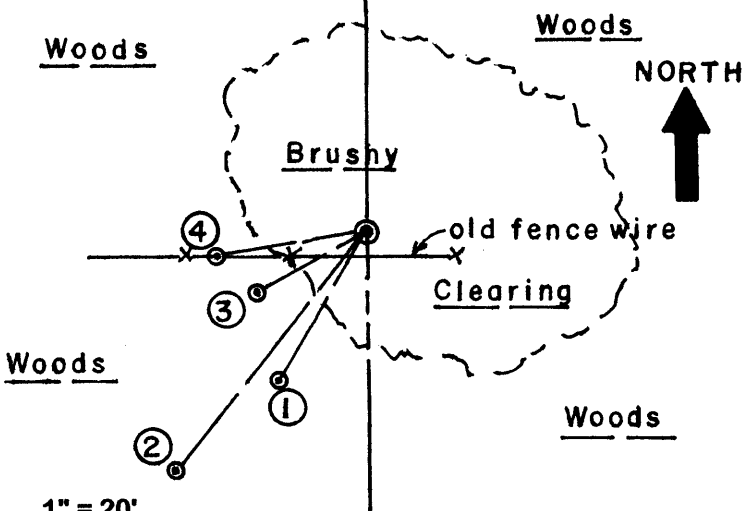

- WITNESS MONUMENT TIES:**
- ① New 8" Bw BT S31°W 18.50'.
 - ② New 9" Mr BT S38°W 32.47'.
 - ③ 9.5" North trunk of double old Bw BT with upper blaze shut and lower blaze nearly shut S60°W 13.05'.
 - ④ New 9" Bw BT S80°W 15.52' with East/West old fence wire ingrown and open upper blazes on West, South & North faces.
- I flagged monument, T post & new BTS & painted old blazes blaze orange.

SCALE: 1" = 20'

Unless otherwise indicated, all bearing tree ties are to a .25" dia. by 2.5" long PK nail with a 1.25" dia. steel washer driven into unblazed right face and a .25" dia. by 2.5" long PK nail with a 2" dia. steel washer stamped BT is also driven into unblazed face of bearing tree at DBH; the basis for measured bearings is by compass to nearest degree and all tie distances are measured horizontal by steel tape corrected to nearest 1/100th feet at standard temperature of 68° F.

RLS SEAL:



LAND SURVEYOR CERTIFICATE:

I, William C. Rohde, hereby certify that I am duly licensed as a Professional Land Surveyor in the State of Wisconsin; that this USPLS monument location was determined by me and/or under my direct supervision and control; and that this U.S. Public Land Survey Monument Location Record is true and correct to the best of my knowledge and belief.

Signed: *William C. Rohde*
 William C. Rohde RLS 841

