

State of Wisconsin } ss.
County of Oneida

I Phillip T. Hansen do hereby certify that on the 1st day of April, 1977, I found evidence of the C 1/4 corner of Section 1 Township 37 North, Range 8 East, Fourth Principal Meridian, as described hereon; and that from this evidence I established a new monument and accessories as described hereon to perpetuate the original location of this corner.

Resident witnesses:

Jim Claflin

Herb Wagoner

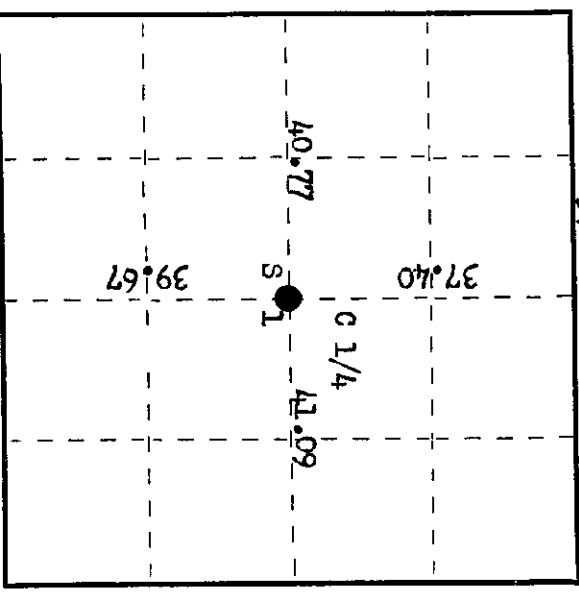
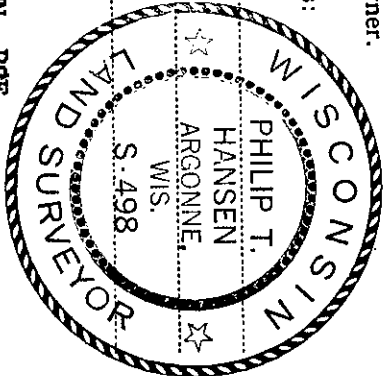

○ = Corner monument restored.

History of original corner establishment:

Corner established by Loftus and crew, Ripco surveyors, in 1960. Ran random line 179° 30' mag. from N 1/4 corner 77.07 chains to close out 7 links west of S 1/4 corner. Corrected bearing S 0° 33' E. Ran random line west bearing 90° 07' mag. from E 1/4 corner 81.86 chains to close out 1.89 chains south of E 1/4 corner. Corrected bearing N 88° 47' E. Corrected lines and set C 1/4 corner. Marked BTs - Tamarack 3" S62°E, 20 links Black Spruce 4", N82°W, 12 links.

Description of corner evidence found:

Recovered 1-3/4" iron pipe with 4" square brass cap in good condition and firmly in ground. Monument projects 20" above ground. Cap stamped: Recovered Tamarack 3" S62°E, 20.0 links, now dead. Black Spruce 4" (6") N82°W, 12.0 links, scribed C 1/4 BT. T37N R8E C 1/4 S 1

Description of monument and accessories I established to perpetuate the original location of this corner. As monument was recovered in excellent condition, it was left in place.

Marked NBTS - Black Spruce 6" N54°E, 27.0 links. Black Spruce 6" S29°E, 5.5 links, scribed 1/4 BT.

Dated at Rhinelander, Wis., this 3rd day of May, 1977.
Signature: Phillip T. Hansen, Registered Land Surveyor, Registration No. S-498
(County Surveyor, Registered Land Surveyor, or other duly authorized official)
Office of Register of Deeds, County of Oneida
at 2:00 o'clock P.M. I hereby certify that the within instrument was filed in this office for record on the 5th day of May, 1977.

Dorcas Vernege Fuchs (Register of Deeds)

By: Deputy

3708012020