

CERTIFIED LAND CORNER RESTORATION

Index No. C-21

State of Wisconsin

County of Oneida } ss.

I, Phillip T. Hansen, do hereby

certify that on the 19th day of April, 1977, I found

evidence of the Quarter corner of Section 1 & 2

Township 37, North, Range 8 East, Fourth Principal Meridian,

as described hereon; and that from this evidence I established a new monument and accessories as described hereon to perpetuate the original location of this corner.

Resident witnesses:

Jim Clafin

Herb Wagoner

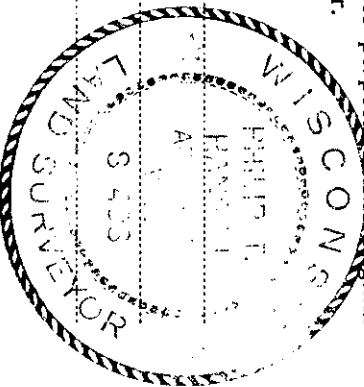

History of original corner establishment:

Original Corner established by Wm. E. Dougherty, Deputy Surveyor, in 1863, from which Yellow Pine 7" bears N7°W, 124 links.

No other trees available for bearing trees.

Corner established by N. Loftus, Ripco Surveyor, in 1960. Ran random line 358° 09' mag. 76.61 chains to close out 3.76 chains west of NW corner. Set 1/4 corner at 39.22 chains and marked BTs - Black Spruce 6" N36°W, 19 links and Black Spruce 4" S16°W, 42 links.

Description of corner evidence found:

Recovered 1-3/4" iron pipe with 3" square brass cap in excellent condition and securely in ground. Monument projects 20" above ground. Cap stamped:

Recovered OBTS - Black Spruce 4" S16°W, 42.0 links (41.8 lks).

Black Spruce 6" (7") N36°W, 19.0 links (19.5 lks).

Scribed 1/4 S2 T37-8 BT.

1/4

S2 BT

T37N R8E
RIPCO

Description of monument and accessories I established to perpetuate the original location of this corner.

As monument was recovered in good condition and firmly in ground, it was left in place.
NBT - Black Spruce 5" N78°W, 31.1 links, scribed 1/4 BT.

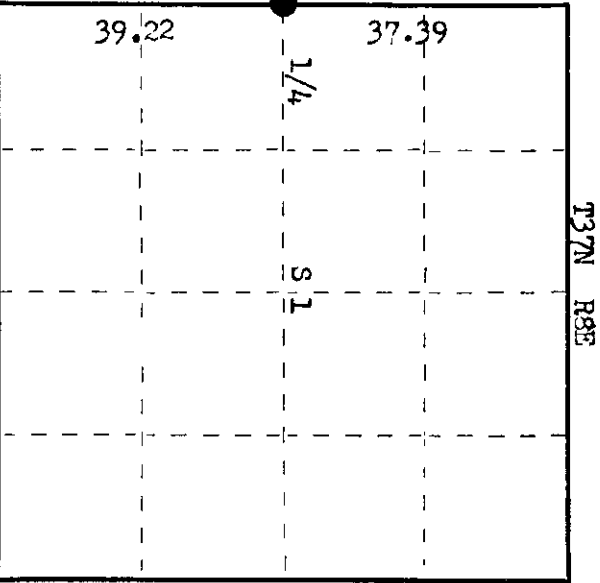

○ = Corner monument restored.

Dated at Rhineland, Wis. this 5th day of May, 1977.

Signature: Phillip T. Hansen Title: Registered Land Surveyor Registration No. S-498
(County Surveyor, Registered Land Surveyor, or other duly authorized official)

Office of Register of Deeds, County of Oneida. I hereby certify that the within instrument was filed in this office for record on the 6th day of May, 1977 at 1:00 o'clock P. M.

Dorcas Leverage Becken
(Register of Deeds)

By _____ Deputy

00002208073