

CERTIFIED LAND CORNER RESTORATION

Index No. V-23

State of Wisconsin

County of Oneida } ss.

I Phillip T. Hansen do hereby certify that on the 28th day of April, 1977, I found evidence of the Quarter corner of Section 12 & 13 Township 37 North, Range 8 East, Fourth Principal Meridian, as described hereon; and that from this evidence I established a new monument and accessories as described hereon to perpetuate the original location of this corner.

Resident witnesses:

Jim Claflin

Herb Wagoner

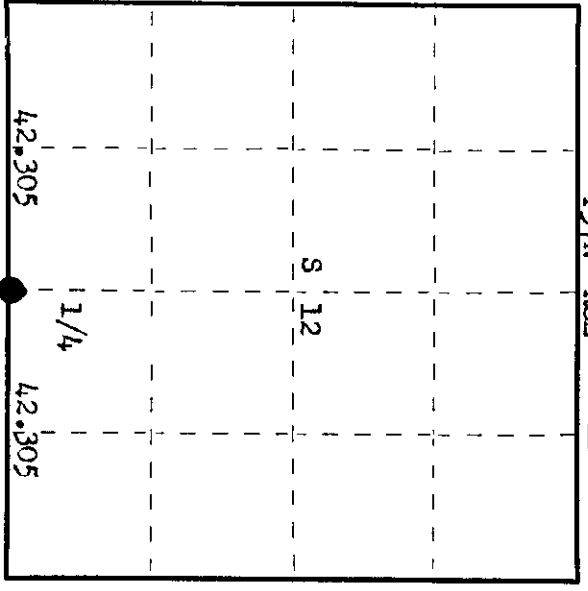
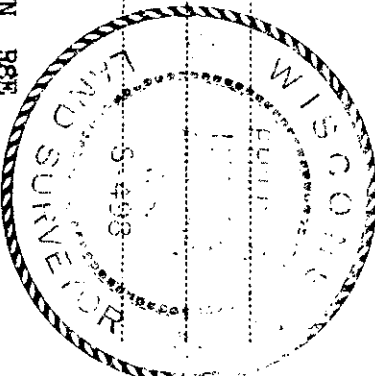

○ = Corner monument restored.

History of original corner establishment:

Original Corner established by Wm. E. Dougherty, Deputy Surveyor, in 1863, from which Birch 10" bears N39°W, 21 links and Birch 12" bears S36°W, 18 links. Corner re-established by N. Loftus, Ripco Surveyor, in 1960. Ran a random line S 89° 00' E from the SW Section Corner 84.61 chains to close out 1.45 chains south of the SE corner. Corrected bearing S 89° 59' E. Set 1/4 corner at 42.30½ chains intermediate. Marked NBTs - Red Maple 3" S40°E 6 links. White Birch 4" N 1° E, 19½ links.

Description of corner evidence found:

Recovered 2" iron pipe with 4" square brass cap in excellent condition and securely in ground. Cap stamped:
Monument projects 14" above ground.
Recovered OBTs - Red Maple 3" (6") S40°E 6 links.
White Birch 4" (7") N 1° E, 19.5 links.
Scribbling on both trees visible, but not legible.

T37N R8E
1/4 S12
S13
RIPCO

Description of monument and accessories I established to perpetuate the original location of this corner. As the monument was recovered in excellent condition, it was left in place. Marked NBT - Maple 8" S29°W, 20.7 links, scribed 1/4 BT.

Dated at Rhineland, Wis., this 5th day of May, 1977

Signature Phillip T. Hansen Title Registered Land Surveyor Registration No. 3-498
(County Surveyor, Registered Land Surveyor, or other duly authorized official)

Office of Register of Deeds, County of Oneida, I hereby certify that the within instrument was filed in this office for record on the 6th day of May, 1977, at 1:30 o'clock P. M.

Antonia Verage Steinhil
(Register of Deeds)

By..... Deputy

3708/20020