

CERTIFIED LAND CORNER RESTORATION

Index No. H-22

State of Wisconsin

County of Oneida } ss.

I Phillip T. Hansen do hereby certify that on the 27th day of March, 19 80, I found evidence of the SW 1/16 corner of Section 12 Township 37 North, Range 8 East, Fourth Principal Meridian.

as described hereon; and that from this evidence I established a new monument and accessories as described hereon to perpetuate the original location of this corner.

Resident witnesses:

Jim Clafflin

Herb Wagoner

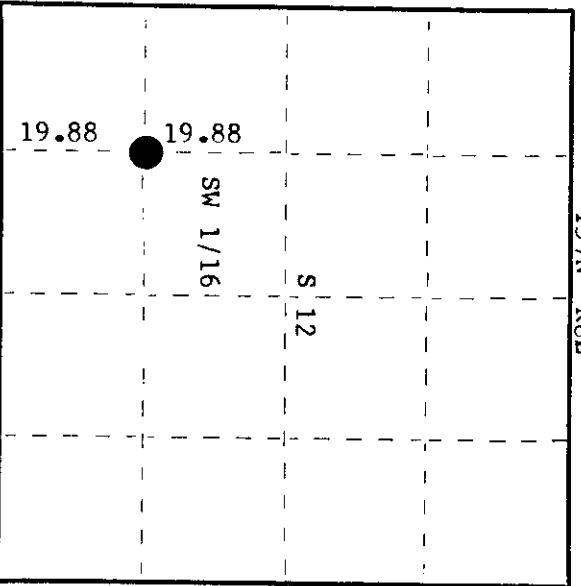
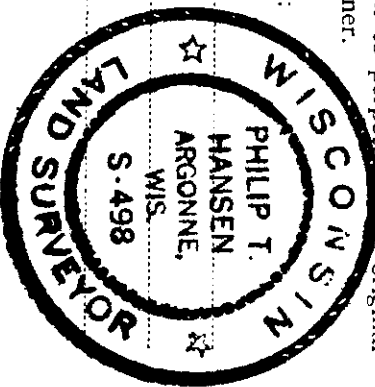

○ = Corner monument restored.

History of original corner establishment:

Corner established by N. Loftus, Ripco surveyor, in 1960. Ran exterior lines of section. Then ran north, bearing N1°E from W 1/16, 39.70 chains to close out 1.20 chains east of CW 1/16 corner.

Established SW 1/16 at 19.88 chains, 60 links west.

Marked NBT's -

Maple 4" N12°E 12-1/2 links

Spruce 3" N90°W 67-3/4 links

Corrected bearing is N 0° 44' W.

Description of corner evidence found:

Recovered Ripco's 3/4" iron pipe with 2" square brass cap in good condition.

Recovered OBT's -

Maple 4" (6") N12°E (N15°E) 12.5 links, scribing grown over

B. Spruce 3" (6") N90°W 67.75 links, scribing grown over

Monument projects 18".

Cap stamped:

T37N R8E
SW 1/16 S12

RIPCO

Description of monument and accessories I established to perpetuate the original location of this corner. As monument was securely set, it was left in place as recovered. No additional accessories established.

Dated at Rhineland, Wis., this 5th day of June, 19 80

Signature Phillip T. Hansen Title Registered Land Surveyor Registration No. S-498
(County Surveyor, Registered Land Surveyor, or other duly authorized official)

Office of Register of Deeds, County of Oneida 21st day of July, 19 80
at 3:25 o'clock M. I hereby certify that the within instrument was filed in this office for record on the

Doris Savage Kuehn
(Register of Deeds)

By _____ Deputy

CERTIFIED LAND CORNER RESTORATION

Index No. H-22

State of Wisconsin

County of Oneida } ss.

I Phillip T. Hansen do hereby certify that on the 28th day of March, 1980, I found evidence of the SW 1/16 corner of Section 12

Township 37 North, Range 8 East, Fourth Principal Meridian,

as described hereon; and that from this evidence I established a new monument and accessories as described hereon to perpetuate the original location of this corner.

Resident witnesses:

Jim Claflin

Herb Wagoner

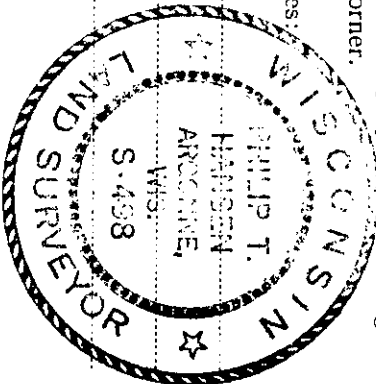

T37N R8E

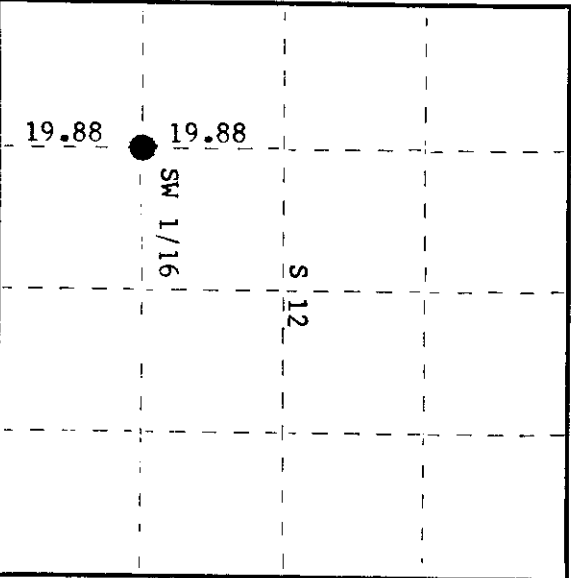

○ = Corner monument restored.

History of original corner establishment:

Corner established by N. Loftus, Ripco surveyor, in 1960. Ran random north from W 1/16 South line N 1°E 39.76 chains to close out 1.20 chains east of CW 1/16. Set SW 1/16 at 19.88 chains 60 links west.

Corrected bearing N 0° 44' W.

Marked NBT's - Maple 4" N12°E 12-1/2 links

Spruce 3" N90°W 67-3/4 links

Description of corner evidence found:

Recovered Ripco's 3/4" iron pipe with 2" square brass cap - stamped:

Recovered OBT's - Maple 4" (6") N12°E 12.5 links

B. Spruce 3" (6") N90°W 67.75 links

No additional accessories established.

T37N R8E
SW 1/16 S 12
RIFCO

Description of monument and accessories I established to perpetuate the original location of this corner.

Dated at Rhineland, Wis., this 7th day of April, 1980

Signature: Phillip T. Hansen Title: Registered Land Surveyor Registration No. S-498
(County Surveyor, Registered Land Surveyor, or other duly authorized official)

Office of Register of Deeds, County of Oneida, I hereby certify that the within instrument was filed in this office for record on the 16th day of May, 1980 at 11:20 o'clock A. M.

Doree Leauge Kuehn
(Register of Deeds)

By: _____ Deputy

3708121030