

CERTIFIED LAND CORNER RESTORATION

Index No. **6-22**

State of Wisconsin

County of Oneida } ss.

I, Phillip T. Hansen, do hereby certify that on the 28th day of April, 1977, I found evidence of the WC 1/16 corner of Section 12

Township 37, North, Range 8 East, Fourth Principal Meridian,

as described hereon; and that from this evidence I established a new monument and accessories as described hereon to perpetuate the original location of this corner.

Resident witnesses:

Jim Garlin

Herb Wagoner

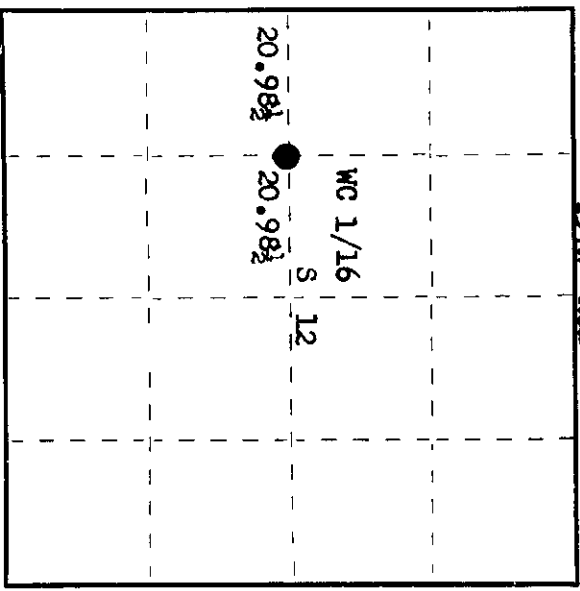
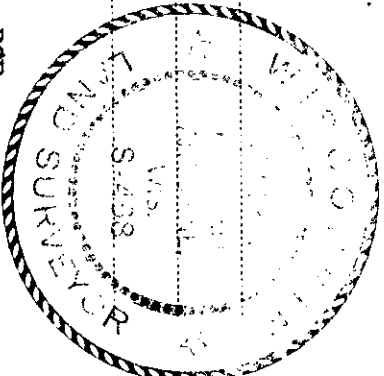

○ = Corner monument restored.

History of original corner establishment:

Corner established by N. Loftus, Ripco Surveyor, in 1960. From previously established W 1/4 corner he ran a random line east 89° 43' W mag. 83.96 chains, closed out 1.21 chains north. Established C 1/4 by running N-S 1/4 line at 41.97 chains east of 1/4 corner. Set WC 1/16 at 20.98 1/2 chains intermediate. Marked NBTs - Oak 7" S40°W, 9 1/2 links Maple 3 1/2" N57°E, 17 links.

Description of corner evidence found:

Recovered 3/4" iron pipe with 2" square brass cap in good condition and securely in ground. Cap stamped:

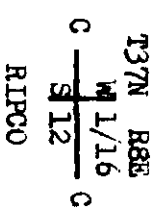

Monument projects 20" above ground. Recovered OBTs - Oak 7" (9") S40°W (S8°W) 8.5 links. Maple 3 1/2" (5") N57°E (N52°E) 17.0 lks. (16.7 lks)

All distances to center of BT.

Description of monument and accessories I established to perpetuate the original location of this corner. As monument was recovered in good condition, it was left in place. No additional accessories established.

Dated at Rhineland, Wis., this 4th day of May, 1977

Signature Phillip T. Hansen Title Registered Land Surveyor Registration No. S-498
(County Surveyor, Registered Land Surveyor, or other duly authorized official)

Office of Register of Deeds, County of Oneida. I hereby certify that the within instrument was filed in this office for record on the 6th day of May, 1977 at 10 o'clock P. M.

Donna George Finkbeiner
(Register of Deeds)

By: _____ Deputy

3708122030