

U.S. PUBLIC LAND SURVEY MONUMENT RECORD

Note: This form is intended and designed to fulfill all requirements of Wisconsin Administrative Code, Chapter A-E 5.02, U.S. Public Land Survey Monument Record (3) (a) (b) (c) (d) (e) (f) (g) (h) (i). An additional sheet may be added if necessary to conform with said requirements.

(a) Corner location: Township 37 North
 Range 8 East ~~West~~
 Town/City/Village Newbold
 County Oneida

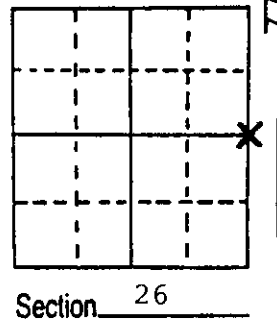

(b) (f) (g) (h) Description of monument found at this corner and if it was accepted, state all evidence (material, testimonial, occupational, plats, records, other monuments) used as a basis for accepting. If not accepted or if nothing was found, state evidence used as basis for establishing location. If reestablished through lost corner proportionate methods, indicate all monuments, distances and directions used to establish.

July 1863; Wm. E. Daugherty set wood post for 1/4 corner.
 Original BT's: 6" Birch, N64°E, 8 links (5.28').
 6" Aspen, S31°W, 5 links (3.30').
 April 30, 1902; D.H. Vaughan found original BT's nearly gone and made new BT: 18" Jack Pine stump, S46°E, 85 links (56.10').
 November 18, 1987, Milo E. Stefan found:
 1. 1" x 36" iron pipe
 2. Oak post 4" x 4" x 5' scribed 1/4S
 3. 14" - 18" decayed, burnt Red Pine stump, scribed "1/4S BT" S47°W, 36.04' to marking notch.
 4. No trace of original BTs remain. Vaughan's 1902 BT is in fill around new home.

I accept the iron pipe as the perpetuated position of the original corner.

(c) (d) (e) Plan view of corner with ties to at least 4 witness monuments. If in disagreement with previously established corner, show the distances between the two corners and also indicate the ties to the disputed corner.

1. 2" x 36" Oneida County aluminum monument 24" in ground with mound of earth around.
2. 10" White Pine, N75°E, 37.78' (Nail in south root flare, not scribed).
3. Northwest corner of house, S48°E, 67.54'.
4. 14" - 18" scribed Red Pine stump, S47°W, 36.04'.
5. 5" Red Oak, S58°W, 38.78'*
6. 5" Red Oak, N2°W, 21.41'*
 *BT scribed "1/4S", "BT", measured to nail in side of trees.
7. White plastic sign post, West 1.0'.

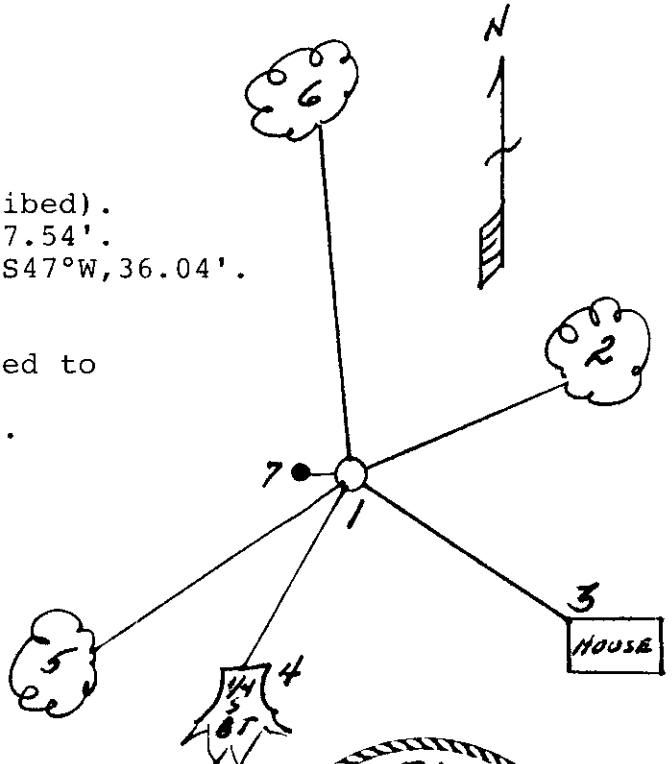

(i) I, Milo E. Stefan
 (type or print name) certify that the corner location on this record was determined by me or under my direction and control and that this U.S. Public Land Survey Monument Record is correct and complete to the best of my knowledge and belief.

Milo E. Stefan 11/19/87
 Signature Date



Index No. 7-21

3708762000