

CERTIFIED LAND CORNER RESTORATION

State of Wisconsin }  
County of ONEIDA } ss.

I William Immich, do hereby certify that on the 28th day of October, 1981, I found evidence of the meander corner corner of Section 33 Township 37 North, Range 8 East, Fourth Principal Meridian, as described hereon; and that from this evidence I established a new monument and accessories as described hereon to perpetuate the original location of this corner:

Description of original monument and accessories and subsequent restorations:

William Daugherty 1863 East between 28 & 33 Var. 7° E corrected West Set meander corner 56.22 W. Pine 10 N46E 8/ W.Pine 18 S46E 25

Earl Harington 1927 between 28 & 33 10.84 to actual shore Dumb Bell Lake found 3" square post, recently set and marked, replaced wooden stake with brass capped iron post. found original bearing trees W. Pine stump 24 N49.81k/ Y. Pine 20 S44 30: 251k/ made new bearing trees Norway 16 S22 30 E 15 Norway 9 S32E 13

Description of corner evidence found:

Found Haringtons brass capped iron post stamped as shown.

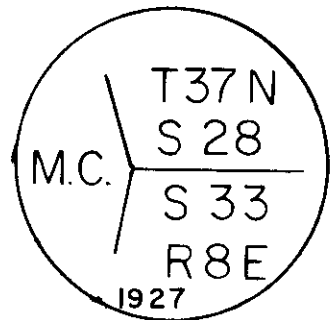

Description of monument and accessories I established to perpetuate the location of this corner:

found brass capped iron pipe corner in good condition did not re-monument

old b.t. Norway 14 S 39 E 8.57'  
new b.t. Oak 8 S 46 W 33.00'  
maple 8 North 17.20'  
dumbell lake West 16.5'

bearing trees scribed and blazed, distances to p.k. in blaze, bearings mag.

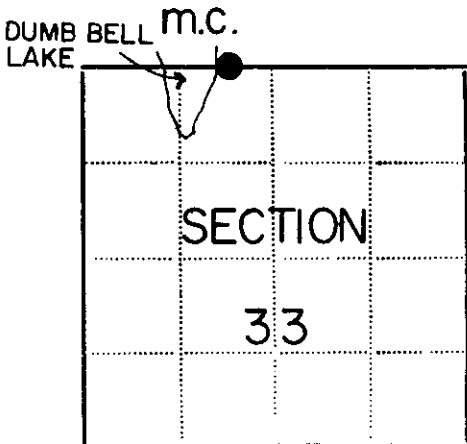

● - Corner monument restored  
□ -

Resident witnesses.....

Dated at Rhinelander Wisconsin, this 20 day of Jan 1982.

Signature *William Immich* Title R.L.S.  
(County Surveyor, Registered Land Surveyor, or other duly authorized official)

Surveyors Registration No. 1383

Office of *Reg. of Deeds* County of *Oneida*

I hereby certify that the within instrument was filed in this office for record on the 11 day of June 1986, and was filed in Book No. Page No. of County Records.

Signature *Doris Verag* Title *Reg. of Deeds*

Township 37 N., Range 8 E., Section 33, Index No., Page No.

3708280026

V-10-11

# U.S. PUBLIC LAND SURVEY MONUMENT RECORD

Note: This form is intended and designed to fulfill all requirements of Wisconsin Administrative Code, Chapter A-E 7.08 U.S. Public Land Survey Monument Record (3) (a) (b) (c) (d) (e) (f) (g) (h) (i). An additional sheet may be added if necessary to conform with said requirements.

(a) Corner location: Township 37 North

Range 8 East ~~West~~

Town/City/Village Newbold

County Oneida

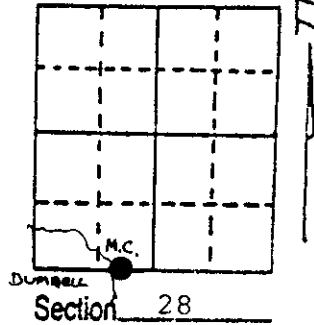

(b) (f) (g) (h) Description of monument found at this corner and if it was accepted, state all evidence (material, testimonial, occupational, plats, records, other monuments) used as a basis for accepting. If not accepted or if nothing was found, state evidence used as basis for establishing location. If reestablished through lost corner proportionate methods, indicate all monuments, distances and directions used to establish. Indicate type of monument found or set and sign post.

- 1863 Daugherty East between 28 & 33 var 7 E corrected West set M.C. 56.22 ch. W. Pine 10" N 46 E 8 lks. W. Pine 18" S 46 E 25 lks.
- 1927 Harington between 28 & 33 10.84 ch. to actual shore Dumbell Lake found 3" square post recently set and marked. Replaced wood stake with brass capped iron post, found original bearing trees W. Pine stump 24" N 49 E 8 lks. Y. Pine 20" S 44 -30' E 25 lks. Made new bearing trees Norway 16" S 22 -30' E 15 lks. Norway 8" S 38 E 13 lks.
- 1981 William Immich found brass cap old BT Norway 14" S 39 E 8.57' New BT's Oak 8" S 46 W 33.00'. Maple 8" North 17.20' Dumbell Lake West 16.5'.
- 1989 William E. Bandow found brass cap in place set white plastic post E 1' corner referenced as shown below.

(c) (d) (e) Plan view of corner with ties to at least 4 witness monuments. If in disagreement with previously established corner, show the distances between the two corners and also indicate the ties to the disputed corner.

**NOTE:**

MEASUREMENTS TAKEN FROM  
6" SPIKE IN SIDE OF TREE

BEARINGS TAKEN WITH A  
HANDHELD MAGNETIC  
COMPASS

NO SCALE

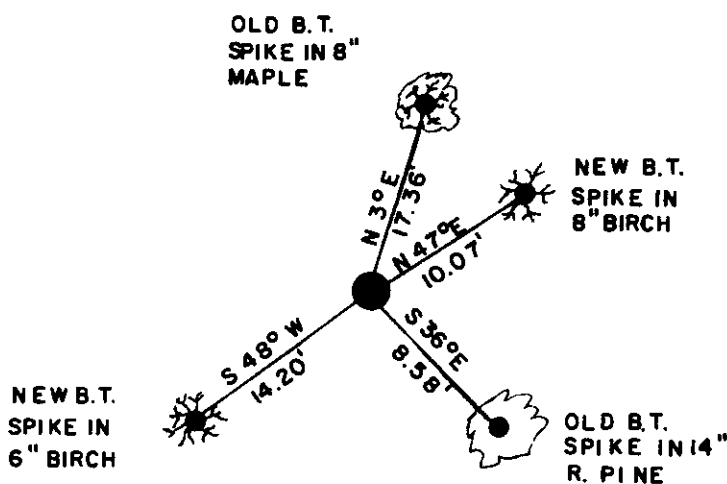

(i) I, William E. Bandow  
(type or print name) certify that the corner location on this record was determined by me or under my direction and control and that this U.S. Public Land Survey Monument Record is correct and complete to the best of my knowledge and belief.

William E. Bandow 12-29-89  
Signature Date



Index No V 10-11

3708280026

**U.S. PUBLIC LAND SURVEY MONUMENT LOCATION RECORD**

Recorders Data

CORNER: East MC SECTION: 33 TOWNSHIP 37 NORTH RANGE 8 EAST/WEST

FOR M.C. CORNER INDICATE: NAME OF WATERWAY Dumb Bell Lake SECTION LINE North

~~TOWNSHIP~~ (TOWN) OF: Newbold COUNTY OF: Oneida

Description of monument found or placed and all other evidence used as a basis for monument location; including all monuments and related measurements required if the corner location is reestablished by lost corner proportionate methods. Also indicate name of original surveyor, survey date, corner monument set and established bearing trees, witness or reference monuments with ties from available records.

Found and accepted a standard 2" O.D. iron pipe monument with stamped 1927 GLO brass cap 10" above grade and undisturbed, along North edge of a football size rock.

In 1863, Daugherty/GLO set a wood post as the original MC and marked OBTs, a 10" Pw N46°E 8 lks, now a badly rotted root crown at grade with a 3" Pr growing out of West edge, and an 18" Py S46°E 20 lks, now gone as well as wood corner post.

In 1927, Harrington/GLO found and accepted a 3" squared and marked wood stake as the corner which he reset with standard GLO brass capped iron pipe found this date, and he noted 24" Pw OBT stump with no marks S49°E 8 lks and a fallen 20" Py OBT S44°30'E 25 lks with plain blaze, and he marked new BTs, a 16" Pr S22°30'E 15 lks and scribed "Orig MC No. 42 BT", now an 18" Pr S21°E 9.90' with face blaze above root crown shut but plain, and he marked an 8" Pr S38°E 13 lks and scribed "S33 MC BT", now a 15" Pr S38°E distance OK to open blaze above root crown with plain scribing.

This GLO capped monument has been found and further confirmed as MC location by reference to the following plats of survey filed in Oneida County records:

Plat of Survey No. L-1154 by McKnown/1952, Plat of Survey No. C-244 by Schmit/1977, Plat of Survey No. A-356 by W. Bandow/1986.

This recovery completed September 29, 1998; there were no witnesses.

Plan view map of monument location with bearing and distance ties to a minimum of four(4) described witness or reference monuments of concrete, natural stone, iron, live bearing trees or equivalent material. If applicable, also show a minimum of two(2) bearing and distance ties to any other monument found and not accepted; including the bearing and distance from the accepted monument. Indicate the basis for bearings of reference ties if not referenced to magnetic north.

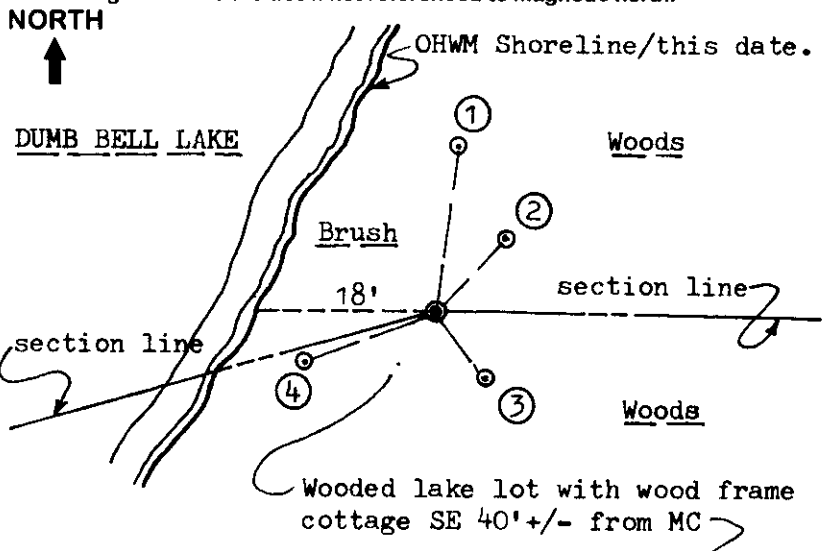

**WITNESS MONUMENT TIES:**

- ① Old BT 9" Mr N08°E 17.54'; blaze above root crown open with plain scribing.
- ② New BT 8" Bw N43°E 10.11'.
- ③ Record GLO BT/1927 S38°E 8.67'; blaze above root crown open with plain scribing and PK nail in face, now a 15" Pr.
- ④ New BT 5" Pr S69°W 14.88'.

Note: Standard white poly 'T' marker post set 8" East of corner monument. Standard BT sign nailed to West face of BT at ③.

SCALE: 1" = 20'

Unless otherwise indicated, all bearing tree ties are to a .25" dia. by 2.5" long PK nail with a 1.25" dia. steel washer driven into unblazed right face and a .25" dia. by 2.5" long PK nail with a 2" dia. steel washer stamped 'BT' is also driven into unblazed face of bearing tree at DBH; the basis for measured bearings is magnetic to nearest degree and all tie distances are horizontal measure to nearest 1/100th feet.

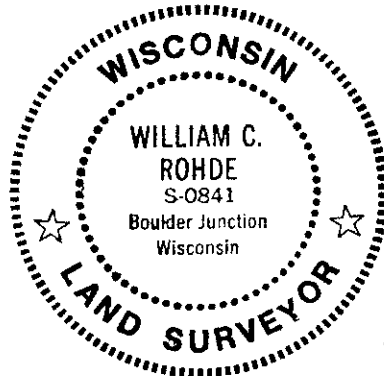

**LAND SURVEYOR CERTIFICATION:**

I, William C. Rohde, hereby certify that I am a duly licensed Professional Land Surveyor in Wisconsin, that this USPLS monument location was determined by me or under my direction and control, and that this U.S. Public Land Survey Monument Location Record is true and correct to the best of my knowledge and belief.

William C. Rohde Date: 01-11-99  
Signature

	33		

**SECTION LOCATION MAP**

INDEX NO. 3708280026

INDEX NO. 3708280026