

# U.S. PUBLIC LAND SURVEY MONUMENT RECORD

**Note:** This form is intended and designed to fulfill all requirements of Wisconsin Administrative Code, Chapter A-E 7.08 U.S. Public Land Survey Monument Record (3) (a) (b) (c) (d) (e) (f) (g) (h) (i). An additional sheet may be added if necessary to conform with said requirements.

(a) Corner location: Township 37 North

Range 8 East/West

Town/City/Village Pine Lake

County Oneida

REGISTER OF DEEDS OFFICE  
ONEIDA COUNTY, WIS.

FILED

MAY 30 1991

At O'Clock M  
**THOMAS H. LEIGHTON**  
REGISTER OF DEEDS

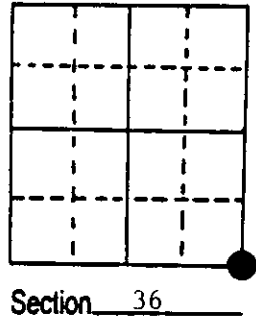

(b) (f) (g) (h) Description of monument found at this corner and if it was accepted, state all evidence (material, testimonial, occupational, plats, records, other monuments) used as a basis for accepting. If not accepted or if nothing was found, state evidence used as basis for establishing location. If reestablished through lost corner proportionate methods, indicate all monuments, distances and directions used to establish. Indicate type of monument found or set and sign post.

1859 - H.C. Fellows established this corner at 82.13 Chains when closing on Range Line 2.23 Chains north of temporary Township Corner. He set a wood post and made four BTs:

- |                               |                             |
|-------------------------------|-----------------------------|
| 6" Tamarack, N15°E, 6 Links   | 6" Tamarack, S19°W, 8 Links |
| 10" Tamarack, S40°E, 18 Links | 6" Tamarack, N27°W, 7 Links |

1920's - In preparation of plats of G.S. Coons Addition and LakeView Addition to the City of Rhinelander, this corner was used; it was called 326.1 feet Southerly from the Centerline of the Chicago and Northwestern Railroad Tracks. It was also called 2632 feet Easterly of the Quarter Corner Westerly.

2/1991 - Milo E. Stefan restored this corner to harmonously correspond to the lines of occupation to the lot lines to G.S. Coons and LakeView Plats to the City of Rhinelander as well as distances as called for Northerly and Westerly.

(c) (d) (e) Plan view of corner with ties to at least 4 witness monuments. If in disagreement with previously established corner, show the distances between the two corners and also indicate the ties to the disputed corner.

- 1) Railroad spike nail in blacktop
- 2) 8" Red Pine, N56°E, 54.55 feet
- 3) 7" Red Pine, N12°W, 37.40 feet
- 4) 8" Red Pine, N17°E, 35.25 feet
- 5) 2" x 36" aluminum monument in cairn of stone (W.C.), North, 22.44 feet
- 6) 1 1/4" x 24" iron pipe, North, 226.1 feet
- 7) Plastic sign post, North of Witness Corner, 1.0'

Distances to nail in side of BTs.  
Stump blaze scribed "BT".

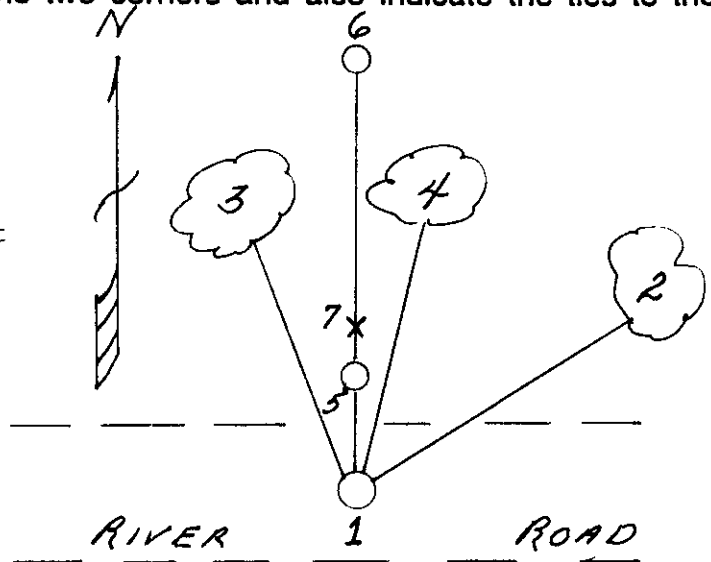

(i) I, Milo E. Stefan  
(type or print name) certify that the corner location on this record was determined by me or under my direction and control and that this U.S. Public Land Survey Monument Record is correct and complete to the best of my knowledge and belief.

Milo E. Stefan  
Signature

April 18, 1991

Date

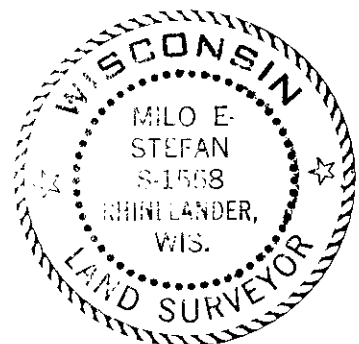

Index No. 2-25

Stamp 3708360000