

U.S. PUBLIC LAND SURVEY MONUMENT RECORD

Note: This form is intended and designed to fulfill all requirements of Wisconsin Administrative Code, Chapter A-E 7.08 U.S. Public Land Survey Monument Record (3) (a) (b) (c) (d) (e) (f) (g) (h) (i). An additional sheet may be added if necessary to conform with said requirements.

(a) Corner location: Township 37 North

Range 8 East/West

Town/City/Village Pine Lake

County Oneida

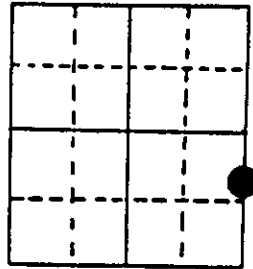
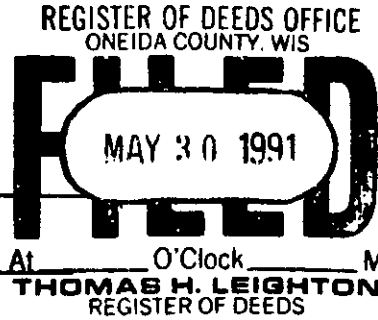

Section 36

(b) (f) (g) (h) Description of monument found at this corner and if it was accepted, state all evidence (material, testimonial, occupational, plats, records, other monuments) used as a basis for accepting. If not accepted or if nothing was found, state evidence used as basis for establishing location. If reestablished through lost corner proportionate methods, indicate all monuments, distances and directions used to establish. Indicate type of monument found or set and sign post.

Sept. 1860 - H. C. Fellows established this corner at 14.44 chains north of Township Corner, set wood post with BTs:
 12" W. Pine, N20°E, 65 Links 12" W. Pine, N20°E, 133 Links

2/14/1991 - Milo E. Stefan, in survey of the Range Line from the Township Corner southerly to the Quarter Corner northerly, finds the Meander Corner by Fellows now falls in the flowage created by the dam on the Wisconsin River, now known as Boom Lake. We, therefore, establish a Witness Corner on the north shore of Boom Lake that witnesses the proportioned position of the original Meander Corner. See drawing on back of this sheet.

(c) (d) (e) Plan view of corner with ties to at least 4 witness monuments. If in disagreement with previously established corner, show the distances between the two corners and also indicate the ties to the disputed corner.

- 1) 2" x 36" aluminum county monument
- 2) 6" Red Oak, S87°W, 13.38'
- 3) 4" Red Oak, N44°W, 19.91'
- 4) 6" White Pine, N10°W, 42.01'
- 5) 1½" x 24" High Iron Pipe, North Edge of Road R-O-W & End of Road on Plat of "Shady Point" North 224.06'
- 6) Plastic sign post, Northwest, 1.7'

Distances to nail in side of BTs.
 Stump blaze scribed "BT".

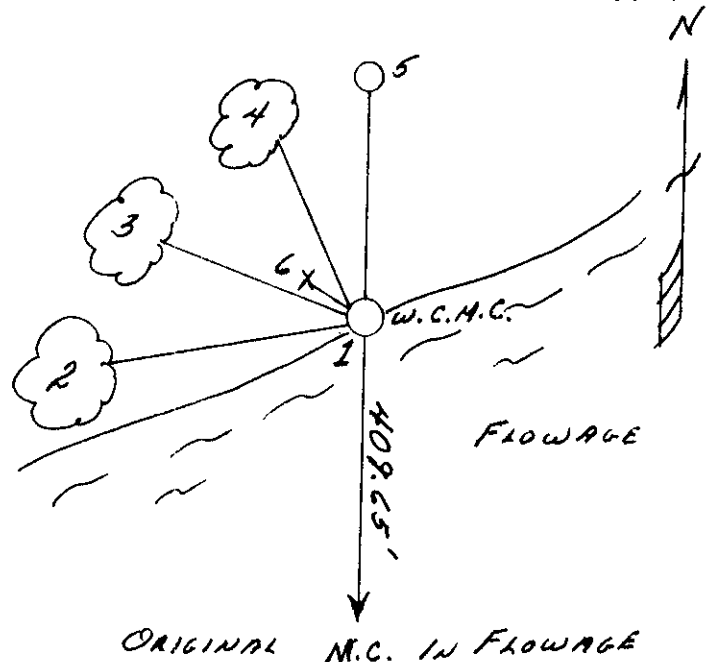

(i) I, Milo E. Stefan
 (type or print name) certify that the corner location on this record was determined by me or under my direction and control and that this U.S. Public Land Survey Monument Record is correct and complete to the best of my knowledge and belief.

Milo E. Stefan
 Signature

April 18, 1991
 Date



Index No. X, Y-25

Stamp
 3708361100

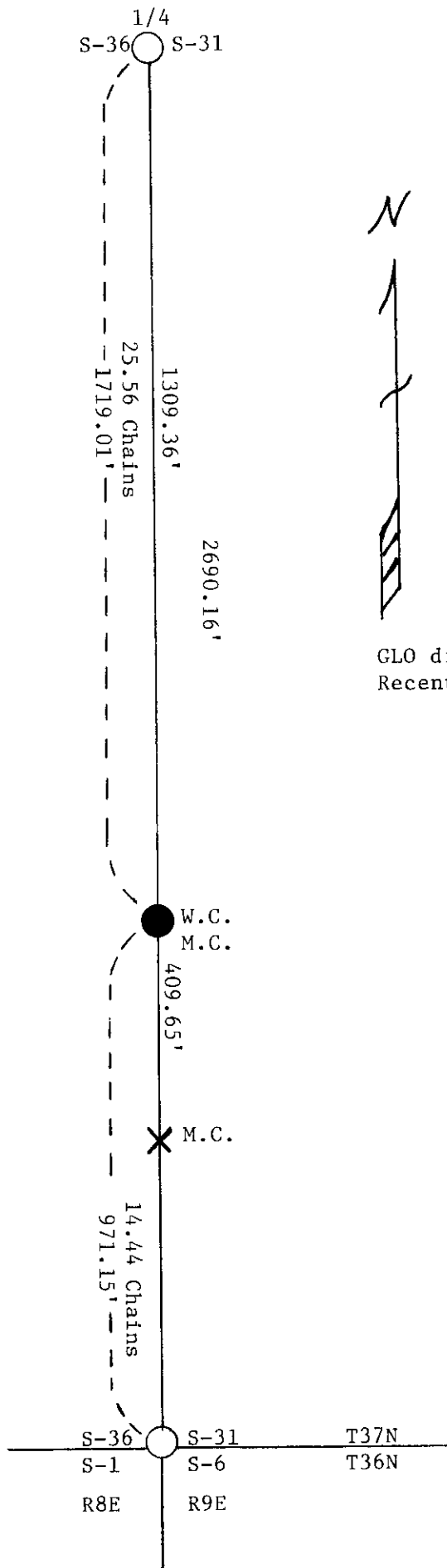

GLO distances in chains
Recent measure in feet