

CERTIFIED LAND CORNER RESTORATION

Index No. X-15

State of Wisconsin

County of Oneida } ss.

I Phillip T. Hansen, do hereby certify that on the 15th day of February, 1977, I found evidence of the C 1/4 corner of Section 34 Township 37, North, Range 9 East, Fourth Principal Meridian,

as described hereon; and that from this evidence I established a new monument and accessories as described hereon to perpetuate the original location of this corner.

Resident witnesses:

Jim Clafflin

Herb Wagoner

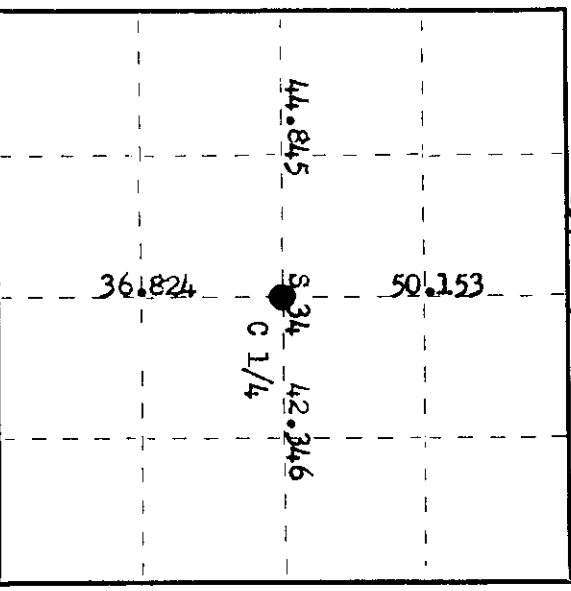
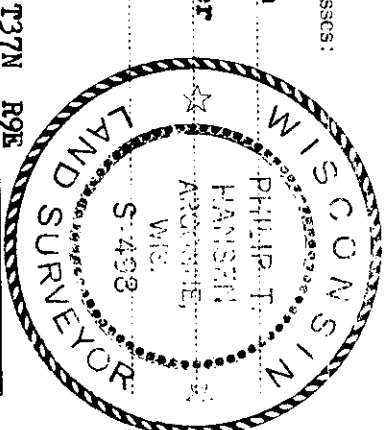

○ = Corner monument restored.

History of original corner establishment:

Corner established by N. Loftus, Ripco Surveyor, in 1961. Ran a random line from N 1/4 south bearing 175° 30' a distance of 86.977 chains to close out 3.65 chains west of S 1/4 corner. Ran random line west from East 1/4 corner 87.192 chains. Corrected both and established C 1/4 corner. Marked NBTs - White Pine 11" N 5° W 64 links and White Pine 8" S 75° E 73 links.

Description of corner evidence found:

Recovered 1 1/2" iron pipe with alloy cap, stamped:

This was recovered in excellent condition. Also recovered a 5" square cedar post scribed C 1/4 S34.

Recovered OBTS - White Pine 11" (13") N 5° W 64.0 links, scribed C 1/4 S34 BT. T37N R9E C 1/4 S34

White Pine 8" (10") S 75° E 73.0 links, (S 70° E), scribing not legible. R1PCO

Monument projects 30" above ground.

Description of monument and accessories I established to perpetuate the original location of this corner. As monument was recovered in excellent condition, it was left in place. No additional accessories established.

Dated at Rhineland, Wis. this 17th day of March, 1977.

Signature Phillip T. Hansen Title Registered Land Surveyor Registration No. S-498
(County Surveyor, Registered Land Surveyor, or other duly authorized official)

Office of Registrar of Deeds, County of Oneida. I hereby certify that the within instrument was filed in this office for record on the 1st day of April, 1977 at 9:25 o'clock P. M.

James L. ...
(Registrar of Deeds)

By: _____ Deputy

3709 342020