

CERTIFIED LAND CORNER RESTORATION

Index No. **C-5**

State of Wisconsin

County of Oneida } ss.

I Phillip T. Hansen, do hereby certify that on the 3rd day of June, 19 77, I found evidence of the Quarter corner of Sec. 5 & 6 Township 37, North, Range 10 East, Fourth Principal Meridian, as described hereon; and that from this evidence I established a new monument and accessories as described hereon to perpetuate the original location of this corner.

Resident witnesses:  
Jim Claffin  
Herb Wagoner

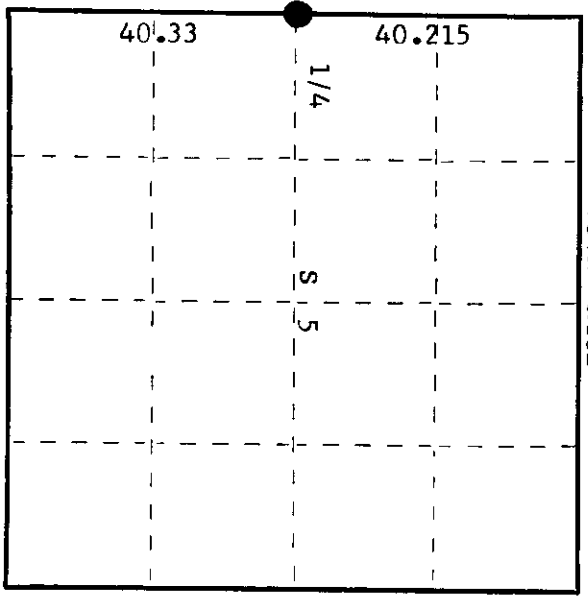
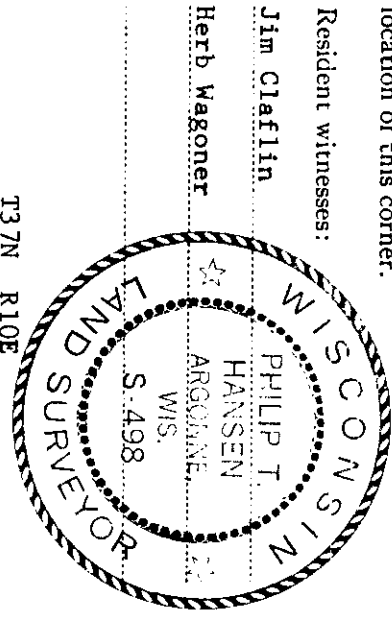

○ = Corner monument restored.

History of original corner establishment:

Original Corner established by Wm. E. Dougherty, Deputy Surveyor, in 1863, from which Tamarack 8" bears S72°E, 12 links; Tamarack 8" bears S76°W, 5 links. Corner recovered and restored by B.F. Dorr, County Surveyor. N. Loftus, Ripco Surveyor, recovered Dorr's corner in 1959. Marked NBTs - Black Spruce 3" N39°E, 4 links and Black Spruce 3" N70°W, 29½ links.

Description of corner evidence found:

Recovered Loftus' 1-3/4" OD iron pipe with 4" square brass cap in excellent condition. Cap stamped:

1/4  
S6|S5  
T37N R10E  
RIPCO

Monument projects 20" above ground.  
Recovered OBTs - Black Spruce 3" N39°E 4 links, only stump remains.  
Black Spruce 3" N70°W (N66°W) 29.5 links (29.0 lks), scribing not legible.

Description of monument and accessories I established to perpetuate the original location of this corner.

NBTs - Black Spruce 6" N54°E, 16.3 links, scribed 1/4 BT.  
Black Spruce 8" West, 44.5 links, scribed 1/4 BT.

Dated at Rhinelander, Wis. this 8th day of June, 19 77.

Signature Phillip T. Hansen Title Registered Land Surveyor Registration No. S-498  
(County Surveyor, Registered Land Surveyor, or other duly authorized official)

Office of Register of Deeds, County of Oneida, I hereby certify that the within instrument was filed in this office for record on the 30th day of June, 19 77 at 9:20 o'clock PM.

Steve Tenage Cook  
(Register of Deeds)

By Joseph M. Boerner Deputy

3710062000