

CERTIFIED LAND CORNER RESTORATION

Index No. L-6

State of Wisconsin

County of Oneida } ss.

I, Phillip T. Hansen, do hereby certify that on the 14th day of May, 1980, I found evidence of the WC 1/16 corner of Section 17 Township 37, North, Range 4 East, Fourth Principal Meridian, as described hereon; and that from this evidence I established a new monument and accessories as described hereon to perpetuate the original location of this corner.

Resident witnesses:

Jim Claflin

Herb Wagoner

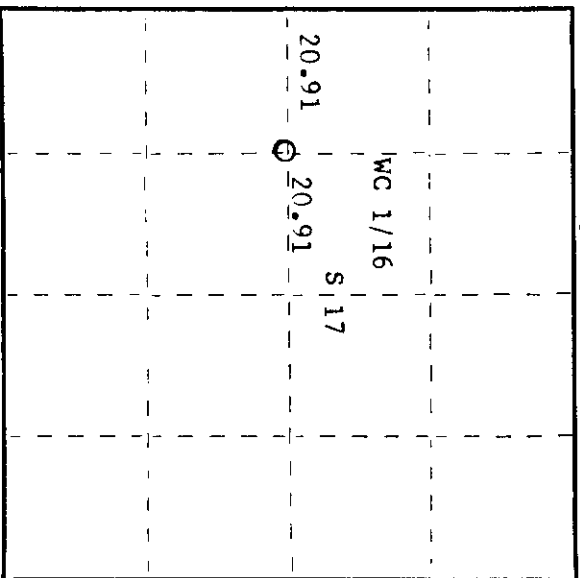
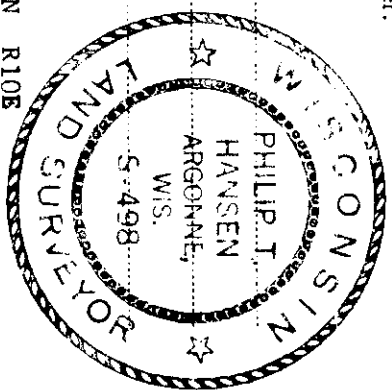

O = Corner monument restored.

History of original corner establishment:

Corner established by N. Loftus, Ripco surveyor, in 1954. Subdivided section for C 1/4 corner, from C 1/4 corner to W 1/4 corner is N 89° 43' W 41.82 chains. Set WC 1/16 corner 20.91 intermediate. Marked NBT's -

J. Pine 12" S62°W 1.65 chains
Pine stump 14" N19°E 61 links

Description of corner evidence found:

Recovered 3/4" iron pipe with 2" brass cap, stamped: Monument projects 24" above ground.

Recovered OBT's -
J. Pine 12" S62°W 1.65 chains
now a cut-off stump.
Pine stump N19°E 61 links
scribed 1/16 S17 BT.

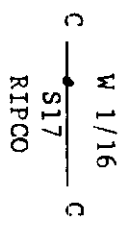

Description of monument and accessories I established to perpetuate the original location of this corner. Monument left as recovered.

Marked NBT's -
R. Pine 6" N66°E 21.0 links
R. Pine 6" N61°W 17.3 links
scribed 1/16 BT.

Dated at Rhinelander, Wis., this 22nd day of July, 1980

Signature Phillip T. Hansen Title Registered Land Surveyor Registration No. S-498
(County Surveyor, Registered Land Surveyor, or other duly authorized official)

Office of Register of Deeds, County of Oneida I hereby certify that the within instrument was filed in this office for record on the 30th day of July, 1980 at 10:15 o'clock A. M.

Doris Verage Kuehn
(Register of Deeds)

By..... Deputy