

CERTIFIED LAND CORNER RESTORATION

Index No. **Y-13**

State of Wisconsin

County of Oneida } ss.

I, Philip T. Hansen, do hereby certify that on the 18th day of August, 1975, I found evidence of the S-1/16 between corner of Sections 33 and 34 Township 37N North, Range 10 East, Fourth Principal Meridian, as described hereon; and that from this evidence I established a new monument and accessories as described hereon to perpetuate the original location of this corner.

Resident witnesses:

Clen Barker

Jim Graflin



History of original corner establishment:
 Corner established by H.C. Lawrence, Registered Land Surveyor, in 1946. From recovered Northwest corner of Section 3, a 1" pipe and old post set by D.H. Vaughan, County Surveyor, who claims to have recovered original corner; he ran North magnetic a distance of 40.53 chains to a point 1.38 chains measured at right angles to an old scribed 1/4 post. Origin unknown, unable to find any trace of original BT's.
 He set the S-1/16 corner at 20.26 1/2 chains 69 links West of the random line.

Description of corner evidence found:
 Recovered 4" cedar post, squared and scribed S-1/16 S33; S-1/16 S34, in fair condition.
 No trace of BT's recovered and no record of BT's established.

Description of monument and accessories I established to perpetuate the original location of this corner.
 Replaced wooden stake with 1 1/2" OD iron pipe with 2" brass cap stamped -

NBT's - White birch 10" S29°W 34 links scribed 1/16 BT S498
 Red maple 6" S30°W 62.4 links scribed 1/16 BT T37N, R10E

S-1/16 S33 + S34
 CPI-1975

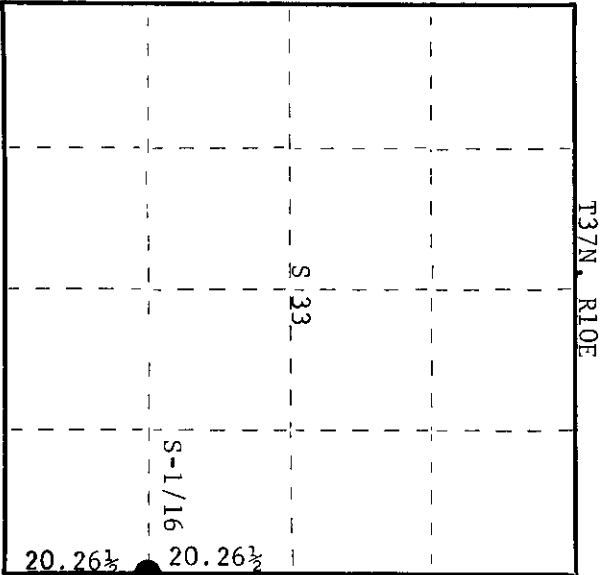

○ = Corner monument restored.

Dated at Rhineland, Wis., this 2nd day of September, 1975.

Signature: *Philip T. Hansen* Title: Registered Land Surveyor
 (County Surveyor, Registered Land Surveyor, or other duly authorized official)

Office of Register of Deeds, County of Oneida
 Instrument was filed in this office for record on the 14th day of August, 1975 at 2:02 o'clock P.M.

Donna Vange Kuehn
 (Register of Deeds)

By _____ Deputy

3710331000