

CERTIFIED LAND CORNER RESTORATION

E 11 Index No. **E-11**

State of Wisconsin

ss.

County of Oneida

I Philip T. Hansen, do hereby

certify that on the 1st day

of May 19 75, I found

evidence of the Quarter

corner of Sections 4 and 9

Township 37N

11 East, North, Range

as described hereon; and that from this evidence

I established a new monument and accessories

as described hereon to perpetuate the original

location of this corner.

Resident witnesses:

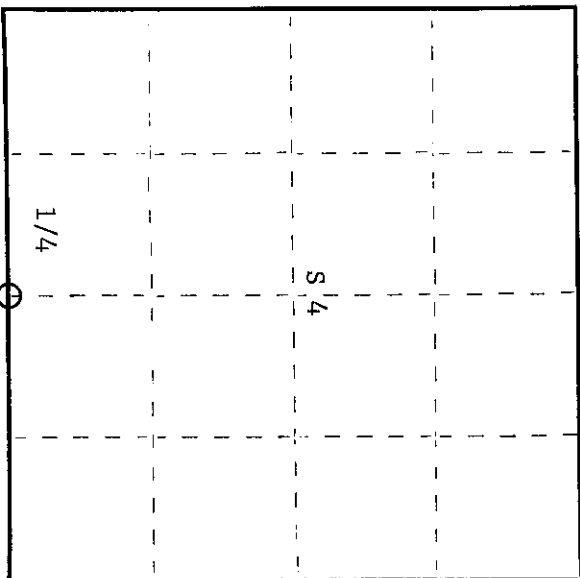
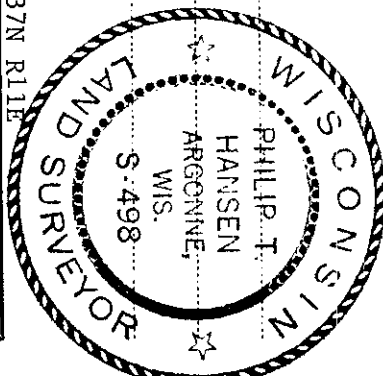

○ = Corner monument restored.

History of original corner establishment:

Corner of unknown origin recovered by H.C. Lawrence, Registered Land Surveyor. States he set a 4" cedar post from which old BT's hemlock 20" bears N12°E, 59 links, and NBT's white birch 8" bears S1°W, 18 links.

Description of corner evidence found:

Recovered 1-1/2" iron pipe with location tag nailed to 6" aspen and a 5" cedar post, squared and scribed S9 S-1/4, S4 S-1/4 lying beside it. Notation on location tag 110 links west to true corner. Wesley White states that prior to the construction of Highway 45, he set the witness corner, as the post at true corner was in danger of being destroyed.

Description of monument and accessories I established to perpetuate the original location of this corner.

Replaced 1-1/2" iron pipe witness corner with 2-1/2" iron pipe w/brass cap stamped -

S498  
T37N R11E

Established NBT's: White birch 6" N76°W 120.1 links

1/4  $\frac{S|4}{S|9}$  H.C.

White birch 6" S75°W 135.5 links scribed 1/4 BT.

Measurements and bearings to true corner, E-110 links  
CPI-1975

Dated at Rhineland, Wis., this 25th day of June, 19 75.

Signature: *Philip T. Hansen* Title: Registered Land Surveyor Registration No. S-498  
(County Surveyor, Registered Land Surveyor, or other duly authorized official)

Office of Register of Deeds, County of Oneida. I hereby certify that the within instrument was filed in this office for record on the 1st day of October, 19 75 at 3:00 o'clock P.M.

*Doris George Kuehn*  
(Register of Deeds)

By: \_\_\_\_\_ Deputy

# U.S. PUBLIC LAND SURVEY MONUMENT RECORD

**Note:** This form is intended and designed to fulfill all requirements of Wisconsin Administrative Code, Chapter A-E 7.08 U.S. Public Land Survey Monument Record (3) (a) (b) (c) (d) (e) (f) (g) (h) (i). An additional sheet may be added if necessary to conform with said requirements.

(a) Corner location: Township 37 North  
 Range 11 East/West

Town/City/Village Piehl  
 County Oneida

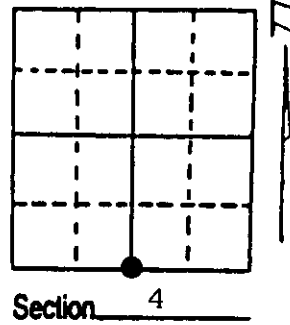

(b) (f) (g) (h) Description of monument found at this corner and if it was accepted, state all evidence (material, testimonial, occupational, plats, records, other monuments) used as a basis for accepting. If not accepted or if nothing was found, state evidence used as basis for establishing location. If reestablished through lost corner proportionate methods, indicate all monuments, distances and directions used to establish. Indicate type of monument found or set and sign post.

- 1859 - William Daugherty - 40.09 ch. set post.  
 Original B.T.'s Birch 7" N20°W 7 lks.  
 Hemlock 6" S26°E 10 lks.
- 1935 - Maine - ( Book 1935 P. 86 ) Finds original B.T.'s and replaces rotted post.  
 New B.T. Hemlock 15" N10°E 59 lks.
- 1959 - Wincentzen - ( Book 1 P. 167-169 ) Shows iron pipe set at this position on map of section subdivision of Section 4.
- 1975 - Hanson - Replaced iron pipe with a C.P.I. 2 1/2" iron pipe - aluminum cap monument. Corner form filed by Hanson states that due to the construction of St.Hwy "45" this was to be a witness to true corner as the true corner would fall in the road. However the S 1/4 of Section 4 is approximately 1800 feet East of Hwy.
- 2000 - Recovered C.P.I. iron pipe aluminum cap monument and 1 B.T. at at this position. Made new B.T.'s and set plastic sign post.

(c) (d) (e) Plan view of corner with ties to at least 4 witness monuments. If in disagreement with previously established corner, show the distances between the two corners and also indicate the ties to the disputed corner.

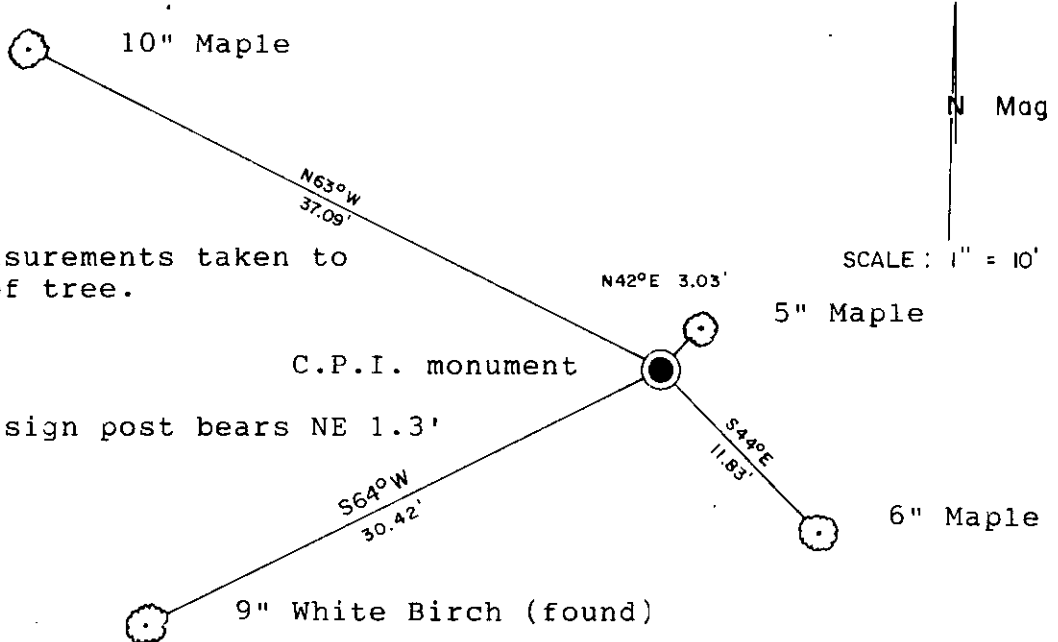

Note: all measurements taken to nail in side of tree.

Note: Plastic sign post bears NE 1.3'

(i) I, Kip W. Soder R.L.S #1731  
 (type or print name) certify that the corner location on this record was determined by me or under my direction and control and that this U.S. Public Land Survey Monument Record is correct and complete to the best of my knowledge and belief.

Kip W. Soder Signature      5/18/00 Date



Index No. E-11

Stamp  
3711040020