

CERTIFIED LAND CORNER RESTORATION

R 21 Index No. **R-21**

3711230000

State of Wisconsin

County of Oneida } ss.

I Phillip T. Hansen do hereby certify that on the 24th day of June 19 75, I found evidence of the Section corner of S23, S24, S25, S26 Township 37 North, Range 11 East, Fourth Principal Meridian, as described hereon; and that from this evidence I established a new monument and accessories as described hereon to perpetuate the original location of this corner.

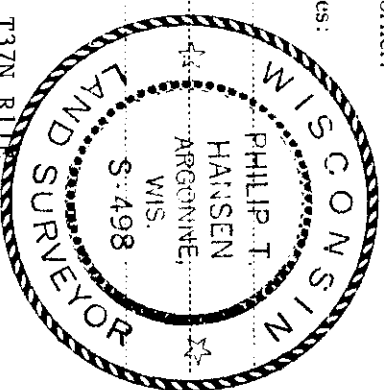

Resident witnesses:

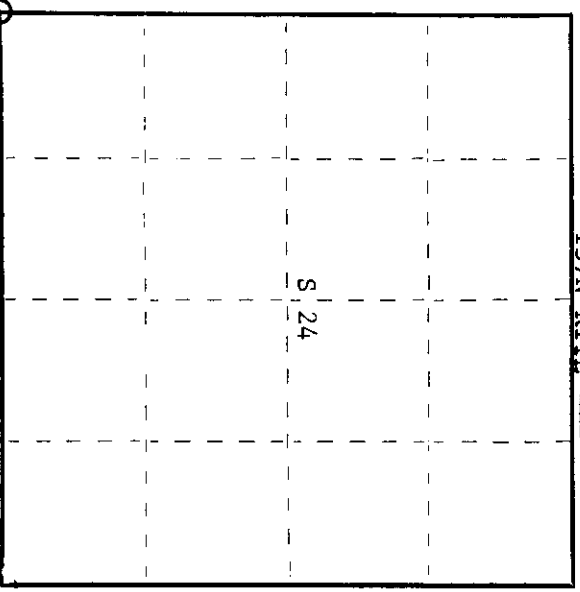

○ = Corner monument restored.

History of original corner establishment:

Original corner established by Wm. E. Dougherty, Government Deputy Surveyor, in 1859, from which birch 14" bears N60°W 15 links and sugar 18" bears S43°E 20 links. Corner - Original corner recovered by J.J. Melendy. Found post and stumps of original BT's nearly gone. He set new post from which hemlock 16" bears N11°E 25-3/4 links and birch 10" bears S67°W 98-3/4 links.

H.C. Lawrence, Registered Land Surveyor, recovered this corner in 1949 during his retracement survey. Found BT's intact but distance to birch differs by 11 links. V.M. Maine recovered corner and set 2-1/2" iron pipe.

Description of corner evidence found:

- Recovered Maine's 2-1/2" iron pipe with brass cap stamped - T37N R11E
- Recovered H.C. Lawrence's 4" cedar post, squared and scribed S26, S25, S24, S23. This had rotted off and was lying beside iron pipe. Recovered point of wooden post next to the iron pipe.
- Recovered OBT - white birch 18" S62°W 86 links scribed S26 BT, now a 12' stub.

S23 | S24  
S26 | S25

Description of monument and accessories I established to perpetuate the original location of this corner. As iron pipe was in perfect shape, it was painted blue and wooden stake was propped up beside it.

- NBT - white spruce 6" N25°W 5.8 links - scribed SC BT.
- white spruce 6" S54°W 4 links - scribed SC BT.

Dated at Rhinelander Wis. this 17th day of July 19 75.

Signature *Phillip T. Hansen* Title Registered Land Surveyor Registration No. S-498  
(County Surveyor, Registered Land Surveyor, or other duly authorized official)

Office of Register of Deeds, County of Oneida I hereby certify that the within instrument was filed in this office for record on the 1st day of October 19 75 at 3:00 o'clock P.M.

By *Doris George Fuchs* (Register of Deeds)

By Deputy