

CERTIFIED LAND CORNER RESTORATION

S 2/
Index No. S-21

State of Wisconsin

County of Oneida } ss.

I Phillip T. Hansen, do hereby certify that on the 6th day of May, 1975, I found evidence of the N-1/16 corner of Sections 25 and 26 Township 37 North, Range 11 East, Fourth Principal Meridian, as described hereon; and that from this evidence I established a new monument and accessories as described hereon to perpetuate the original location of this corner.

Resident witnesses:

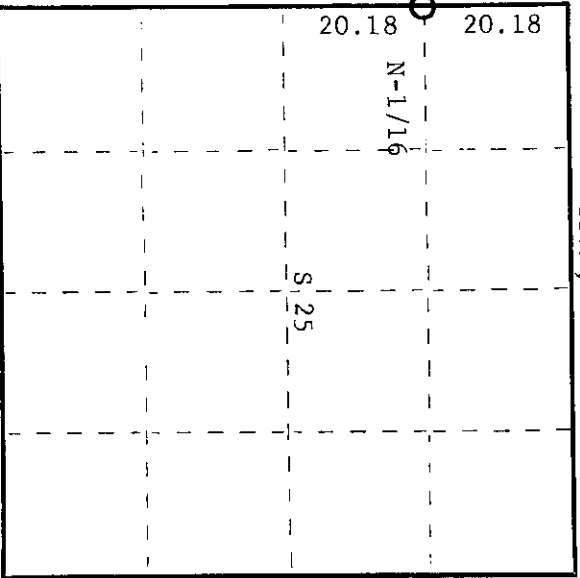
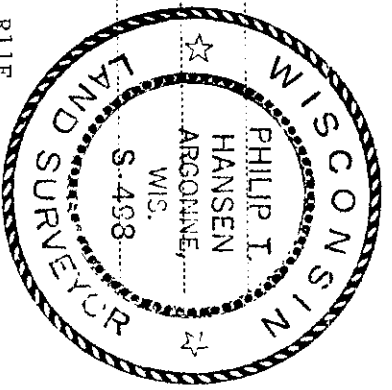

History of original corner establishment:
Original corner established by J.A. Melendy in 1916. Set BT birch S19°W 12 links. H.C. Lawrence, Registered Land Surveyor, replaced recovered old stake during his retracement survey of 1948. Placed rock carron around stake. Found an x on a 5' x 5' stone which bears S58°E 23 links.

Description of corner evidence found:
Recovered H.C. Lawrence's 5" cedar post, squared and scribed N-1/16 S25; N-1/16 S26, in fair condition. Also found a 1-1/2" O.D. iron pipe sitting beside the wood post.
Recovered BT's - Hemlock 14" S37°W 22 links scribed N-1/16 S26 BT
Yellow birch 12" N48E 22 links scribed N-1/16 S25 BT
No record of origin. X on 5' x 5' stone intact, S58°E 23 links.

Description of monument and accessories I established to perpetuate the original location of this corner.
Replaced 5" cedar post and iron pipe with 1-1/2" O.D. x 5' iron pipe with 2" brass cap stamped - S498 T37N, R11E

Set NBT - Sugar maple 8" S42°E 18.6 links scribed 1/16 BT N-1/16 S26 S25 CPI-1975

Dated at Rhineland, Wis. this 15th day of May, 1975.

Signature *Phillip T. Hansen* Title Registered Land Surveyor Registration No. S-498
(County Surveyor, Registered Land Surveyor, or other duly authorized official)

Office of Register of Deeds, County of Oneida, I hereby certify that the within instrument was filed in this office for record on the 1st day of October, 1975 at 3:00 o'clock P.M.

Donna Savage Tucker
(Register of Deeds)

By Deputy

3711263000