

CERTIFIED LAND CORNER RESTORATION

Index No. D-10

State of Wisconsin }
 County of Oneida } ss.

I, Philip T. Hansen, do hereby certify that on the 24th day of June, 1980, I ~~found~~ established the SW 1/16 corner of Section 28 Township 37 North, Range 11 East, Fourth Principal Meridian, as described hereon; and that from this evidence I established a new monument and accessories as described hereon to perpetuate the original location of this corner.

Resident witnesses
 Glen Barker
 Jim Claflin
 Herb Wagoner

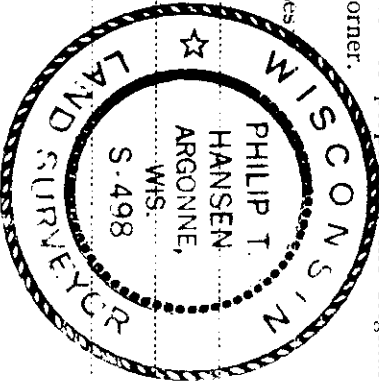

History of original corner establishment:
 No record of previous survey.

Description of corner evidence found:

No evidence of any corner recovered.
 Corner established by traverse and computation.
 Subdivided section to establish C 1/4 corner.
 Subdivided SW 1/4 to establish SW 1/16 corner.
 Computed location of SW 1/16 corner is N 0° 54' 39" E 1263.40 feet of W 1/16 between sections 28 and 33 and S 0° 54' 39" W 1263.40 feet of W.C. 1/16 section 28.

Description of monument and accessories I established to perpetuate the original location of this corner.

Set a 1-1/2" iron pipe with 2" brass cap, stamped:
 Monument projects 18" above ground.

Marked NBT - S498
 Cedar 6" S63°W 6.59 feet T37N R11E
 Cedar 10" S24°E 13.32 feet SW 1/16 S 28
 scribed 1/16 BT. CPI-1980

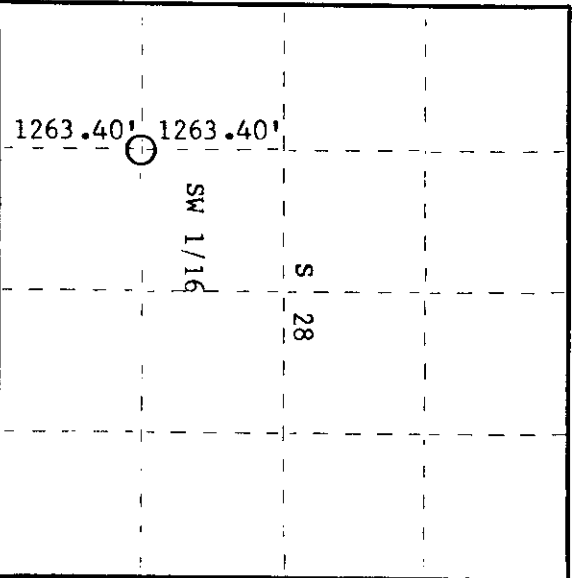

○ = Corner monument restored.

Dated at Rhinelander, Wis., this 23rd day of July, 1980.

Signature: Philip T. Hansen Title: Registered Land Surveyor Registration No. S-498
 (County Surveyor, Registered Land Surveyor, or other duly authorized official)

Office of Register of Deeds, County of Oneida, 30th day of July, 1980.
 I hereby certify that the within instrument was filed in this office for record on the 15th day of July, 1980 at 10:15 o'clock A.M.

Toni Teragac Kuhn
 (Register of Deeds)

By: _____ Deputy