

CERTIFIED LAND CORNER RESTORATION

Index No. **A-19**

State of Wisconsin }  
 County of Oneida } ss.

I Philip T. Hansen, do hereby certify that on the 20th day of December, 1974, I found evidence of the Quarter corner of S2-S35 Township 36-37, North, Range 11 East, Fourth Principal Meridian, as described hereon; and that from this evidence I established a new monument and accessories as described hereon to perpetuate the original location of this corner.

Resident witnesses:

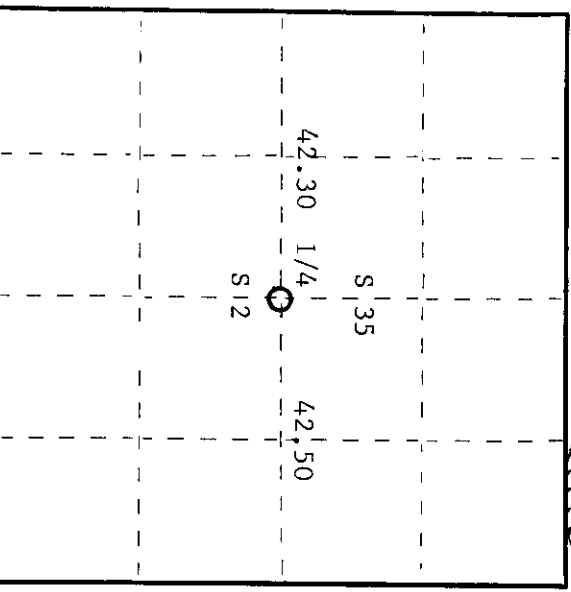
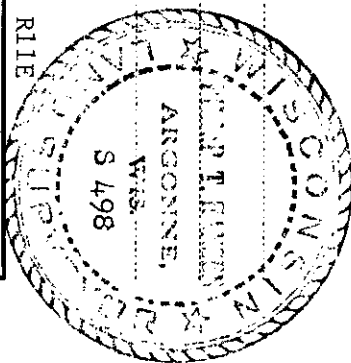

○ = Corner monument restored.

History of original corner establishment:  
 Original corner established H.C. Fellows - 1858.

Tamarack 10" N40E 13 lks.  
 Tamarack 8" S61W 17 lks.  
 H.C. Lawrence, Reg. Surveyor states that he recovered the corner in 1950 and found the stumps, original Br's, and also a yellow birch Br 6", N69W, 19 lks. made by J.J. Melendy in 1916. Set new 6" cedar post, squared and scribed beside old post.  
 No new Br's established.

Description of corner evidence found:  
 Recovered H.C. Lawrence's 6" post, squared and scribed S2 T36N; 1/4 S35 T37N, R11 in place and in fair condition.  
 No traces of old Br's were found.

Description of monument and accessories I established to perpetuate the original location of this corner.  
 Set new 2-1/2" x 5' galvanized iron pipe with brass cap stamped as follows -

- |       |               |       |         |                 |            |
|-------|---------------|-------|---------|-----------------|------------|
| NBT's | Hemlock 12"   | S64°E | 93 lks. | scribed S-2 1/4 | T37N, R11E |
|       | Black ash 11" | N60°E | 58 lks. | scribed 1/4 BT  | S498       |

S 35  
 1/4 —+—  
 S 2

T36N, R11E  
 CPT-1974

Dated at Rhineland, Wis., this 16th day of June, 1975.

Signature Philip T. Hansen Title Registered Land Surveyor Registration No. S-498  
 (County Surveyor, Registered Land Surveyor, or other duly authorized official)

Office of Register of Deeds, County of Oneida. 1st day of October, 1975 hereby certify that the within instrument was filed in this office for record on the 30th day of October, 1975 at 3:00 o'clock P. M.

Doris Berge Kuehn  
 (Register of Deeds)

By: \_\_\_\_\_ Deputy

2711350020